

ALL WEATHER WIND ROSE
 SOURCE: NATIONAL WEATHER RECORDS
 CENTER: ASHEVILLE, N.C.
 STATION: BARNWELL REGIONAL AIRPORT
 PERIOD: 2007-2012

CROSSWIND COVERAGE		
KNOTS	RWY 05-23	RWY 17-35
10.5	97.20%	93.43%
16	99.88%	99.58%

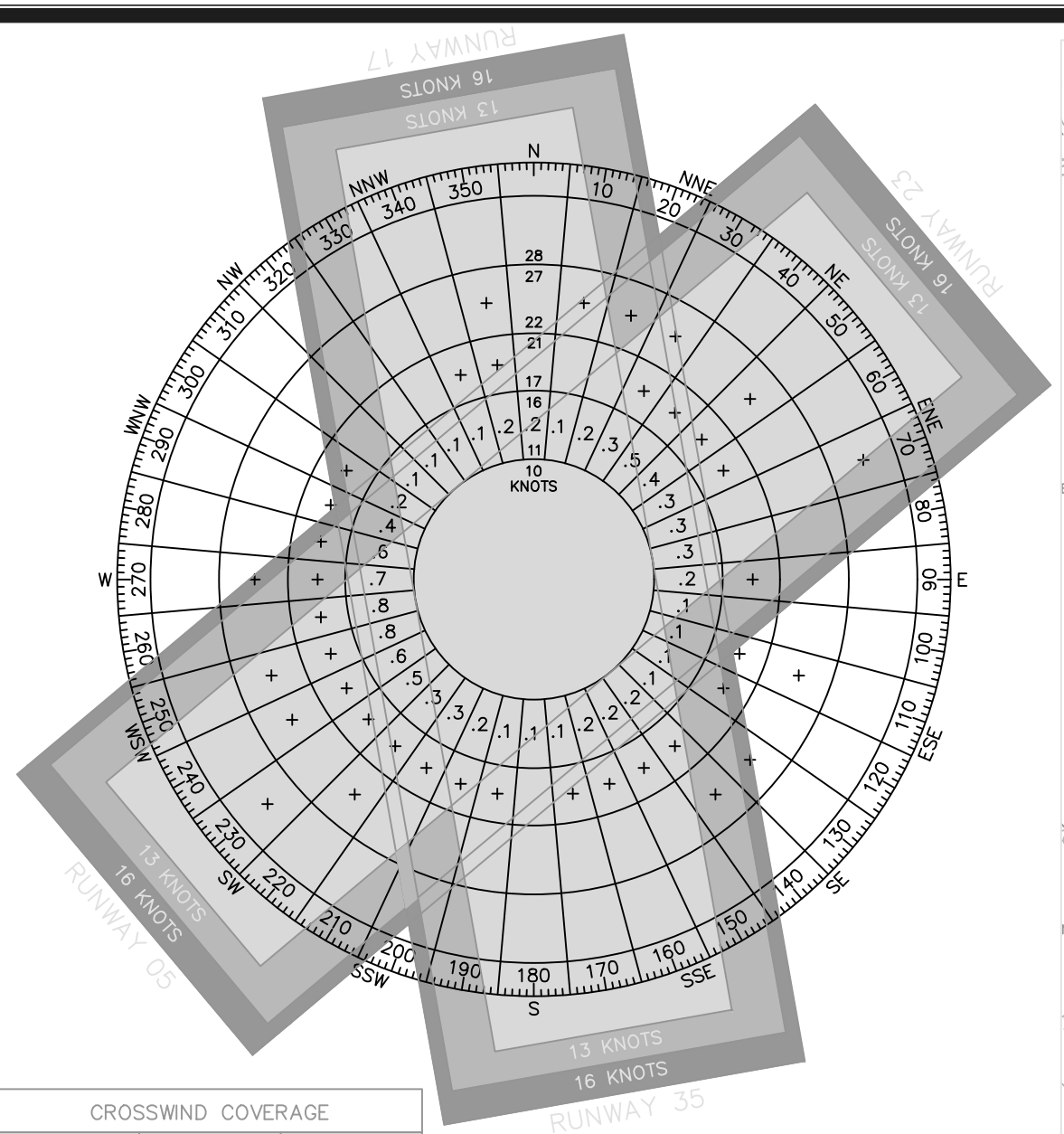

IFR WIND ROSE
 SOURCE: NATIONAL WEATHER RECORDS
 CENTER: ASHEVILLE, N.C.
 STATION: BARNWELL REGIONAL AIRPORT
 PERIOD: 2007-2012

CROSSWIND COVERAGE		
KNOTS	RWY 05-23	RWY 17-35
10.5	97.20%	93.43%
16	99.88%	99.58%

LEGEND		
ITEM	EXISTING	ULTIMATE
GROUND CONTOURS	~660	
WOODED AREA		
ROADS (PAVED)		
AIRPORT BUILDINGS / STRUCTURES		
AIRPORT PAVED AREAS		
AIRPORT PROPERTY LINE (PL)	PL	
RUNWAY OBJECT FREE AREA		
RUNWAY OBJECT FREE AREA/OBSTACLE FREE ZONE		
RUNWAY OBSTACLE FREE ZONE		
RUNWAY SAFETY AREA/OBSTACLE FREE ZONE		
RUNWAY SAFETY AREA		
TAXIWAY OBJECT FREE AREA	TOFA	
FENCE	X X X	X X X
PAVEMENT OVERLAY		
CLEARING AND GRUBBING		
RUNWAY VISIBILITY ZONE		
APPROACH SURFACE		
PART 77 APPROACH SURFACE		
GLIDE PATH QUALIFICATION SURFACE (GQS)		

DEVELOPMENT STAGES	
PHASE I	2015-2020
PHASE II	2021-2025
PHASE III	2026-2030



FAA DISCLAIMER
 THE CONTENTS DO NOT NECESSARILY REFLECT THE OFFICIAL VIEWS OR POLICIES OF THE FAA. THE ACCEPTANCE OF THIS PLAN BY THE FAA DOES NOT IN ANY WAY CONSTITUTE A COMMITMENT ON THE PART OF THE UNITED STATES TO PARTICIPATE IN ANY DEVELOPMENT IDENTIFIED HEREIN NOR DOES IT INDICATE THAT THE PROPOSED DEVELOPMENT IS ENVIRONMENTALLY ACCEPTABLE IN ACCORDANCE WITH APPROPRIATE PUBLIC LAWS.

APPROACH VISIBILITY MINIMUMS		
RNAV (GPS) RWY	EXISTING	PROPOSED
RNAV (GPS) RWY 17	476' - 3/4 MILE	NO CHANGE
RNAV (GPS) RWY 35	860' - 1 MILE	NO CHANGE

RUNWAY PROTECTION ZONE (RPZ)					
RUNWAY	INNER WIDTH (W ₁)	LENGTH (L)	OUTER WIDTH (W ₂)	RPZ ACRES	INTEREST
17	1,000'	1,700'	1,510'	48,978	FEE
35	500'	1,000'	700'	13,774	FEE
05	250'	1,000'	450'	8,035	FEE
23	250'	1,000'	450'	8,035	FEE

AIRPORT FACILITIES INDEX		
NO.	FACILITY	TOP ELEV.
1	TERMINAL BUILDING	243.9
2	COMMUNITY HANGAR	249.6
3	OPEN AIR HANGAR	248.7
4	SOUTH T-HANGARS	245.7
5	SOUTH T-HANGARS	244.5
6	STORAGE BUILDING	240.6
7	NORTH T-HANGARS	247.8
8	STORAGE HANGAR	248.1
9	PROPOSED T-HANGARS	-
10	PROPOSED CORPORATE HANGAR	-
11	PROPOSED CORPORATE HANGAR	-
12	PROPOSED CORPORATE HANGAR	-
13	PROPOSED CORPORATE HANGAR	-
14	PROPOSED CORPORATE HANGAR	-

AIRPORT DATA TABLE			
ITEM	EXISTING	PROPOSED	
FAA ASSET CLASSIFICATION	LOCAL	LOCAL	
STATE AIRPORT CLASSIFICATION	SC-III	SC-III	
AIRPORT ELEVATION (MSL)	246.0'	246.0'	
AIRPORT REFERENCE POINT (ARP) COORDINATES (NAD 83)	LAT. N 33° 15' 27.16" LONG. W 81° 23' 18.33"	LAT. N 33° 15' 27.16" LONG. W 81° 23' 18.33"	
AIRPORT MAGNETIC VARIATION	6° 52' 12" WEST (2014)	6° 52' 12" WEST (2014)	
MEAN MAXIMUM DAILY TEMPERATURE	88° F	88° F	
AIRPORT AND TERMINAL NAVAIDS	RWY 17/35-GPS	RWY 17/35-GPS	
RUNWAY DESIGN CODE (RDC)	RWY 05-23 RWY 17-35 RWY 05-23 RWY 17-35	RWY 05-23 RWY 17-35 RWY 05-23 RWY 17-35	
AIRPORT CRITICAL AIRCRAFT	CESNA 310 CITATION 510	CESNA 310 CITATION 510	
NPIAS SERVICE LEVEL	G.A.	G.A.	
RUNWAY LIGHTING	NONE	MIRL	
RUNWAY MARKING	BSC	NPI	
TAXIWAY LIGHTING	NONE	MIL	

RUNWAY DATA TABLE					
ITEM	RUNWAY 05-23 (UTILITY)		RUNWAY 17-35		
	EXISTING	PROPOSED	EXISTING	PROPOSED	
RUNWAY DIMENSIONS	4,526' X 70'	4,526' X 70'	5,119' X 100'	5,119' X 100'	
RUNWAY END COORDINATES	05 LAT. N 33° 15' 52.24" LONG. W 81° 23' 02.24"	05 LAT. N 33° 15' 52.24" LONG. W 81° 23' 02.24"	17 LAT. N 33° 15' 52.24" LONG. W 81° 23' 13.82"	17 LAT. N 33° 15' 52.24" LONG. W 81° 23' 13.82"	
RUNWAY END ELEVATION	242.0'	242.0'	245.1'	245.1'	
RUNWAY HIGH POINT	242.0' MSL	242.0' MSL	246.7' MSL	246.9' MSL	
RUNWAY LOW POINT	240.0' MSL	240.0' MSL	236.6' MSL	236.6' MSL	
TOUCHDOWN ZONE ELEVATION (TDZE)	242.0' MSL	242.0' MSL	246.7' MSL	246.9' MSL	
RSA DIMENSIONS	5,006' X 120'	5,006' X 120'	5,718' X 150'	5,718' X 150'	
ROFA DIMENSIONS	5,006' X 250'	5,006' X 250'	5,718' X 500'	5,718' X 500'	
ROFZ DIMENSIONS	4,926' X 250'	4,926' X 250'	5,518' X 400'	5,518' X 400'	
INNER APPROACH OFZ DIMENSIONS	N/A	N/A	RW 17-1,500' X 400'	RW 17-1,500' X 400'	
PRECISION OFZ DIMENSIONS	N/A	N/A	N/A	N/A	
FAA PART 77 CATEGORY	RWY 05 - A (V)	RWY 05 - A (V)	RWY 17 - C	RWY 17 - C	
PART 77 APPROACH SLOPES	20:1	20:1	34:1	34:1	
RUNWAY BLAST PAD	NONE	NONE	NONE	NONE	
EFFECTIVE GRADIENT (%)	0.040%	0.040%	0.170%	0.170%	
ALL WEATHER PERCENT WIND COVERAGE, (16 KNOTS)	99.88%	99.88%	99.58%	99.58%	
IFR PERCENT WIND COVERAGE, (16 KNOTS)	99.88%	99.88%	99.58%	99.58%	
INSTRUMENT RUNWAYS	N/A	N/A	17-RNAV, 35-RNAV	17-RNAV, 35-RNAV	
PAVEMENT TYPE	ASPHALT	ASPHALT	ASPHALT	ASPHALT	
PAVEMENT CLASSIFICATION NUMBER (PCN)	N/A	N/A	26/F/B/X/I	26/F/B/X/I	
PAVEMENT STRENGTH/GEAR CONFIGURATION	12,000 lbs SW	12,000 lbs SW	89,000 lbs SW	89,000 lbs SW	
APPROACH SURFACES (INNER WIDTH X LENGTH X OUTER WIDTH)	350' X 3,000' X 700'	350' X 3,000' X 700'	350' X 3,000' X 700'	350' X 3,000' X 700'	
RUNWAY LIGHTING	N/A	N/A	RWY 17/35 - MIRL	RWY 17/35 - MIRL	
RUNWAY MARKING	05-BSC, 23-BSC	05-BSC, 23-BSC	17-NPI, 35-NPI	17-NPI, 35-NPI	
ELECTRONIC & VISUAL APPROACH AIDS	05 N/A	N/A	17 PAPI-2, ODALS	PAPI-2, ODALS	

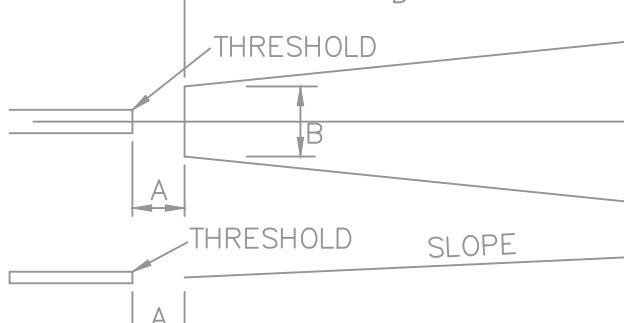
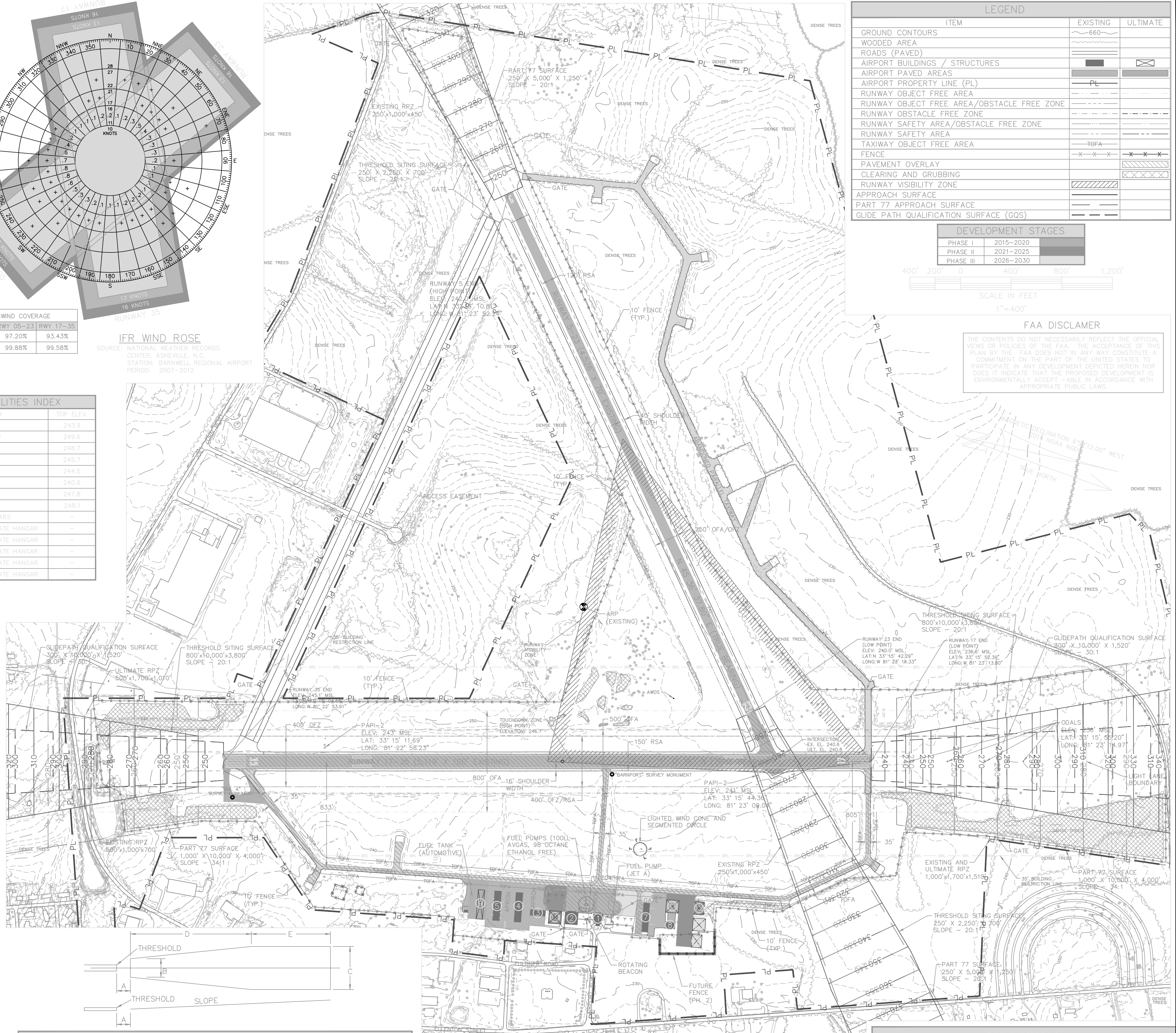

THRESHOLD SITING REQUIREMENTS						
R/W	A	B	C	D	E	SLOPE
17	0'	800'	3,800'	10,000'	0'	20:1
35	0'	800'	3,800'	10,000'	0'	20:1
5	0'	250'	700'	2,250'	2,750'	20:1
23	0'	250'	700'	2,250'	2,750'	20:1

DEPARTURE SURFACE REQUIREMENTS						
R/W	A	B	C	D	E	SLOPE
17	0'	1,000'	6,466'	10,200'	0'	40:1
35	0'	1,000'	6,466'	10,200'	0'	40:1

NO.	MODIFICATION	WAIVER	DATE
1			
2			
3			

BARNWELL REGIONAL AIRPORT COMMISSION			
DATE	SIGNATURE	TITLE	
FEDERAL AVIATION ADMINISTRATION			
DATE	SIGNATURE	TITLE	

ALBERT, BRIGHT & ELLINGTON
 ENGINEERING & PLANNING CONSULTANTS
 2000 PARK STREET, SUITE 101
 COLUMBIA, SOUTH CAROLINA 29201
 PHONE: 803-933-9290 FAX: 803-933-9205
 www.albertandbright.com

AIRPORT LAYOUT PLAN
AIRPORT LAYOUT PLAN UPDATE
BARNWELL REGIONAL AIRPORT

PLANNING DOCUMENT
 NOT RELEASED FOR CONSTRUCTION

REV. NO.	DESCRIPTION	DATE
1		
2		
3		

Designed: JEL
 Date: DEC. 2015
 Scale: AS SHOWN
 Drawn: MWP
 Checked: PET
 Project No.: 2107-1301
 Sheet No.: 3 OF 14