

ALL WEATHER WIND ROSE

SOURCE: NATIONAL CLIMATIC DATA CENTER
STATION: MYRTLE BEACH, SOUTH CAROLINA
PERIOD: 1992 - 2001

WIND COVERAGE	
CROSSWIND COMPONENT	
10.5 KNT	13 KNT
94.9%	97.8%

NOTES

ULTIMATE AIRPORT REFERENCE POINT - BEGINNING AT THE SOUTH END OF THE NORTH-SOUTH RUNWAY 18-36, THENCE ALONG THE CENTERLINE 352.3456' (TRUE) 2200' TO THE ARP COORDINATES: LATITUDE NORTH 33°27'12.967" LONGITUDE WEST 79°31'35.391"
COORDINATES WERE COMPUTED FROM GROUND CONTROL SURVEYS SEPTEMBER 18, 2000 BY CLIFFORD C. BYRD LAND SURVEYING, WILMINGTON, N.C.

COORDINATES ARE BASED ON NAD83 DATUM. ELEVATIONS ARE BASED ON NAVD88 DATUM, MEAN SEA LEVEL (MSL)

DIGITAL BASE MAPPING WAS PROVIDED BY THE DIVISION OF AERONAUTICS, SOUTH CAROLINA DEPARTMENT OF COMMERCE, FROM AERIAL SURVEY OCTOBER 2, 1997 BY AERO-DYNAMICS, CORPORATION, CHARLOTTE, N.C.

WHERE SHOWN LIMITS OF AVIATION EASEMENT IS APPROXIMATE. ACTUAL LIMITS TO BE DETERMINED BY FUTURE OBSTRUCTION ANALYSIS SURVEY.

BUILDING RESTRICTION LINE IS ALTERED FROM 500' EACH SIDE OF RUNWAY CENTERLINE TO 65.5' FROM FUTURE TAXIWAY CENTERLINE TO ALLOW AIRPORT BUILDINGS IN ACCORDANCE WITH FAA AIRPORT DESIGN STANDARDS ADVISORY CIRCULAR AC: 150/5300-13

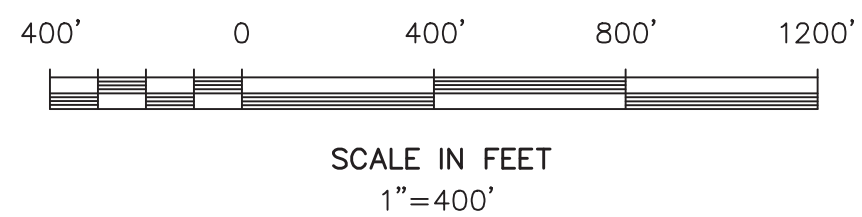
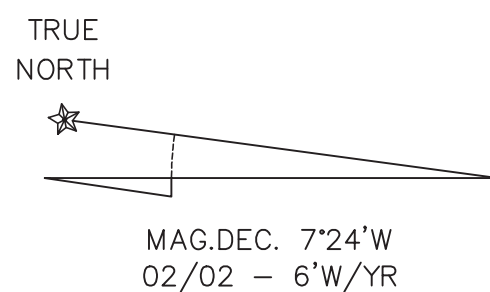

LOCATION MAP

RUNWAY AND MONUMENT DATA					
ITEM	LATITUDE (N)	LONGITUDE (W)	NORTHING	EASTING	ELEVATION
A ANDPORT	33°-27'-18.21006"	79°-31'-36.77258"	593240.03000	2449227.98000	17.87
B ANDPORT AZ	33°-27'-01.16455"	79°-31'-34.17769"	591520.73000	2449472.34000	24.07

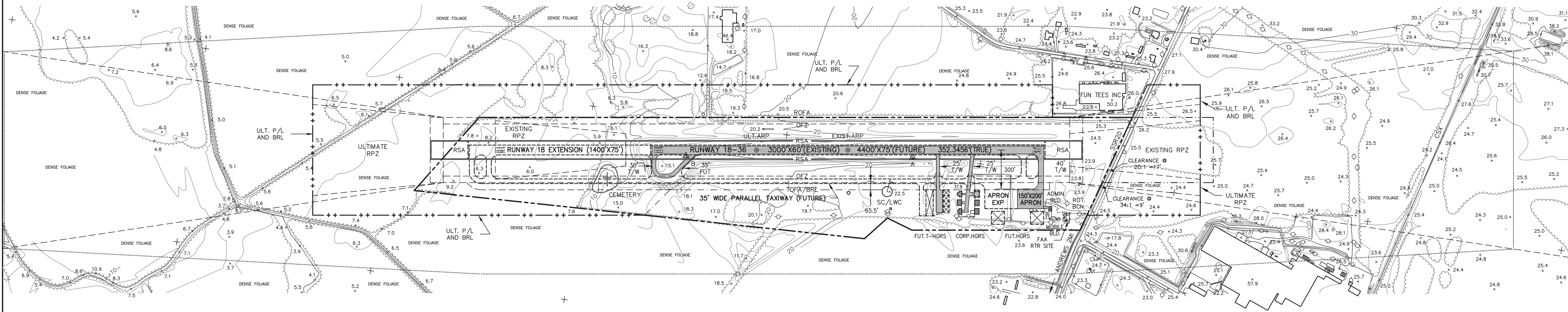

AIRPORT DESIGN STANDARDS DIMENSIONAL DATA			
AIRPORT REFERENCE CODE (ARC) ITEM	EXIST. REQ.	MEETS REQ.	ULT. REQ.
RUNWAY SAFETY AREA (RSA) WIDTH	150'	YES	SAME
RSA BEYOND R/W 18 END	300'	NO/100' (1)	SAME
RSA BEYOND R/W 36 END	300'	NO/100' (1)	SAME
RUNWAY OBSTACLE FREE ZONE (OFZ) WIDTH	250'	YES	400'
OFZ BEYOND R/W END	200'	YES	SAME
RUNWAY OBJECT FREE AREA (ROFA) WIDTH	500'	YES	SAME
ROFA BEYOND R/W END	300'	YES	SAME
RUNWAY PARALLEL TAXIWAY SEPARATION	240'	SAME	SAME
TAXIWAY OBJECT FREE AREA (TOFA) WIDTH	131'	YES	SAME
TAXIWAY OBJECT FREE AREA	115'	YES	SAME
MINIMUM AIRCRAFT PARKING DIST FROM R/W	250'	YES	SAME

(1) SAFETY AREAS TO BE EXTENDED

RUNWAY DATA			
ITEM	EXISTING	ULTIMATE	
RUNWAY 18 END			
LATITUDE NORTH	33°27'20.816"	33°27'34.538"	
LONGITUDE WEST	79°31'36.650"	79°31'38.850"	
RUNWAY 18 END ELEVATION	17.44	10.44	
RUNWAY 36 END			
LATITUDE NORTH	33°26'51.396"	SAME	
LONGITUDE WEST	79°31'31.933"	SAME	
RUNWAY 36 END ELEVATION	26.38	SAME	
LENGTH X WIDTH	3000'x60'	4400'x75'	
EFFECTIVE GRADIENT	0.30%	0.36%	
PAVEMENT SURFACE	ASPHALT	SAME	
PAVEMENT STRENGTH (THOUSANDS OF POUNDS)	11SW 22WD	30S	
MARKING	BASIC	NPI	
NAVAIDS	NONE	GPS 18/36	
LIGHTING / APPROACH AIDS	MIRL	SAME	
	VASI 36	PAPI 18/36	
		REIL 18/36	

AIRPORT DATA			
ITEM	EXISTING	ULTIMATE	
AIRPORT REFERENCE POINT	LATITUDE NORTH 33°27'06.106"	LONGITUDE WEST 79°31'34.292"	79°31'35.391"
ARP COORDINATES (NAD83)			
ESTABLISHED AIRPORT ELEVATION (MEAN SEA LEVEL)	26.38	SAME	
NORMAL MAXIMUM TEMPERATURE - HOTTEST MONTH	90.2"	SAME	
AIRPORT REFERENCE CODE (ARC)	B II	SAME	
AIRPORT AND TERMINAL NAVAIDS	ROT.BEACON	SAME	
(1) SEGMENTED CIRCLE & LIGHTED WIND CONE	(1) SC/LWC	SAME	
		NDB	
TAXIWAY LIGHTING / SIGNAGE		MITL	SAME

RUNWAY APPROACH AND RPZ DATA		
RUNWAY	EXISTING	ULTIMATE
18	VISUAL APPROACH SURFACE VISIBILITY MINIMUMS NOT PUBLISHED 250' X 5000' X 1250' 5000' @ 20:1 REQUIRED RUNWAY PROTECTION ZONE (RPZ) 250' X 1000' X 450'	NONPRECISION APPROACH SURFACE VISIBILITY MINIMUMS NOT LESS THAN 1 MILE 500' X 10000' X 3500' 10000' @ 34:1 REQUIRED RUNWAY PROTECTION ZONE (RPZ) 500' X 1000' X 700'
36	VISUAL APPROACH SURFACE VISIBILITY MINIMUMS NOT PUBLISHED 250' X 5000' X 1250' 5000' @ 20:1 REQUIRED RUNWAY PROTECTION ZONE (RPZ) 250' X 1000' X 450'	NONPRECISION APPROACH SURFACE VISIBILITY MINIMUMS NOT LESS THAN 1 MILE 500' X 10000' X 3500' 10000' @ 34:1 REQUIRED RUNWAY PROTECTION ZONE (RPZ) 500' X 1000' X 700'

LEGEND		
ITEM	EXISTING	ULTIMATE
WOODED AREAS		
SPOT ELEVATION	x 23.8	
GROUND CONTOURS	20	
ROADS (UNPAVED)		
BUILDINGS / STRUCTURES		
ROADS (PAVED)		
AIRPORT BUILDINGS / STRUCTURES		
AIRPORT PAVED AREAS		
AIRPORT PROPERTY LINE (P/L)		
AVIATION EASEMENT		
BUILDING RESTRICTION LINE (BRL)		

TALBERT & BRIGHT
ENGINEERING & PLANNING CONSULTANTS
WILMINGTON, NC 28405
4810 SHELLEY DRIVE
PHONE: 910-763-5350
FAX: 910-762-6281
EMAIL: TBILL@TBILL.COM

REV. NO.	DESCRIPTION	DATE
1	REVISE ULT R/W 18 END, ULT. ARP, COORDINATES, R/W BEARING	2/3/21
2	FEED. AIP. 07 PROJECT. HANGAR, TAXIWAY	8/1/14

ANDREWS MUNICIPAL AIRPORT - PHH
ANDREWS, SOUTH CAROLINA
AIRPORT LAYOUT DRAWING

Approved By _____
Title _____
Date _____
GEORGETOWN COUNTY
Date FEBRUARY 2002
Scale 1"=400'
Drawn LSM
Checked JTT
Project No. 2601-0002
Sheet No. **1**
of ONE