

ALL WEATHER WIND ROSE

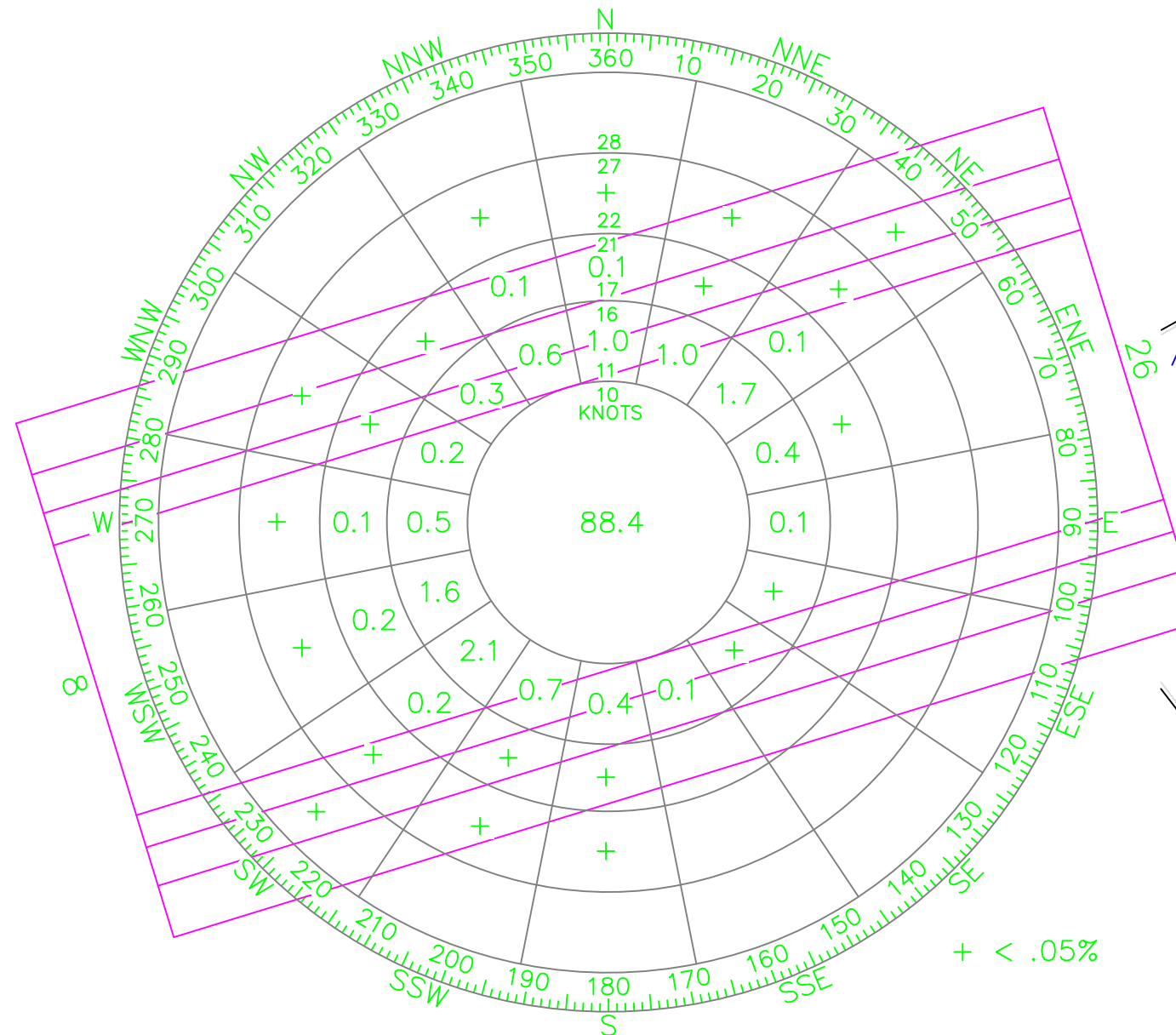

WIND COVERAGE  
 RUNWAY 8/26  
 10.5 KNOTS 13 KNOTS 16 KNOTS 20 KNOTS  
 96.6% 98.3% 99.6% 99.9%

82434 OBSERVATIONS MADE  
 OVER THE PERIOD 1962 - 1990  
 STATION 723120  
 GREENVILLE-SPARTANBURG AIRPORT, SC, US  
 SOURCE: NATIONAL CLIMATIC DATA CENTER, ASHEVILLE, NC

CONSTRUCTION NOTICE REQUIREMENT

To protect operational safety and future development, all proposed construction on the airport must be coordinated by the airport owner with the FAA's Airports District Office prior to construction. FAA's review takes approximately 60 days.

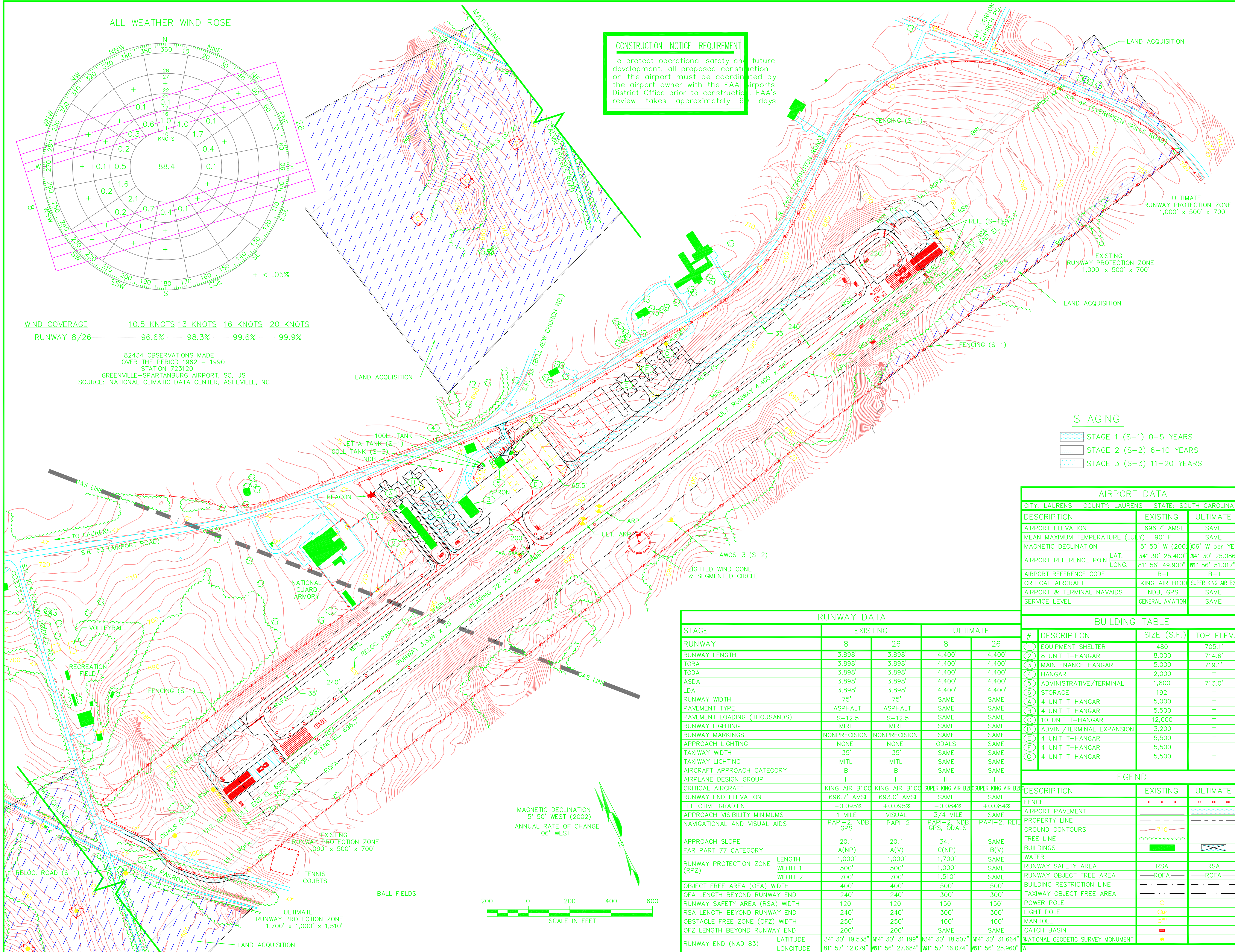

STAGING

- STAGE 1 (S-1) 0-5 YEARS
- STAGE 2 (S-2) 6-10 YEARS
- STAGE 3 (S-3) 11-20 YEARS

AIRPORT DATA

CITY: LAURENS	COUNTY: LAURENS	STATE: SOUTH CAROLINA
DESCRIPTION	EXISTING	ULTIMATE
AIRPORT ELEVATION	696.7' AMSL	SAME
MEAN MAXIMUM TEMPERATURE (JULY)	90° F	SAME
MAGNETIC DECLINATION	5° 50' W (2002)	06" W per YEAR
AIRPORT REFERENCE POINT	LAT. 34° 30' 25.400" N LONG. 81° 56' 49.900" W	LAT. 34° 30' 25.086" N LONG. 81° 56' 51.017" W
AIRPORT REFERENCE CODE	B-I	B-II
CRITICAL AIRCRAFT	KING AIR B100	SUPER KING AIR B20
AIRPORT & TERMINAL NAVAIDS	NDB, GPS	SAME
SERVICE LEVEL	GENERAL AVIATION	SAME

RUNWAY DATA

STAGE	EXISTING		ULTIMATE	
	8	26	8	26
RUNWAY LENGTH	3,898'	3,898'	4,400'	4,400'
TORA	3,898'	3,898'	4,400'	4,400'
TODA	3,898'	3,898'	4,400'	4,400'
ASDA	3,898'	3,898'	4,400'	4,400'
LDA	3,898'	3,898'	4,400'	4,400'
RUNWAY WIDTH	75'	75'	SAME	SAME
PAVEMENT TYPE	ASPHALT	ASPHALT	SAME	SAME
PAVEMENT LOADING (THOUSANDS)	S-12.5	S-12.5	SAME	SAME
RUNWAY LIGHTING	MIRL	MIRL	SAME	SAME
RUNWAY MARKINGS	NONPRECISION	NONPRECISION	SAME	SAME
APPROACH LIGHTING	NONE	NONE	ODALS	SAME
TAXIWAY WIDTH	35'	35'	SAME	SAME
TAXIWAY LIGHTING	MITL	MITL	SAME	SAME
AIRCRAFT APPROACH CATEGORY	B	B	SAME	SAME
AIRPLANE DESIGN GROUP	I	I	II	II
CRITICAL AIRCRAFT	KING AIR B100	KING AIR B100	SUPER KING AIR B20	SUPER KING AIR B20
RUNWAY END ELEVATION	696.7' AMSL	693.0' AMSL	SAME	SAME
EFFECTIVE GRADIENT	-0.095%	+0.095%	-0.084%	+0.084%
APPROACH VISIBILITY MINIMUMS	1 MILE	VISUAL	3/4 MILE	SAME
NAVIGATIONAL AND VISUAL AIDS	PAPI-2, NDB, GPS	PAPI-2	PAPI-2, NDB, GPS, ODALS	PAPI-2, REIL
APPROACH SLOPE	20:1	20:1	34:1	SAME
FAR PART 77 CATEGORY	A(NP)	A(V)	C(NP)	B(V)
RUNWAY PROTECTION ZONE (RPZ)	LENGTH 1,000' WIDTH 1 500' WIDTH 2 700'	1,000' 500' 700'	1,700' 1,000' 1,510'	SAME
OBJECT FREE AREA (OFA) WIDTH	400'	400'	500'	500'
OFA LENGTH BEYOND RUNWAY END	240'	240'	300'	300'
RUNWAY SAFETY AREA (RSA) WIDTH	120'	120'	150'	150'
RSA LENGTH BEYOND RUNWAY END	240'	240'	300'	300'
OBSTACLE FREE ZONE (OFZ) WIDTH	250'	250'	400'	400'
OFZ LENGTH BEYOND RUNWAY END	200'	200'	SAME	SAME
RUNWAY END (NAD 83)	LATITUDE 34° 30' 19.538" N LONGITUDE 81° 57' 12.079" W	LATITUDE 34° 30' 31.199" N LONGITUDE 81° 56' 27.684" W	LATITUDE 34° 30' 18.507" N LONGITUDE 81° 57' 16.074" W	LATITUDE 34° 30' 31.664" N LONGITUDE 81° 56' 25.960" W

BUILDING TABLE

#	DESCRIPTION	SIZE (S.F.)	TOP ELEV.
1	EQUIPMENT SHELTER	480	705.1'
2	8 UNIT T-HANGAR	8,000	714.6'
3	MAINTENANCE HANGAR	5,000	719.1'
4	HANGAR	2,000	-
5	ADMINISTRATIVE/TERMINAL	1,800	713.0'
6	STORAGE	192	-
A	4 UNIT T-HANGAR	5,000	-
B	4 UNIT T-HANGAR	5,500	-
C	10 UNIT T-HANGAR	12,000	-
D	ADMIN./TERMINAL EXPANSION	3,200	-
E	4 UNIT T-HANGAR	5,500	-
F	4 UNIT T-HANGAR	5,500	-
G	4 UNIT T-HANGAR	5,500	-

LEGEND

DESCRIPTION	EXISTING	ULTIMATE
FENCE	[Symbol]	[Symbol]
AIRPORT PAVEMENT	[Symbol]	[Symbol]
PROPERTY LINE	[Symbol]	[Symbol]
GROUND CONTOURS	[Symbol]	[Symbol]
TREE LINE	[Symbol]	[Symbol]
BUILDINGS	[Symbol]	[Symbol]
WATER	[Symbol]	[Symbol]
RUNWAY SAFETY AREA	[Symbol]	[Symbol]
RUNWAY OBJECT FREE AREA	[Symbol]	[Symbol]
BUILDING RESTRICTION LINE	[Symbol]	[Symbol]
TAXIWAY OBJECT FREE AREA	[Symbol]	[Symbol]
POWER POLE	[Symbol]	[Symbol]
LIGHT POLE	[Symbol]	[Symbol]
MANHOLE	[Symbol]	[Symbol]
CATCH BASIN	[Symbol]	[Symbol]
NATIONAL GEODETIC SURVEY MONUMENT	[Symbol]	[Symbol]

**LAURENS COUNTY**  
 LAURENS COUNTY AIRPORT  
 LAURENS, SOUTH CAROLINA

THE LPA GROUP  
 TRANSPORTATION CONSULTANTS

ATLANTA, GA ? BATON ROUGE, LA ? CHARLESTON, SC  
 CHARLOTTE, NC ? CHICAGO, IL ? COLUMBIA, SC  
 GREENSBORO, NC ? JACKSONVILLE, FL ? KNOXVILLE, TN  
 MOBILE, AL ? ORLANDO, FL ? RALEIGH, NC ? RICHMOND, VA  
 SARASOTA, FL ? TALLAHASSEE, FL ? TAMPA, FL ? WEST PALM BEACH, FL

Designer:	TGM
Technician:	TGM
Checked by:	RKH
Project Number:	CP434001

2005

- NOTES
- COORDINATES SHOWN HEREON ARE IN NAD83.
  - ELEVATIONS SHOWN ARE ABOVE MEAN SEA LEVEL (AMSL).
  - SEE EXHIBIT "A" PROPERTY MAP (DRAWING 7) FOR PROPERTY LINE METES AND BOUNDS.
  - HOLDING POSITION MARKINGS FOR RUNWAY/TAXIWAY INTERSECTIONS ARE 200' FROM RUNWAY CENTERLINE AND PERPENDICULAR TO TAXIWAY CENTERLINE.
  - NO EXISTING THRESHOLD SITING SURFACE OBJECT PENETRATIONS.
  - NO OBJECT FREE ZONE OBJECT PENETRATIONS.

REVISIONS

No.	Description	Date	By

Project Name:  
 AIRPORT LAYOUT PLAN UPDATE

Drawing Name:  
 AIRPORT LAYOUT PLAN

FAA A.I.P. Project Number:  
 Autocad Drawing Reference:  
 Date: JANUARY 2005 Division: PLANNING  
 Scale: 1" = 200' Drawing Number: 2

