



ORANGEBURG MUNICIPAL AIRPORT Orangeburg, South Carolina



THE LPA GROUP AVIATION CONSULTANTS A UNIT OF MICHAEL BAKER CORPORATION

Designer: TGM Checked by: TF Technican: TGM Project Number: 121446

- NOTES: 1. EXISTING HOLDLINE MARKINGS FOR RUNWAY 5-23 TAXIWAY A INTERSECTIONS ARE 150' FROM RUNWAY CENTERLINE AND PERPENDICULAR TO TAXIWAY CENTERLINE. ULTIMATE HOLDLINE MARKINGS FOR RUNWAY 5-23 TAXIWAY INTERSECTIONS ARE 125' FROM RUNWAY CENTERLINE AND PERPENDICULAR TO TAXIWAY CENTERLINE. EXISTING/ULTIMATE HOLDLINE MARKINGS FOR RUNWAY 17-35 TAXIWAY B INTERSECTIONS ARE 250' FROM RUNWAY CENTERLINE AND PERPENDICULAR TO TAXIWAY CENTERLINE. 2. COORDINATES SHOWN ARE IN NAD83. 3. ELEVATIONS SHOWN ARE IN NAVD88 AND ARE ABOVE MEAN SEA LEVEL (AMSL). 4. SEE AIRPORT PROPERTY MAP (DRAWING 12) FOR PROPERTY LINE METES AND BOUNDS. 5. NO OFZ OBJECT PENETRATIONS. 6. SEE INNER PORTION OF THE APPROACH SURFACE DRAWINGS FOR THRESHOLD SITING SURFACE OBJECT PENETRATIONS. 7. BUILDING RESTRICTION LINES (BRL) ARE BASED ON THE FOLLOWING: BRL LINES PARALLEL TO RUNWAY 5-23 ARE BASED ON A TRANSITIONAL SURFACE ELEVATION OF 20' OR MOST DEMANDING DESIGN STANDARD. BRL LINES PARALLEL TO RUNWAY 17-35 ARE BASED ON A TRANSITIONAL SURFACE ELEVATION OF 35' OR MOST DEMANDING DESIGN STANDARD. 8. THE ILLUSTRATED RUNWAY EXTENSION INCLUDES FULL RSA CONSTRUCTION AND REMOVAL OF THE MATERIAL PROCESSING FACILITY. PRIOR TO ANY EXTENSION OF RUNWAY 17-35, AN ENVIRONMENTAL ASSESSMENT (EA) AND BENEFIT-COST ANALYSIS (BCA) SHOULD BE PREPARED TO EVALUATE A WIDE RANGE OF EXTENSION ALTERNATIVES THAT CONSIDER ENVIRONMENTAL IMPACTS AND ECONOMIC/COST FACTORS. THE EA AND BCA MAY IDENTIFY A DIFFERENT COURSE OF ACTION THAN WHAT IS SHOWN ON THIS ALP.

LEGEND table with columns: DESCRIPTION, EXISTING, ULTIMATE. Rows include PROPERTY LINE, EASEMENT, BUILDINGS (ON-AIRPORT), BUILDINGS (OFF-AIRPORT), PAVEMENT, PAVEMENT REMOVAL, DIRT ROADS / TRAILS, RUNWAY MARKINGS, RSA, ROFA, RVZ, OFZ, BRL, NAVAIDS / LIGHTING, REILS, FENCE, NAVIAD CRITICAL AREA, TREES / BRUSH, GROUND CONTOURS, CREEKS / DITCHES.

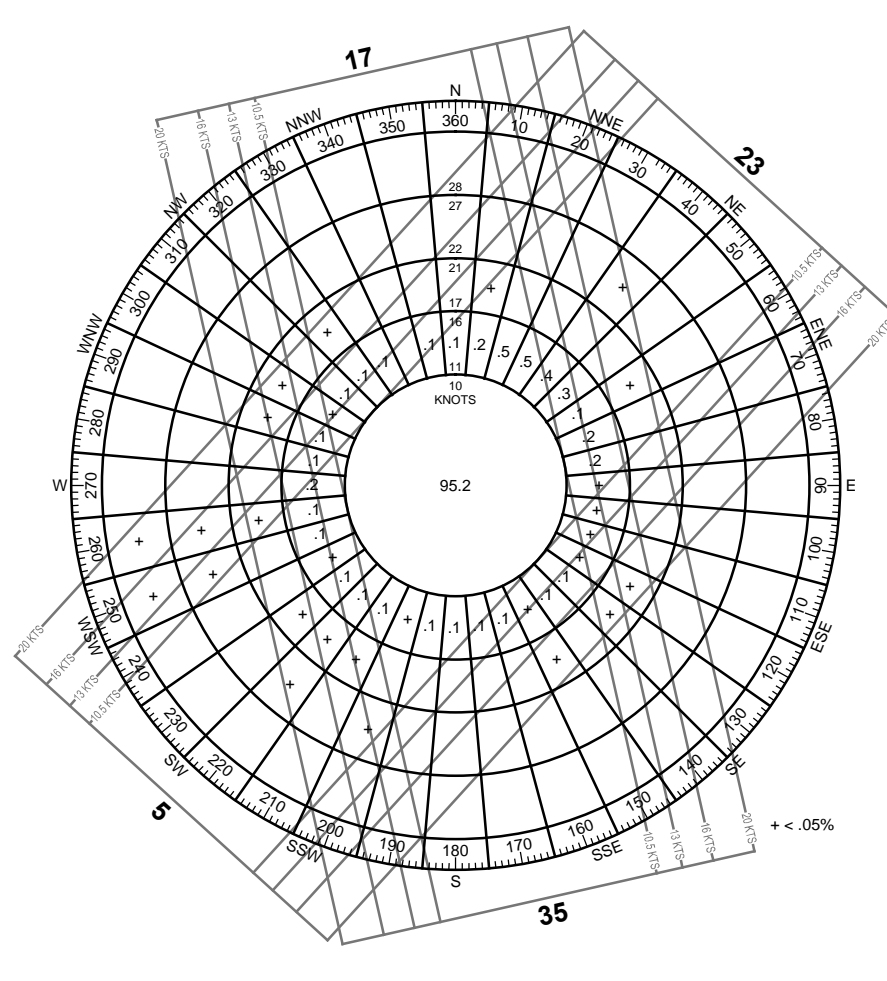
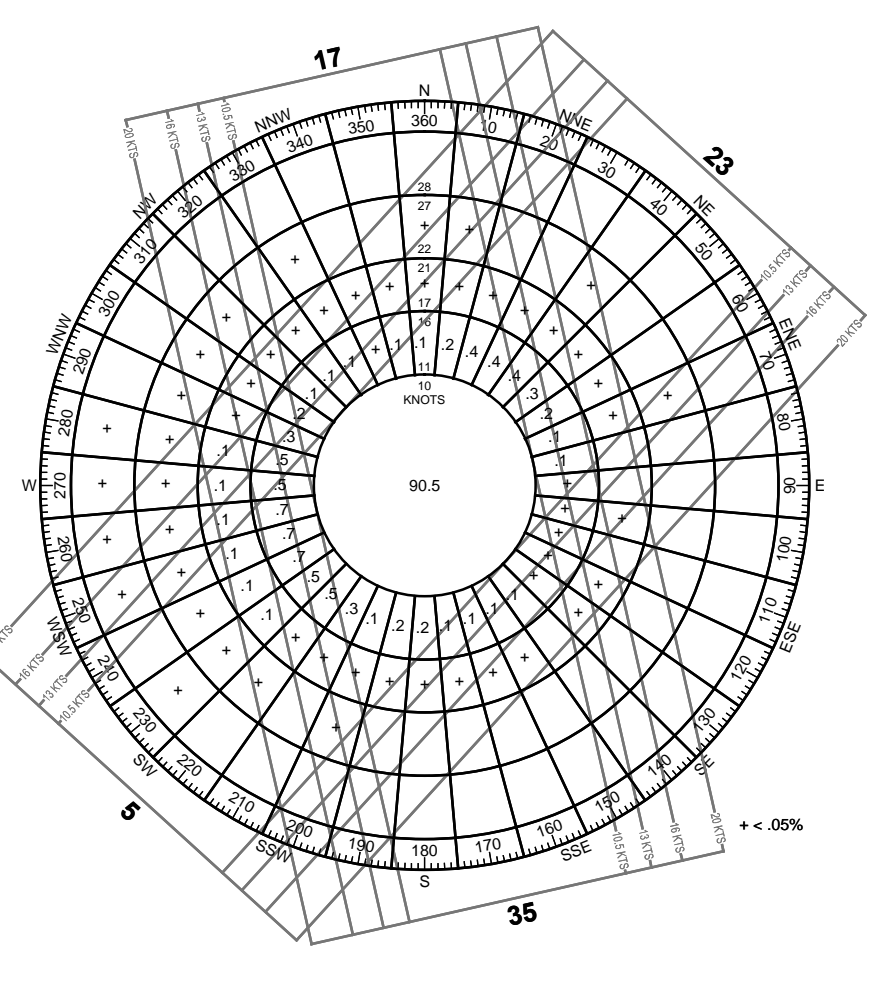
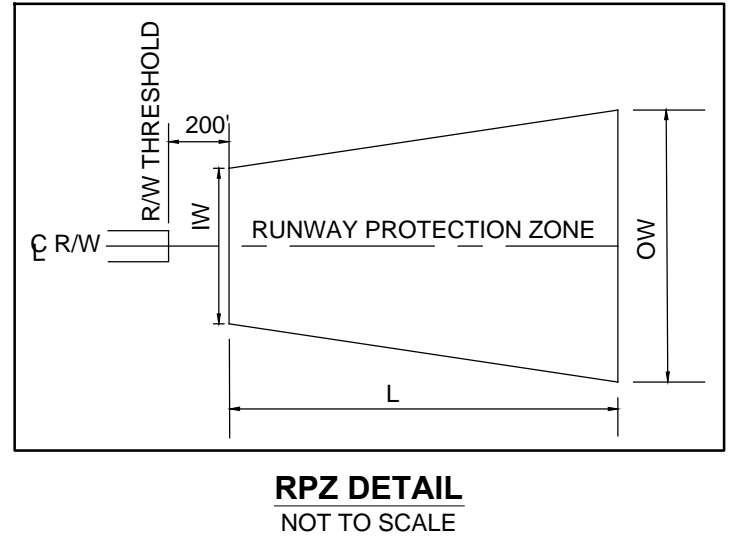
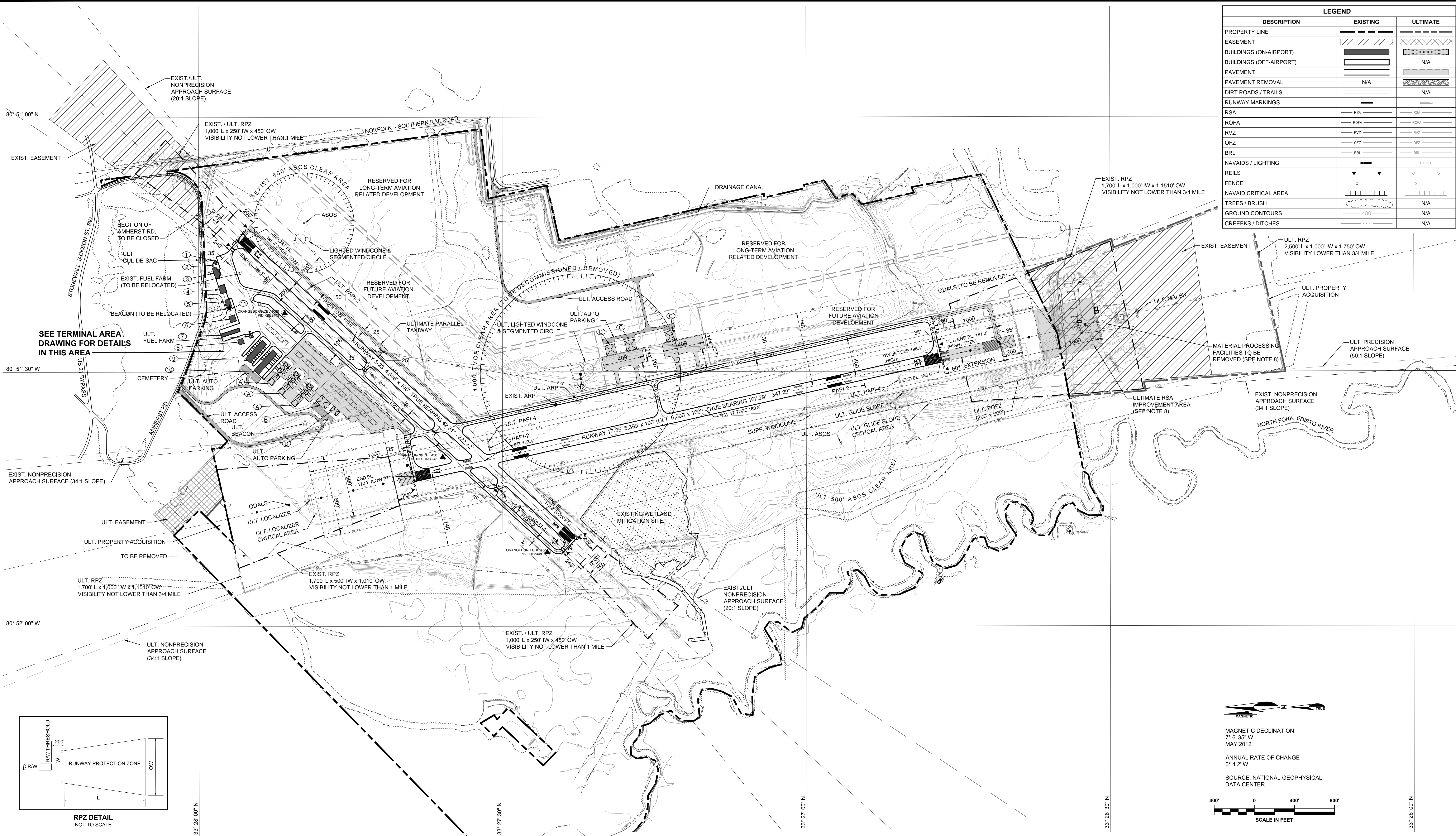

EXISTING BUILDING TABLE with columns: #, DESCRIPTION, SIZE (SF), TOP ELEV. Lists buildings like T-HANGAR, ELECTRICAL VAULT, etc.

ULTIMATE BUILDING TABLE with columns: #, DESCRIPTION, TOP ELEV. Lists ultimate buildings like T-HANGAR, FBO, etc.

RUNWAY DATA TABLE with columns: RUNWAY, EXISTING, ULTIMATE. Includes data for Runway 5-23, Runway 17-35, Runway 5, Runway 23, Runway 17, Runway 35.

AIRPORT DATA table with columns: DESCRIPTION, EXISTING, ULTIMATE. Includes Airport Acreage, Service Level, Airport Reference Point, etc.

MODIFICATION TO FAA DESIGN STANDARDS table with columns: DESCRIPTION, DESIGN STANDARD, AERONAUTICAL STUDY NUMBER, FAA APPROVAL.

AIRPORT SPONSOR APPROVAL section with signature and date: 06/14/12.

CONSTRUCTION NOTICE REQUIREMENT section with text: TO PROTECT OPERATIONAL SAFETY AND ULTIMATE DEVELOPMENT, ALL PROPOSED CONSTRUCTION ON THE AIRPORT MUST BE COORDINATED BY THE AIRPORT OWNER WITH THE FAA AIRPORTS DISTRICT OFFICE PRIOR TO CONSTRUCTION.

FAA DISCLAIMER: THE CONTENTS DO NOT NECESSARILY REFLECT THE OFFICIAL VIEWS OR POLICIES OF THE FAA. THE ACCEPTANCE OF THIS PLAN BY THE FAA DOES NOT IN ANY WAY CONSTITUTE A COMMITMENT ON THE PART OF THE UNITED STATES TO PARTICIPATE IN ANY DEVELOPMENT DEPICTED HEREIN NOR DOES IT INDICATE THAT THE PROPOSED DEVELOPMENT IS ENVIRONMENTALLY ACCEPTABLE IN ACCORDANCE WITH PUBLIC LAWS.

REVISIONS table with columns: No., Description, Date, By.

Table with columns: No., Description, Date, By.

AIRPORT LAYOUT PLAN UPDATE

AIRPORT LAYOUT PLAN DRAWING

Project Name: 3-45-0045-017-2010

Date: MAY 2012 Division: PLANNING

Scale: (30X42) Drawing Number: 1" = 400' 2

Vertical text on the left margin: I:\Projects\Tampa\Orangeburg-CORP\Drawings\ALP Drawings\ALP_Site\02-CORP-ALP.dwg, Jun 14, 2012, 10:28am, tmmal