

RUNWAY 8 APPROACH PROFILE
 1" = 1000' Horiz., 1" = 100' Vert.

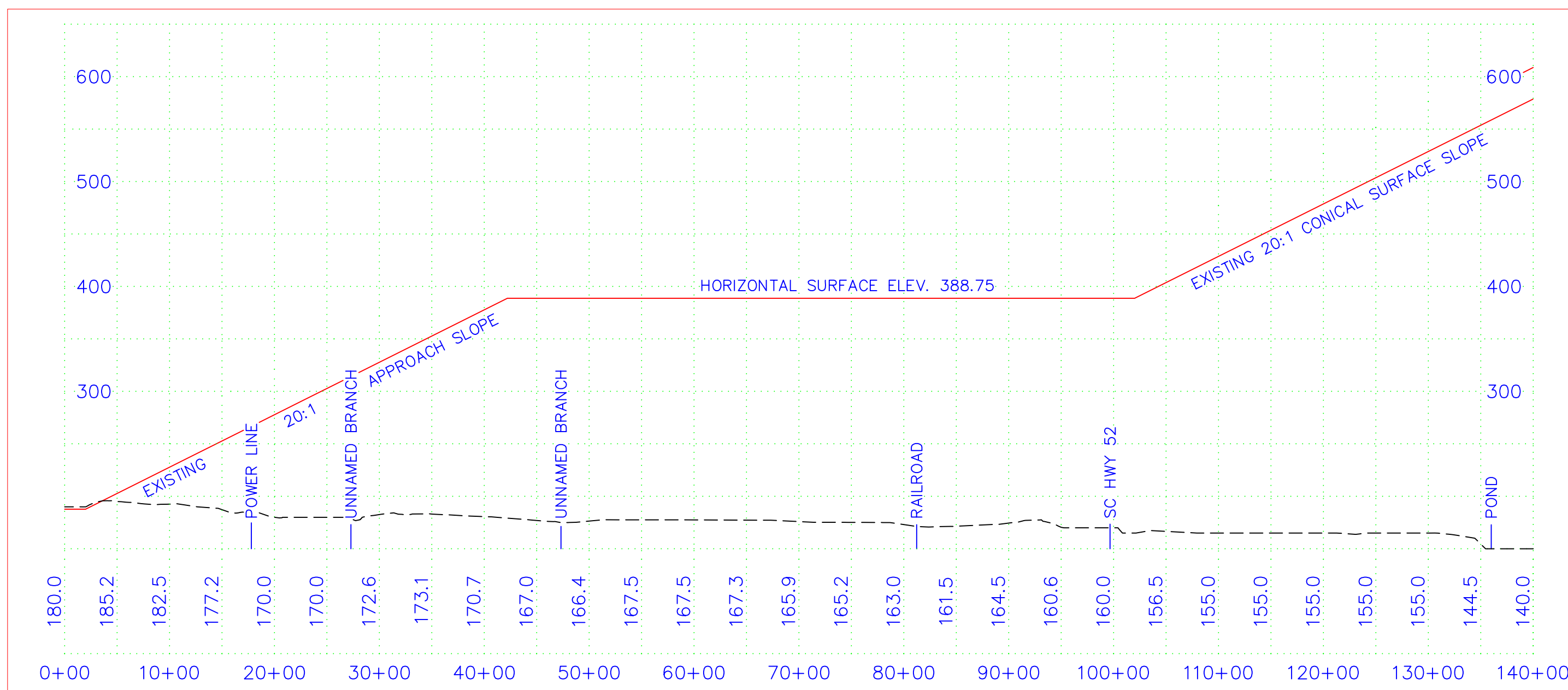

RUNWAY 26 APPROACH PROFILE
 1" = 1000' Horiz., 1" = 100' Vert.

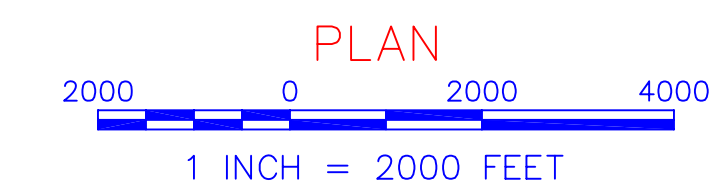
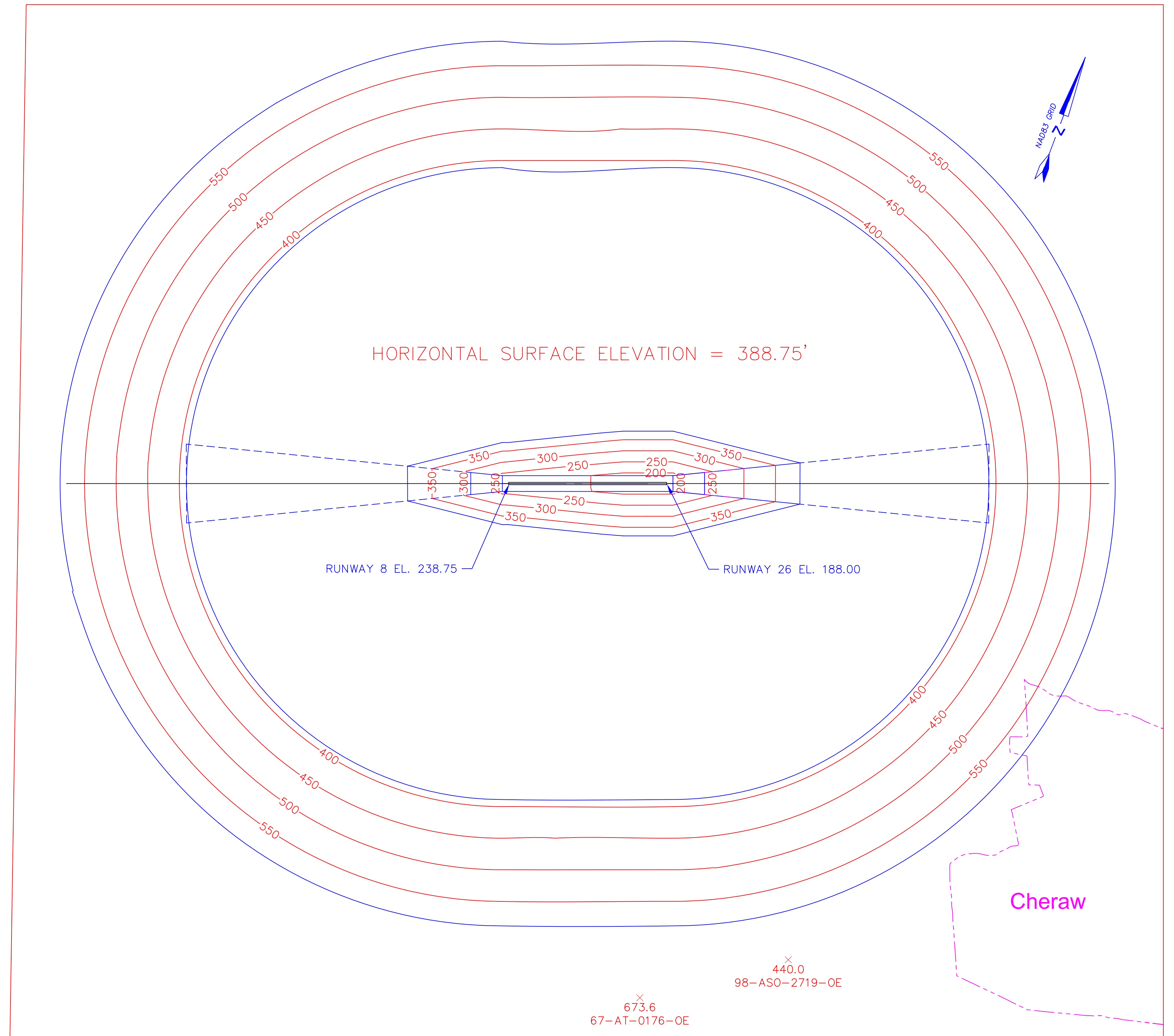

2004

NOTES:
 THERE ARE NO KNOWN OBSTRUCTIONS TO THE AIRSPACE. SEE SHEET 4 OF 6, RUNWAY PROTECTION ZONES, FOR OBSTRUCTIONS TO THE INNER APPROACHES OF THE EACH RUNWAY END.

673.6
 67-AT-0176-OE

LEGEND

TOWER WITH TOP ELEVATION IN FEET AND FAA STUDY NUMBER

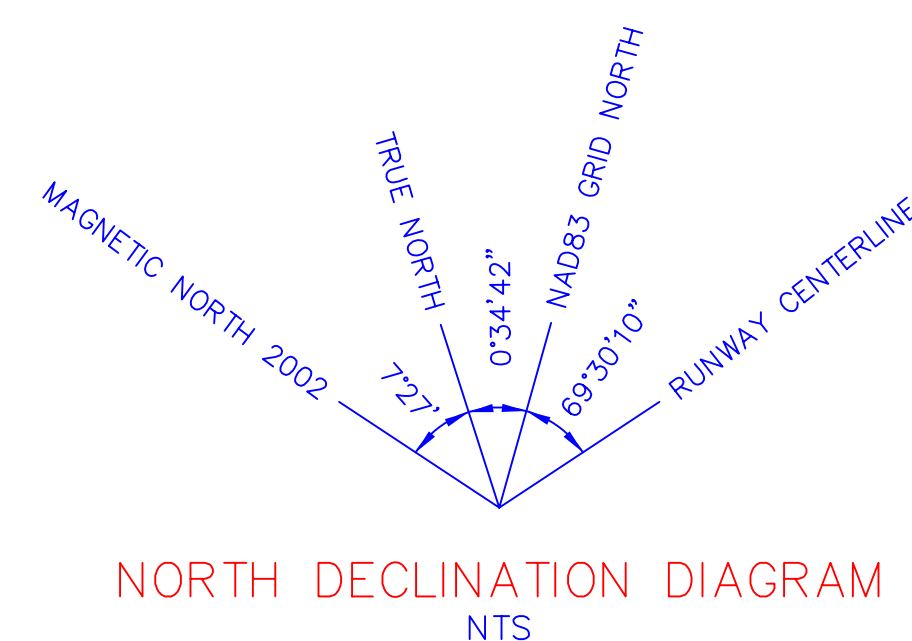

NORTH DECLINATION DIAGRAM
 NTS

NOTES

- 1) REFER TO THE RUNWAY PROTECTION ZONE DRAWING FOR CLOSE-IN OBSTRUCTIONS.
- 2) DIGITAL USGS 7.5 MINUTE QUADRANGLE BASEMAPS AND DIGITIZED CONTOUR INFORMATION WERE SUPPLIED BY THE SOUTH CAROLINA DEPARTMENT OF NATURAL RESOURCES.
- 3) COMMUNICATIONS TOWER INFORMATION WAS TAKEN FROM THE FCC TOWER DATABASE ON 9/28/02.
- 4) COORDINATE VALUES SHOWN ARE NAD83 DATUM IN INTERNATIONAL FEET. F.A.R. PART 77 SURFACE ELEVATIONS SHOWN ARE IN NAVD88 DATUM. BASEMAP ELEVATIONS AND FCC TOWER DATA ARE NGVD29 DATUM.
- 5) REFERENCE THE AIRPORT HEIGHT RESTRICTION ORDINANCE OF CHESTERFIELD COUNTY, SOUTH CAROLINA, ADOPTED 7-1-81.

NO.	REVISIONS	BY	APP.	DATE

TOWN OF CHERAW
CHERAW MUNICIPAL AIRPORT
LYNCH BELLINGER FIELD
 CHERAW, SOUTH CAROLINA
 P.O. Box 219 • Cheraw, S.C. 29520 • (843) 537-8400 • FAX (843) 537-8407

AIR SPACE PLAN

PEARSON Engineering
 WEST COLUMBIA, SOUTH CAROLINA

DATE: JAN. 2004 SCALE: 1" = 2000' SHEET **3** OF **6**