

COPYRIGHT © WK DICKSON & CO., INC. ALL RIGHTS RESERVED. REPRODUCTION OR USE OF THE CONTENTS OF THIS DOCUMENT WITHOUT THE WRITTEN PERMISSION OF WK DICKSON & CO., INC. IS PROHIBITED. ANY UNAUTHORIZED REPRODUCTION OR USE OF THIS DOCUMENT WITHOUT THE WRITTEN PERMISSION OF WK DICKSON & CO., INC. SHALL BE CONSIDERED TO BE A VIOLATION OF FEDERAL COPYRIGHT LAWS AND SHALL BE CONSIDERED TO BE A VIOLATION OF FEDERAL LAWS.

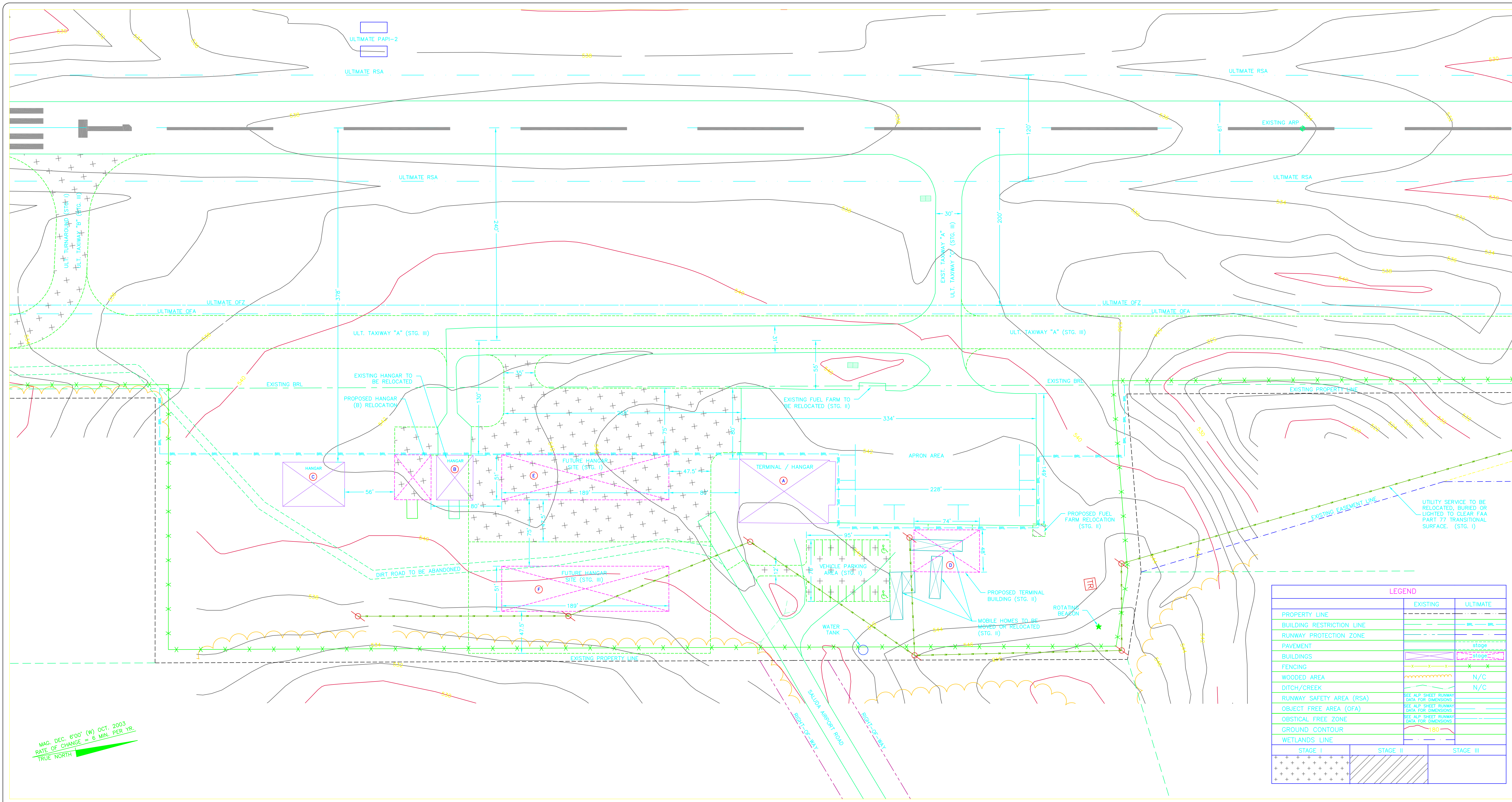

MAG. DEC. 6'00" (W) OCT. 2003
 RATE OF CHANGE = 6 MIN. PER YR.
 TRUE NORTH

LEGEND		
	EXISTING	ULTIMATE
PROPERTY LINE	---	---
BUILDING RESTRICTION LINE	---	---
RUNWAY PROTECTION ZONE	---	---
PAVEMENT	---	stage
BUILDINGS	---	stage
FENCING	---	---
WOODED AREA	---	N/C
DITCH/CREEK	---	N/C
RUNWAY SAFETY AREA (RSA)	SEE ALP SHEET RUNWAY DATA FOR DIMENSIONS	
OBJECT FREE AREA (OFA)	SEE ALP SHEET RUNWAY DATA FOR DIMENSIONS	
OBSTICAL FREE ZONE	SEE ALP SHEET RUNWAY DATA FOR DIMENSIONS	
GROUND CONTOUR	---	---
WETLANDS LINE	---	---
STAGE I	+	
STAGE II	///	
STAGE III		+

IDENTIFICATION	BUILDING TYPE	TOP BUILDING ELEVATION	SIZE (S.F.)
A	TERMINAL / HANGAR	NOT AVAILABLE	7,645
B	HANGAR	NOT AVAILABLE	2,099
C	HANGAR	NOT AVAILABLE	3,500
D	FUTURE TERMINAL BUILDING	NOT AVAILABLE	3,525
E	FUTURE 8 UNIT T-HANGAR	566 (PLANNED)	9,640
F	FUTURE 8 UNIT T-HANGAR	566 (PLANNED)	9,640

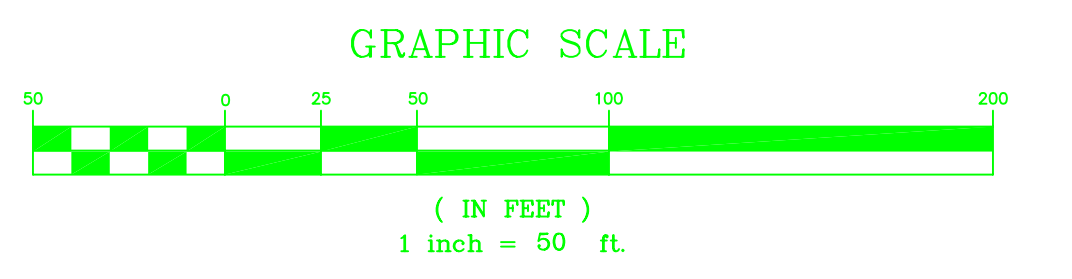

REV. NO.	DESCRIPTION	DATE
	REVISIONS	

PROJECT MANAGER: []
 DRAWN BY: []
 PROJECT DATE: MARCH 2005
 PROJECT NUMBER: 30410.00.CA
 FILE NAME: []
 PLOT DATE: []



501 COMMERCE DRIVE NE
 COLUMBIA, SC 29223
 (803) 786-4261

Atlanta, GA
 Charlotte, NC
 Columbia, SC

Hickory, NC
 Raleigh, NC
 Wilmington, NC

RELEASED FOR: [] DATE: []
 APPROVALS: []
 BIDDING: []
 CONSTRUCTION: []
 RECORD DWG.: []

2005

SALUDA COUNTY AIRPORT
SALUDA, SOUTH CAROLINA

TERMINAL AREA PLAN

6
8
D-4099