

SHORT-TERM TERMINAL AREA (0-5 YEARS)

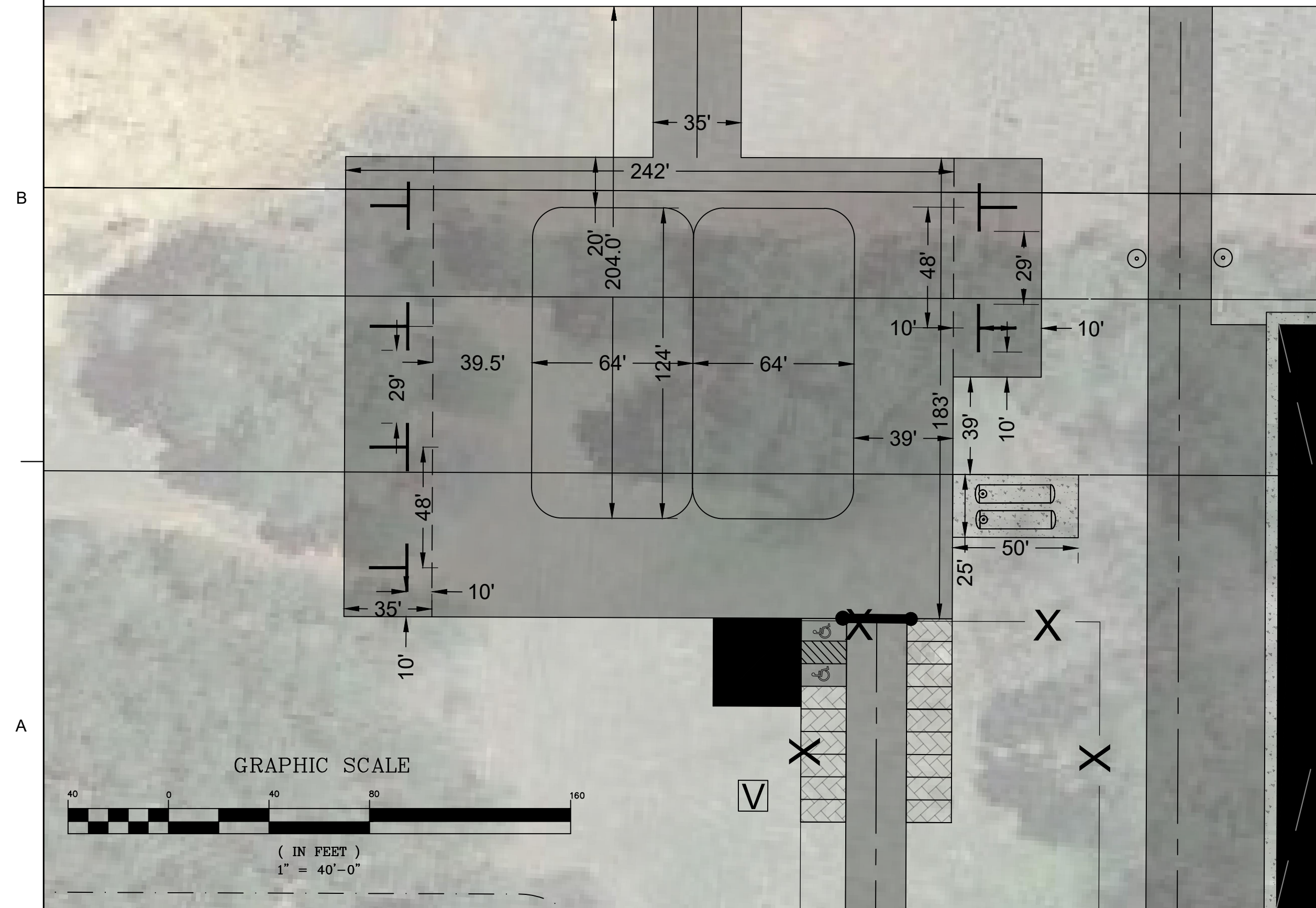

APRON AREA

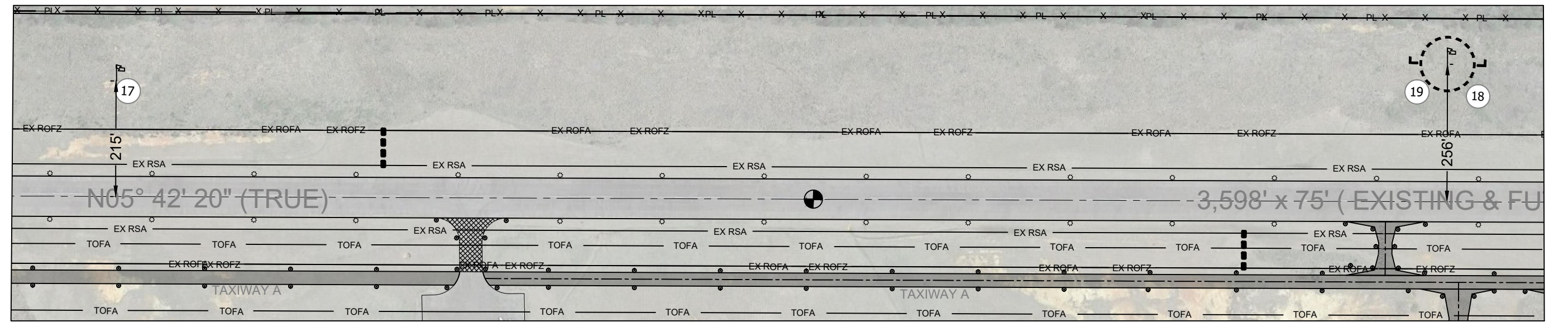

GRAPHIC SCALE
(IN FEET)
1" = 200'-0"

AIRPORT BUILDING/FACILITY LIST		
#	DESCRIPTION	ACTION
1	EXISTING AIRPORT TERMINAL/UTILITY BUILDING	DEMOLISH
2	EXISTING AIRPORT BEACON (OUT OF SERVICE)	REMOVE
3	EXISTING PARKING LOT	REMAIN
4	EXISTING APRON	REMAIN
5	EXISTING WIND CONE	REMAIN
6	EXISTING SEGMENTED CIRCLE	REMAIN
SHORT TERM		
7	PROPOSED FUEL FARM 6,000 GAL (100LL)	CONSTRUCT
8	PROPOSED PARTIAL/FULL PARALLEL TAXIWAY	CONSTRUCT
9	PROPOSED APRON (GROUP I AIRCRAFT)	CONSTRUCT
10	PROPOSED TERMINAL BUILDING (35'x35')	CONSTRUCT
11	PROPOSED TERMINAL PARKING LOT (17 PARKING SPOTS)	CONSTRUCT
12	PROPOSED TERMINAL ACCESS ROAD	CONSTRUCT
13	PROPOSED AIRPORT BEACON	CONSTRUCT
14	PROPOSED ELECTRICAL VAULT	CONSTRUCT
15	PROPOSED FUEL FARM (100LL & JET A)	CONSTRUCT
16	PROPOSED ONE 10-UNIT T-HANGAR BUILDING (232'X55')	CONSTRUCT
17	PROPOSED WIND CONE 1	CONSTRUCT
18	PROPOSED SEGMENTED CIRCLE	CONSTRUCT
19	PROPOSED WIND CONE 2	CONSTRUCT

NOTES:
 1. BUILDING RESTRICTION LINE (15' BRL) ELEVATION IS 15' ABOVE RUNWAY ELEVATION
 2. BUILDING RESTRICTION LINE (25' BRL) ELEVATION IS 25' ABOVE RUNWAY ELEVATION
 3. NEW TERMINAL DEVELOPMENT IS DEMAND-BASED AND WILL BE CONSIDERED WHEN JUSTIFIED

EXISTING	ULTIMATE	DESCRIPTION
---	---	PAVEMENT
---	---	BUILDINGS
---	---	DEMOLITION
---	---	ULT RSA
---	---	RUNWAY SAFETY AREA
---	---	ULT ROFA
---	---	RUNWAY OBJECT FREE AREA
---	---	ULT ROFZ
---	---	RUNWAY OBJECT FREE ZONE
---	---	TOFA
---	---	TAXIWAY OBJECT FREE AREA
---	---	TSA
---	---	TAXIWAY SAFETY AREA
---	---	EXTENDED RUNWAY CENTERLINE
---	---	PROPOSED BUILDING RESTRICTION LINE
---	---	PROPOSED ELECTRICAL VAULT
---	---	WINDCONE
---	---	SEGMENTED CIRCLE
---	---	AIRPORT BEACON
---	---	PROPOSED RUNWAY LIGHTS
---	---	PROPOSED TAXIWAY LIGHTS
---	---	PROPOSED 8' FENCE
---	---	EXISTING PROPERTY LINE
---	---	FUTURE PROPERTY LINE
---	---	PROPOSED GATE

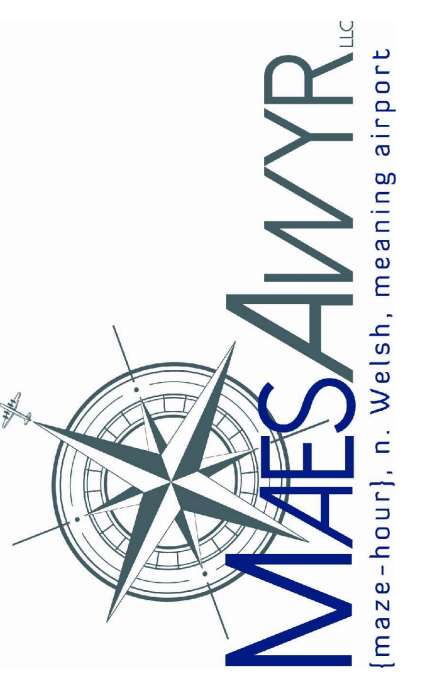

1245 Buford Highway, Suite 305
 Suwanee, Georgia 30024
 t: 770.262.1191
 e: hey@maesawyr.com
 w: maesawyr.com

ISSUE DATE: Original JANUARY, 2023

Designed by: OK
 Drafted by: VKB
 Verified by: AJH



MCCORMICK COUNTY AIRPORT
 MCCORMICK, SOUTH CAROLINA
 SCAC GRANT NUMBER 22-034
 MAESAWYR PROJECT NUMBER MA.S.19.1001
 SCALE: VARIES

SHORT-TERM
 TERMINAL AREA DRAWING
 (0-5 YEARS)

3

Sheet 3 of 6

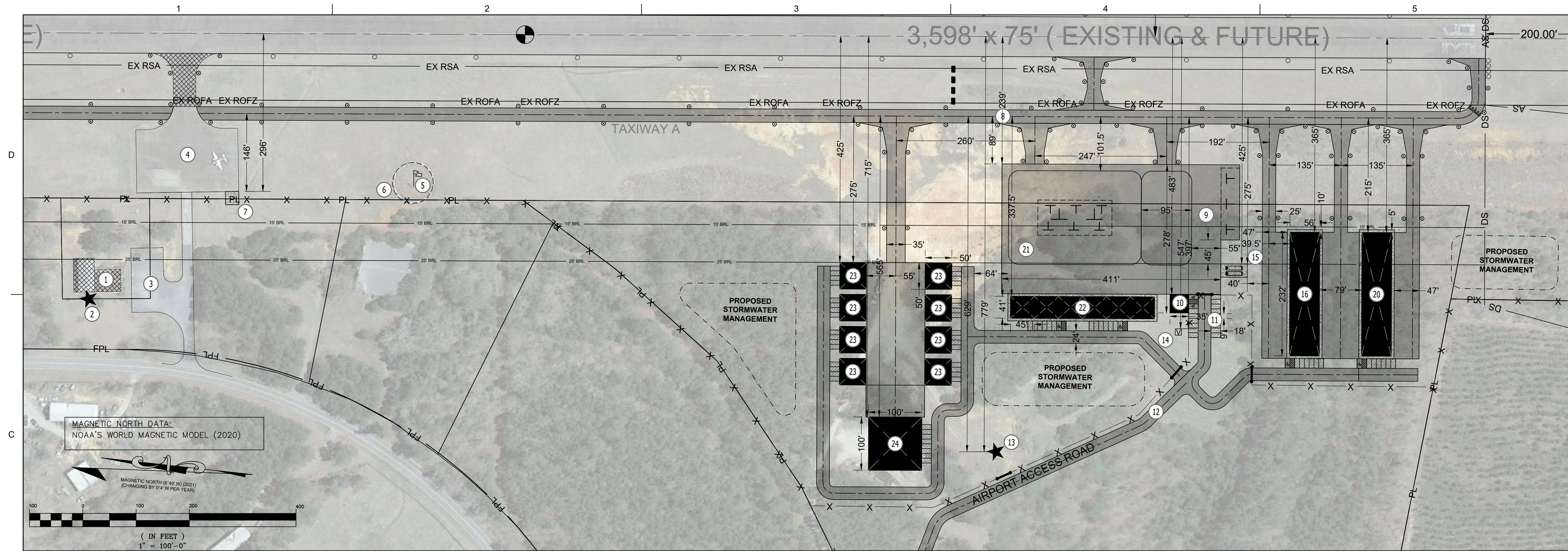

LONG-TERM TERMINAL AREA (UP TO 10 YEARS)

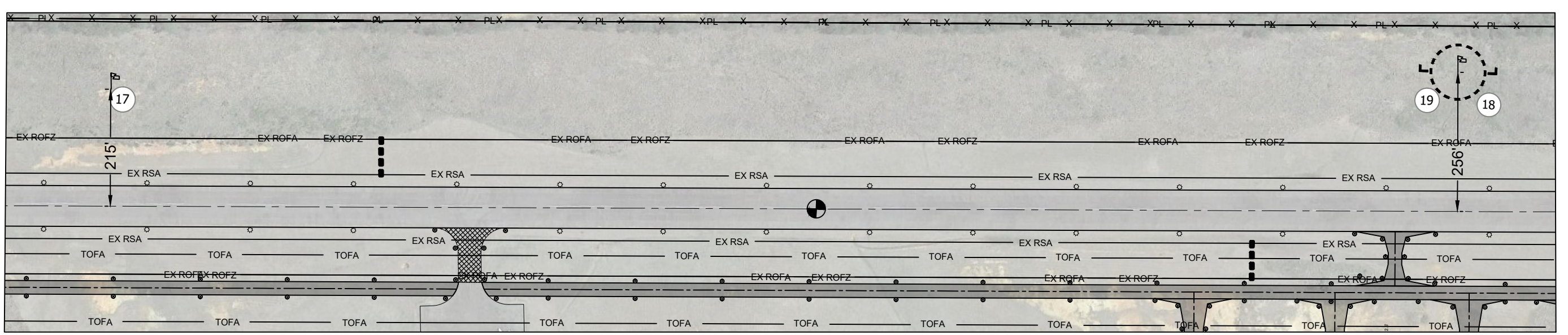
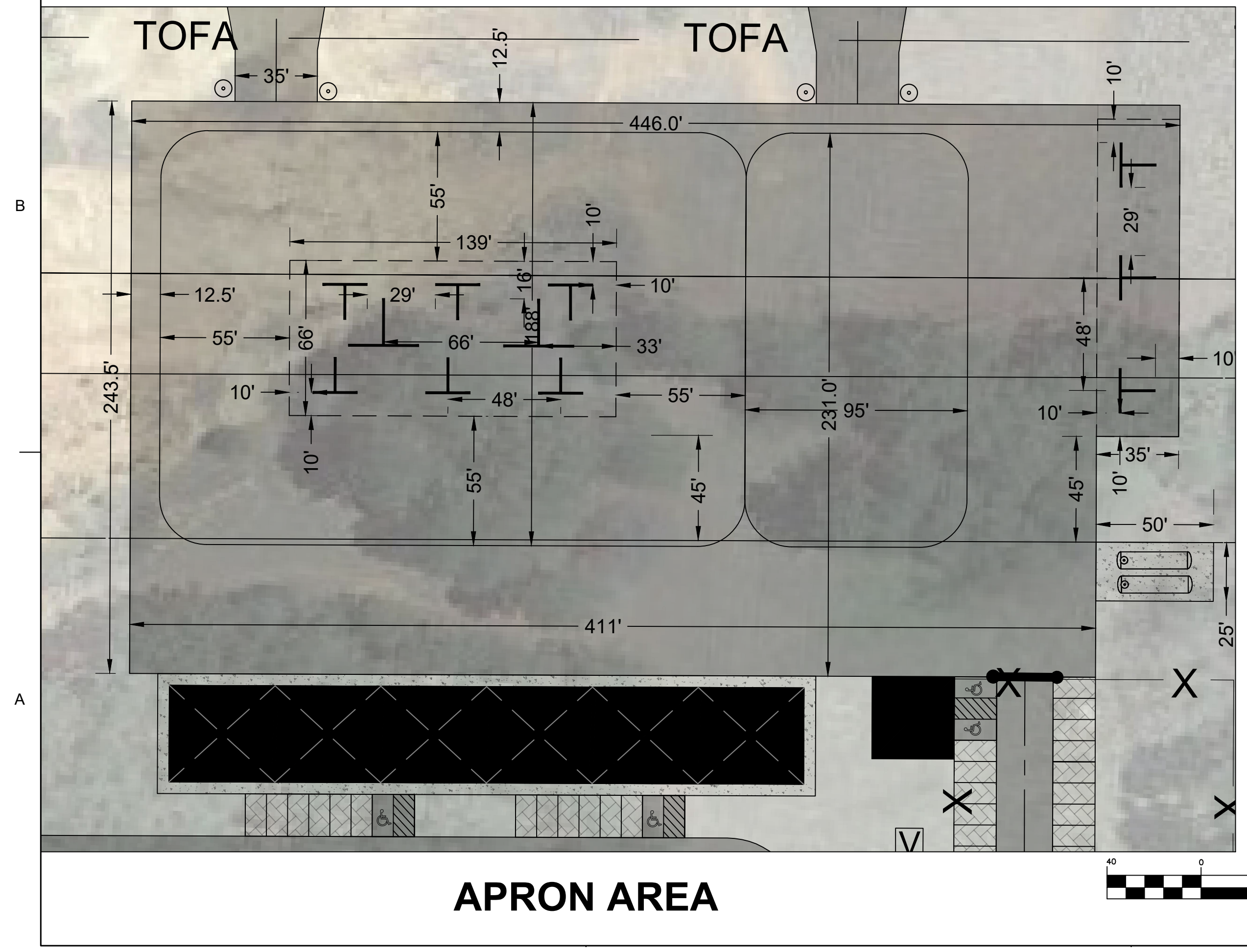

- NOTES:**
- BUILDING RESTRICTION LINE (15' BRL) ELEVATION IS 15' ABOVE RUNWAY ELEVATION
 - BUILDING RESTRICTION LINE (25' BRL) ELEVATION IS 25' ABOVE RUNWAY ELEVATION
 - NEW TERMINAL DEVELOPMENT IS DEMAND-BASED AND WILL BE CONSIDERED WHEN JUSTIFIED

AIRPORT BUILDING/FACILITY LIST			
#	EXISTING	DESCRIPTION	ACTION
1	EXISTING	AIRPORT TERMINAL/UTILITY BUILDING	DEMOLISH
2	EXISTING	AIRPORT BEACON (OUT OF SERVICE)	REMOVE
3	EXISTING	PARKING LOT	REMAIN
4	EXISTING	APRON	REMAIN
5	EXISTING	WIND CONE	REMAIN
6	EXISTING	SEGMENTED CIRCLE	REMAIN
SHORT TERM			
7	PROPOSED	FUEL FARM 6,000 GAL (100LL)	CONSTRUCT
8	PROPOSED	PARTIAL/FULL PARALLEL TAXIWAY	CONSTRUCT
9	PROPOSED	APRON (GROUP 1 AIRCRAFT)	CONSTRUCT
10	PROPOSED	TERMINAL BUILDING (35'x35')	CONSTRUCT
11	PROPOSED	TERMINAL PARKING LOT (17 PARKING SPOTS)	CONSTRUCT
12	PROPOSED	TERMINAL ACCESS ROAD	CONSTRUCT
13	PROPOSED	AIRPORT BEACON	CONSTRUCT
14	PROPOSED	ELECTRICAL VAULT	CONSTRUCT
15	PROPOSED	FUEL FARM (100LL & JET A)	CONSTRUCT
16	PROPOSED	ONE 10-UNIT T-HANGAR BUILDING (232'x55')	CONSTRUCT
17	PROPOSED	WIND CONE 1	CONSTRUCT
18	PROPOSED	SEGMENTED CIRCLE	CONSTRUCT
19	PROPOSED	WIND CONE 2	CONSTRUCT
LONG TERM			
20	PROPOSED	ONE 10-UNIT T-HANGAR BUILDING (232'x55')	CONSTRUCT
21	PROPOSED	APRON (GROUP 1 AND 2 AIRCRAFT)	EXPAND
22	PROPOSED	ONE CONVENTIONAL BOX HANGARS BUILDING WITH SIX 45'x41' HANGARS	CONSTRUCT
23	PROPOSED	EIGHT BOX HANGAR BUILDINGS (50'x50')	CONSTRUCT
24	PROPOSED	ONE CORPORATE HANGAR BUILDING (100'x100')	CONSTRUCT

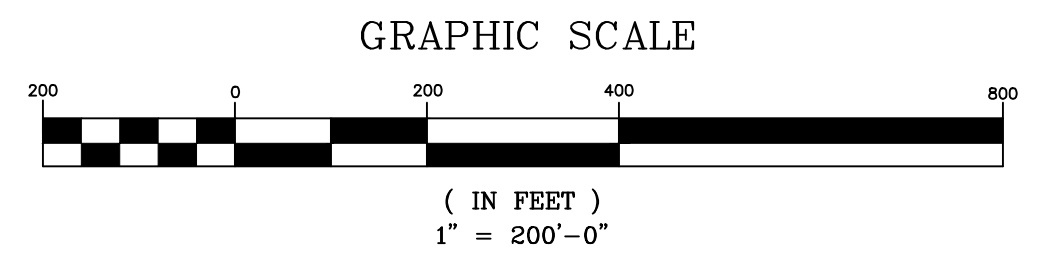

LEGEND

EXISTING	ULTIMATE	DESCRIPTION
[Symbol]	[Symbol]	PAVEMENT
[Symbol]	[Symbol]	BUILDINGS
[Symbol]	[Symbol]	DEMOLITION
[Symbol]	[Symbol]	RUNWAY SAFETY AREA
[Symbol]	[Symbol]	RUNWAY OBJECT FREE AREA
[Symbol]	[Symbol]	RUNWAY OBJECT FREE ZONE
[Symbol]	[Symbol]	TAXIWAY OBJECT FREE AREA
[Symbol]	[Symbol]	TAXIWAY SAFETY AREA
[Symbol]	[Symbol]	EXTENDED RUNWAY CENTERLINE
[Symbol]	[Symbol]	PROPOSED BUILDING RESTRICTION LINE
[Symbol]	[Symbol]	PROPOSED ELECTRICAL VAULT
[Symbol]	[Symbol]	WINDCONE
[Symbol]	[Symbol]	SEGMENTED CIRCLE
[Symbol]	[Symbol]	AIRPORT BEACON
[Symbol]	[Symbol]	PROPOSED RUNWAY LIGHTS
[Symbol]	[Symbol]	PROPOSED TAXIWAY LIGHTS
[Symbol]	[Symbol]	PROPOSED 8' FENCE
[Symbol]	[Symbol]	EXISTING PROPERTY LINE
[Symbol]	[Symbol]	FUTURE PROPERTY LINE
[Symbol]	[Symbol]	PROPOSED GATE

MCCORMICK COUNTY AIRPORT
 MCCORMICK, SOUTH CAROLINA
 SCAC GRANT NUMBER 22-034
 MAESAWYR PROJECT NUMBER MA.S.19.1001
 SCALE: VARIES

LONG-TERM TERMINAL AREA DRAWING (UP TO 10 YRS)

4 of 6

MAESAWYR
 (maze-hour), n. Welsh, meaning airport

1245 Buford Highway, Suite 305
 Suwanee, Georgia 30024
 t: 770.262.1191
 e: hey@maesawyr.com
 w: maesawyr.com

ISSUE DATE: Original JANUARY, 2023
 Designed by: OK
 Drafted by: VKB
 Verified by: AJH

McCormick County
 The Natural Pace of Life