



SOUTH CAROLINA AERONAUTICS COMMISSION

STATEWIDE AIRFIELD PAVEMENT MANAGEMENT SYSTEM UPDATE

 UZA – Rock Hill – York County Airport/Bryant Field



Kimley»»Horn

2022



Contents

Overview	3
Introduction	3
System Inventory	4
Functional Evaluation	7
Pavement Condition Index.....	7
Critical PCI.....	8
PCI Results Summary	8
Pavement Condition Forecast	10
M&R Overview	14
Localized Maintenance and Repair.....	15
Major Rehabilitation Needs.....	15
Appendix A – Exhibits	A-1
Appendix B – Analysis Tables.....	B-1
Appendix C – Maintenance and Rehabilitation Tables	C-1
Appendix D – Detailed PCI Results.....	D-1
Appendix E – Re-Inspection Report	E-1

Overview

Introduction

For over 20 years, the South Carolina Aeronautics Commission (SCAC) has implemented an airfield pavement management program for publicly owned South Carolina airports. As part of their grant assurances federally obligated airports are required to perform detailed inspections as outlined in the FAA Advisory Circular 150/5380-7B – “Airport Pavement Management Program (PMP)”. All inspections performed within this program follow the guidance documented within the ASTM D5340-20 – “Standard Test Method for Airport Pavement Condition Surveys”. This is an objective process to assess the pavement condition in a consistent and repeatable manner.

Due to ever-changing pavement conditions, the FAA AC 150/5380-7B recommends the PMP be updated every 3 years. The overall pavement conditions are analyzed using the ASTM PCI methodology. It provides decision makers with a comparison of pavement facilities and a relative indication of their required maintenance or level of repair to aid in project prioritization. A detailed explanation of the SCAC airfield pavement management program process and pavement management terminology can be found in the [SCAC Statewide Report](#).

Project elements performed for the 2021-2024 program update included the development and update of pavement inventories, documentation of pavement conditions, performance modeling, and maintenance and rehabilitation (M&R) needs for all participating airports. This report summarizes the results of the SCAC pavement management program update at Rock Hill – York County Airport/Bryant Field (UZA).

Figure 1 – Airport Layout



System Inventory

The pavements at Rock Hill – York County Airport/Bryant Field (UZA) include approximately 1.5 million square feet of airfield pavements consisting of runways, taxiways, and aprons. Per the guidance in the ASTM D5340-20, all pavements were divided and subdivided into pavement management units (Network, Branch, Section, Sample). The divisions are documented in the **Network Definition Exhibit** providing the name and location of each branch, section, and sample.

Each pavement update included a review of documentation of any maintenance and major rehabilitation related activities performed on the airfield pavements. The following table summarizes the projects that have occurred since the previous inspection.

Table 1 - Recent Airfield Pavement Construction

Construction Year	Location	Work Type / Pavement Section
<i>*No documented or identified projects occurred since the previous inspection.</i>		

The following figure summarizes the inventory items at Rock Hill – York County Airport/Bryant Field (UZA). The **Estimated Age Exhibit** provides the last major work date for each pavement section based on the collected documentation.

Figure 2 – System Inventory Summary

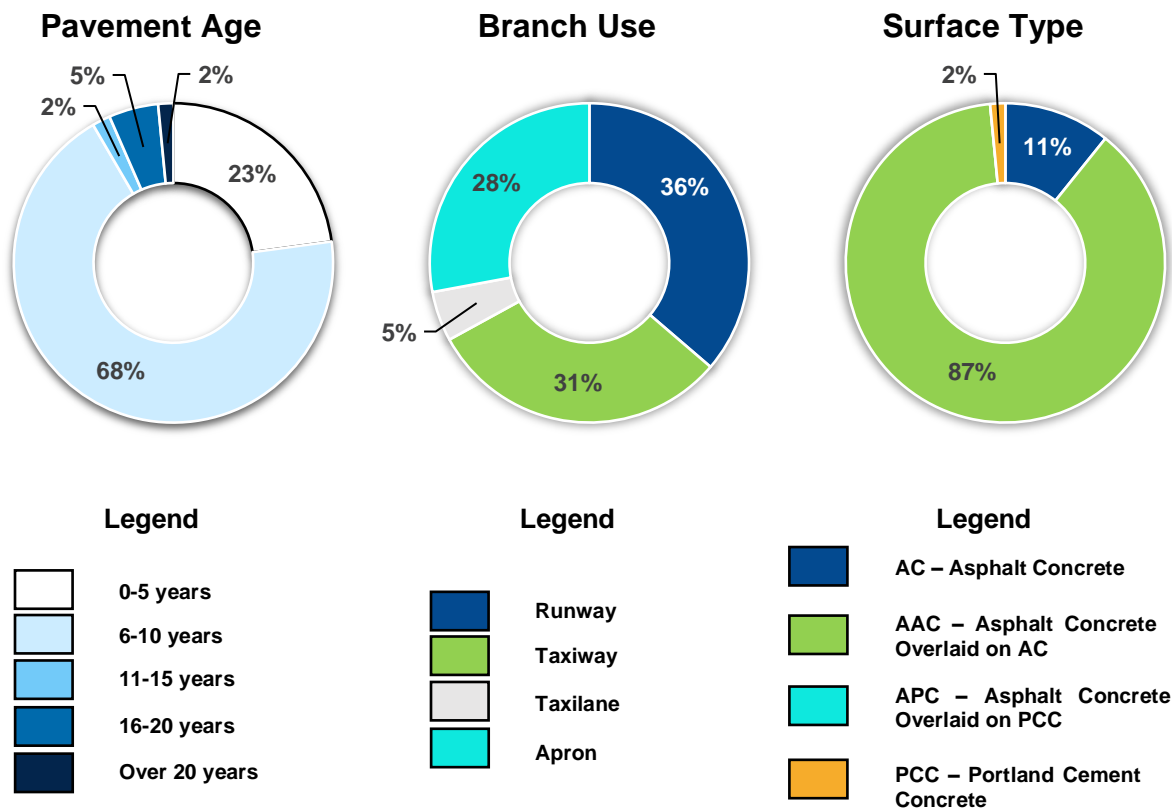

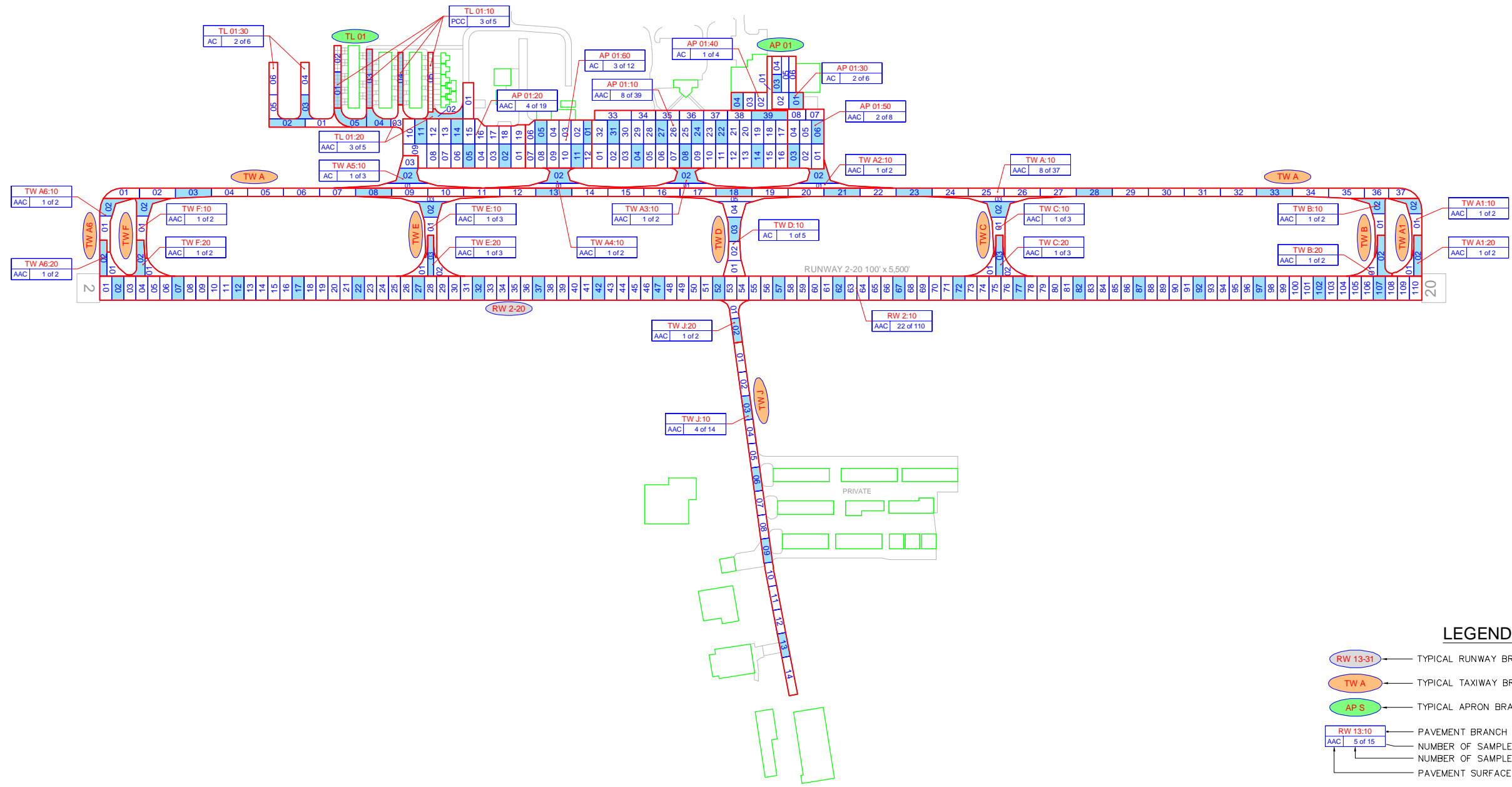

LEGEND

- RW 13-31 TYPICAL RUNWAY BRANCH ID
- TW A TYPICAL TAXIWAY BRANCH ID
- AP S TYPICAL APRON BRANCH ID
- RW 13-10 PAVEMENT BRANCH ID: SECTION ID
- AAC 5 of 15 NUMBER OF SAMPLE UNITS IN SECTION
- AAC 1 of 2 NUMBER OF SAMPLE UNITS TO BE INSPECTED
- AAC PAVEMENT SURFACE TYPE
- RW 13-20 SECTION NOT INSPECTED DUE TO RECENT CONSTRUCTION. SEE ESTIMATED AGE EXHIBIT FOR CONSTRUCTION DATES.
- AAC 0 of 5
- 100 INSPECTED SAMPLE UNITS.

TOTAL SAMPLES INSPECTED = 81
AC: 78 PCC: 3

RUNWAY LENGTHS DEPICTED IN THIS DRAWING ARE FOR PAVEMENT MANAGEMENT PURPOSES ONLY AND MAY NOT MATCH PUBLISHED RUNWAY LENGTHS. DRAWING NOT TO SCALE.



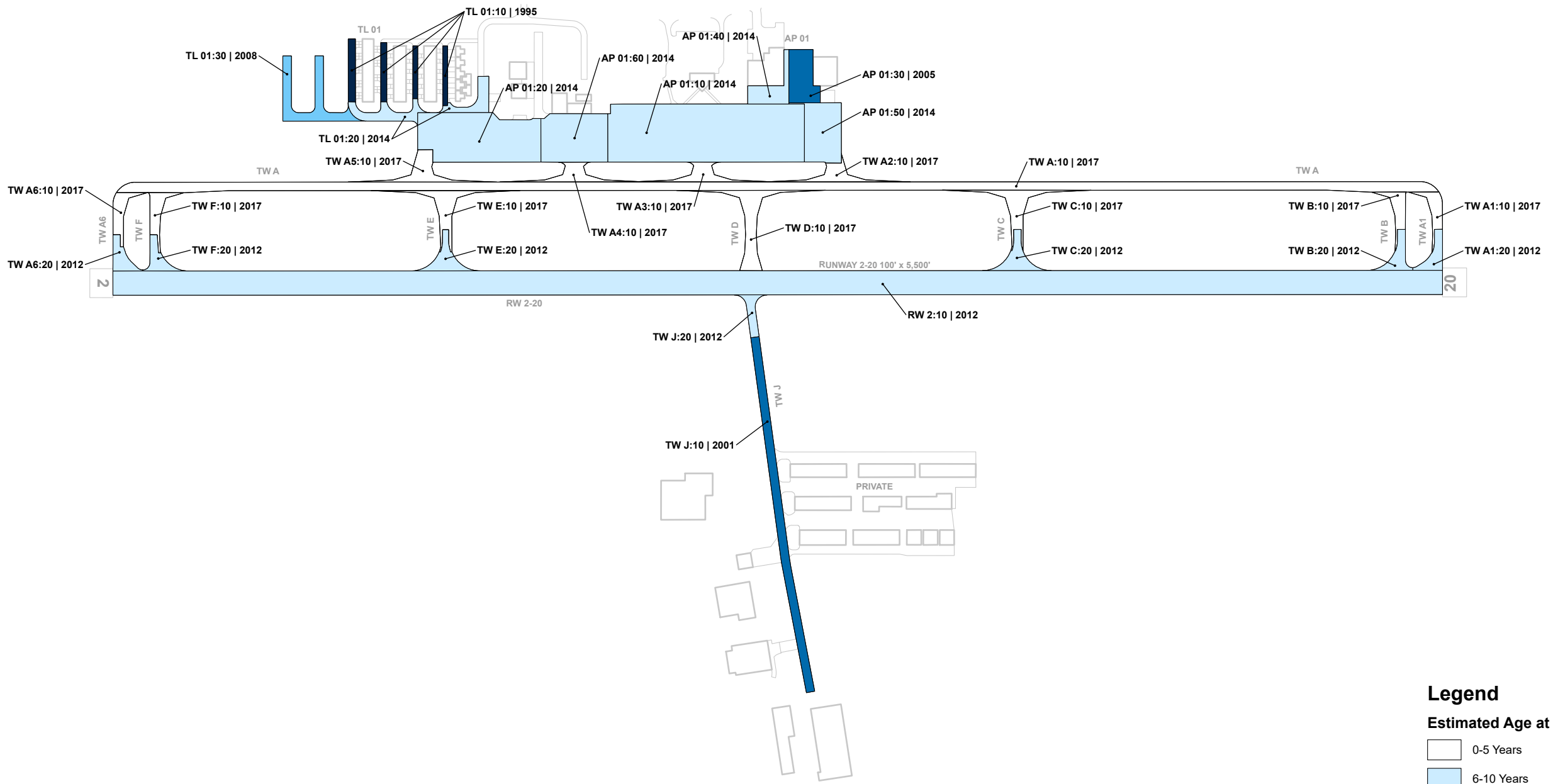

Legend

Estimated Age at Inspection

- 0-5 Years
- 6-10 Years
- 11-15 Years
- 16-20 Years
- > 20 Years

┌─── BRANCH IDENTIFIER
└─── SECTION IDENTIFIER
TWA:20 | 1985
└─── LAST MAJOR WORK DATE

STATEWIDE AIRFIELD PAVEMENT MANAGEMENT SYSTEM UPDATE

ROCK HILL - YORK COUNTY AIRPORT/BRYANT FIELD (UZA)
AIRFIELD PAVEMENT ESTIMATED AGE EXHIBIT



Functional Evaluation

Pavement Condition Index

A Pavement Condition Index (PCI) survey is the primary means of obtaining and recording pavement distress data. In adherence to FAA Advisory Circular 150/5380-7B, the SCAC Airfield Pavement Management System (APMS) Update utilizes the PCI survey methodology to collect pavement distress data and analyze the condition. This method uses a visual statistical sampling of pavements for recording primary distress types, associated severities, and quantities as defined by the ASTM D5340-20.

Visual condition data collected during the PCI survey is analyzed and used to calculate the current PCI for each inspected sample unit and section. The PCI is a value ranging from 0 to 100, which indicates the apparent structural integrity and surface operational condition of the pavement, with **“100” indicating a pavement in new condition and “0” indicating a failed pavement section**. Pavement Condition Ratings are associated with PCI categories that range from Failed to Good. Representative photos of varying Pavement Condition Ratings are displayed in **Figure 3**.

Figure 3 – Representation of Pavement Condition Index Values

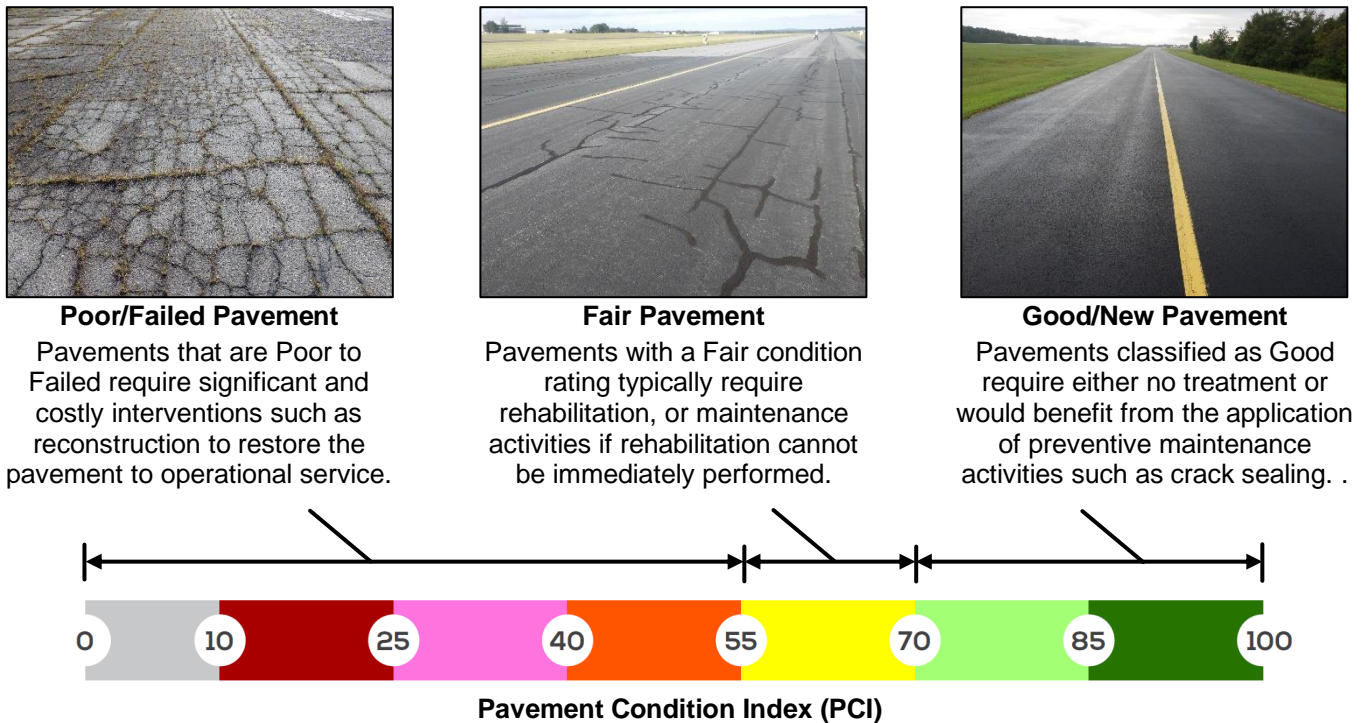

Critical PCI

From a pavement management perspective, one of the most valuable aspects of the PCI methodology is the ability to save money by effectively prioritizing the rehabilitation of pavement assets. Critical PCI refers to the condition beyond which the rate of pavement deterioration and the cost of applying a treatment increases significantly. In other words, it is the condition at which maintenance may no longer be cost effective and major rehabilitation should be considered. Based on the 2019 FAA Order 5100.38D Change 1 Airport Improvement Program Handbook, the FAA has established recommended PCI thresholds for pavement M&R. Accordingly, **the Critical PCI for all SCAC airfield pavements is defined at 70.**

PCI Results Summary

The PCI survey for Rock Hill – York County Airport/Bryant Field (UZA) was performed in September 2021. **The overall area-weighted average PCI value of the network was 81**, representing a condition rating of **Satisfactory**. Approximately 91% of inspected pavements are in Good or Satisfactory condition, 7% of inspected pavements are in Fair condition, and the remaining 2% are in Poor or worse condition as summarized in **Figure 4**.

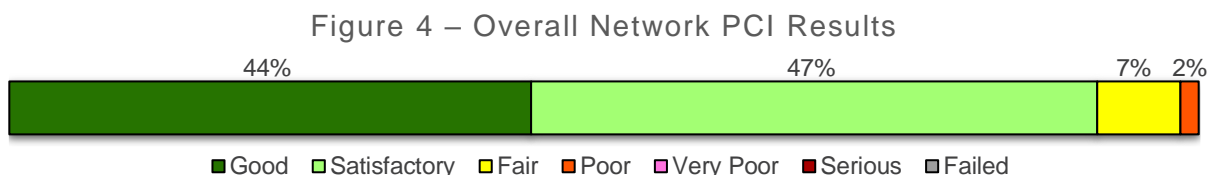

The area-weighted average PCIs by branch use are summarized in the figure below. The current PCIs at a section-level are displayed graphically on the **2021 Airfield Pavement Condition Index (PCI) Exhibit** and are summarized in **Table 2**.

Figure 5 – Area Weighted Average Pavement Condition

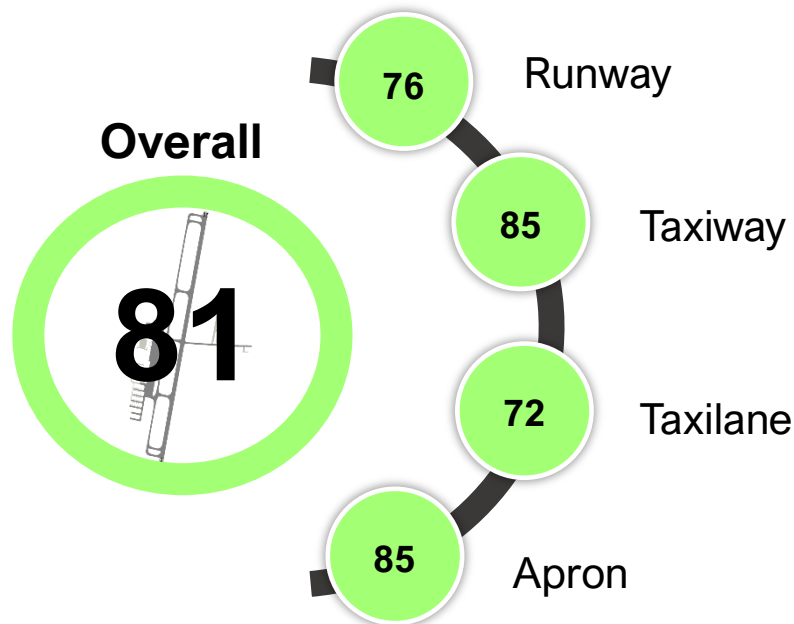



STATEWIDE AIRFIELD PAVEMENT MANAGEMENT SYSTEM UPDATE

UZA – Rock Hill – York County Airport/Bryant Field

Table 2 – Current Pavement Condition Index Summary - Section

Network ID	Branch ID	Branch Use	Section ID	Area (SF)	Surface	PCI	Condition Rating	PCI % Climate	PCI % Load	PCI % Other
UZA	AP 01	Apron	10	194,880	AAC	86	Good	100	0	0
UZA	AP 01	Apron	20	95,917	AAC	83	Satisfactory	100	0	0
UZA	AP 01	Apron	60	54,695	AC	86	Good	100	0	0
UZA	AP 01	Apron	50	38,073	AAC	93	Good	100	0	0
UZA	AP 01	Apron	30	24,100	AC	64	Fair	42	58	0
UZA	AP 01	Apron	40	15,750	AC	93	Good	91	0	9
UZA	RW 2	Runway	10	550,200	AAC	76	Satisfactory	84	0	16
UZA	TL 01	Taxilane	20	25,506	AAC	88	Good	100	0	0
UZA	TL 01	Taxilane	10	23,225	PCC	41	Poor	13	67	20
UZA	TL 01	Taxilane	30	27,780	AC	82	Satisfactory	100	0	0
UZA	TW A	Taxiway	10	195,846	AAC	91	Good	100	0	0
UZA	TW A1	Taxiway	10	9,224	AAC	92	Good	100	0	0
UZA	TW A1	Taxiway	20	9,180	AAC	78	Satisfactory	100	0	0
UZA	TW A2	Taxiway	10	11,626	AAC	89	Good	100	0	0
UZA	TW A3	Taxiway	10	11,934	AAC	88	Good	100	0	0
UZA	TW A4	Taxiway	10	11,970	AAC	86	Good	100	0	0
UZA	TW A5	Taxiway	10	15,305	AC	94	Good	100	0	0
UZA	TW A6	Taxiway	10	10,190	AAC	87	Good	100	0	0
UZA	TW A6	Taxiway	20	8,703	AAC	72	Satisfactory	100	0	0
UZA	TW B	Taxiway	10	9,398	AAC	91	Good	100	0	0
UZA	TW B	Taxiway	20	9,648	AAC	63	Fair	100	0	0
UZA	TW C	Taxiway	10	17,228	AAC	91	Good	100	0	0
UZA	TW C	Taxiway	20	12,212	AAC	76	Satisfactory	100	0	0
UZA	TW D	Taxiway	10	25,798	AC	94	Good	100	0	0
UZA	TW E	Taxiway	10	17,715	AAC	94	Good	100	0	0
UZA	TW E	Taxiway	20	11,725	AAC	63	Fair	100	0	0
UZA	TW F	Taxiway	10	10,312	AAC	85	Satisfactory	94	0	6
UZA	TW F	Taxiway	20	8,574	AAC	63	Fair	100	0	0
UZA	TW J	Taxiway	10	52,031	AAC	64	Fair	100	0	0
UZA	TW J	Taxiway	20	7,300	AAC	75	Satisfactory	100	0	0

*For further PCI details and photos see Appendix D – Detailed PCI Results.

Pavement Condition Forecast

A primary objective of this APMS is to estimate the future condition of each individual pavement section. PAVER™ was utilized to develop prediction curves and determine typical deterioration rates that are then used to forecast a future PCI. This value will assist decision makers in determining at what point in time certain pavement sections will require rehabilitation. The figure below shows the current and 5-year area-weighted forecasted pavement condition distribution of each functional use (Runway, Taxiway, Taxilane, Apron) found at the Airport. The forecasted 5-year PCIs at a section-level are displayed graphically on the **2026 Forecasted Airfield Pavement Condition Index Exhibit** and are summarized in **Table 3**. All forecasts presented assume that no maintenance or rehabilitation is performed within the 5-year analysis period. **Figure 6** displays the forecasted pavement conditions at the branch-level for UZA.

Figure 6 – Forecasted 5-Year PCI by Branch Use

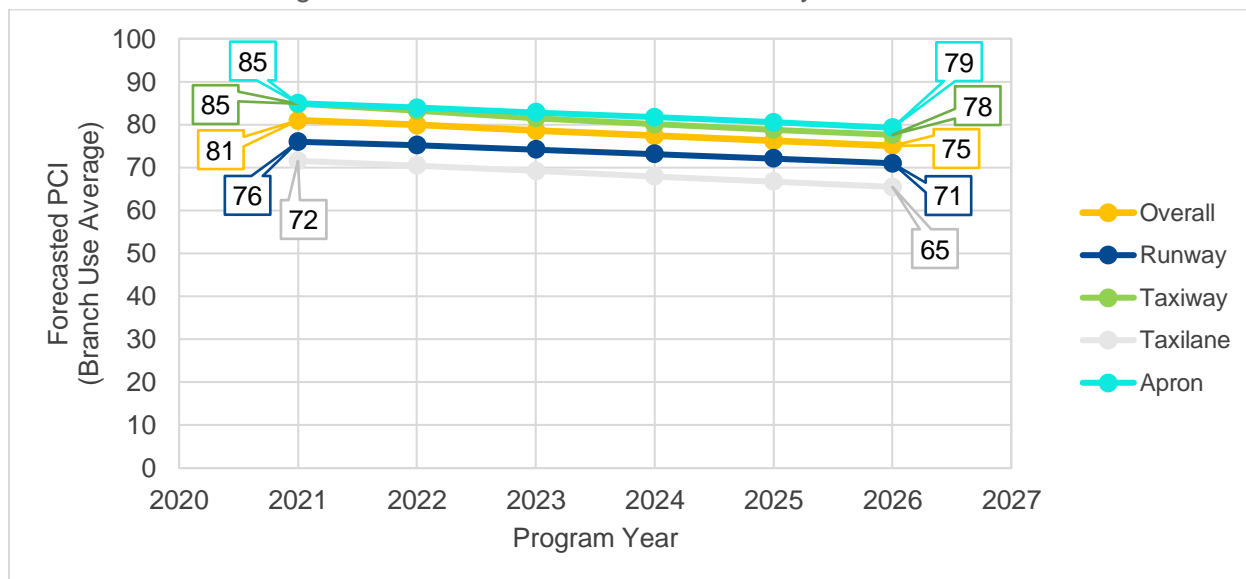

All condition forecasts are based on historical observations and analysis of South Carolina airfield pavements. The forecasts are not a guarantee of future PCI:- rather, they are a planning tool to aid in the timing of maintenance and rehabilitation activities.



STATEWIDE AIRFIELD PAVEMENT MANAGEMENT SYSTEM UPDATE

UZA – Rock Hill – York County Airport/Bryant Field

Table 3 – Forecasted (2022-2026) Pavement Condition Index Summary - Section

Network ID	Branch ID	Section ID	Current PCI	Forecasted PCI				
				2022	2023	2024	2025	2026
UZA	AP 01	10	86	85	84	83	82	81
UZA	AP 01	20	83	82	81	79	78	76
UZA	AP 01	60	86	85	84	83	82	81
UZA	AP 01	50	93	91	88	87	86	85
UZA	AP 01	30	64	63	62	61	60	59
UZA	AP 01	40	93	91	88	87	86	85
UZA	RW 2	10	76	75	74	73	72	71
UZA	TL 01	20	88	87	85	84	83	82
UZA	TL 01	10	41	40	38	37	35	34
UZA	TL 01	30	82	81	80	79	78	77
UZA	TW A	10	91	89	87	86	84	83
UZA	TW A1	10	92	90	88	86	85	84
UZA	TW A1	20	78	77	76	74	73	72
UZA	TW A2	10	89	88	86	85	84	83
UZA	TW A3	10	88	87	85	84	83	82
UZA	TW A4	10	86	85	84	83	82	81
UZA	TW A5	10	94	92	89	87	86	84
UZA	TW A6	10	87	86	85	83	82	82
UZA	TW A6	20	72	71	70	68	67	65
UZA	TW B	10	91	89	87	86	84	83
UZA	TW B	20	63	62	61	60	58	57
UZA	TW C	10	91	89	87	86	84	83
UZA	TW C	20	76	75	74	72	71	69
UZA	TW D	10	94	92	89	87	86	84
UZA	TW E	10	94	92	89	87	86	84
UZA	TW E	20	63	62	61	60	58	57
UZA	TW F	10	85	84	83	82	81	80
UZA	TW F	20	63	62	61	60	58	57
UZA	TW J	10	64	63	62	61	59	58
UZA	TW J	20	75	74	73	71	70	68

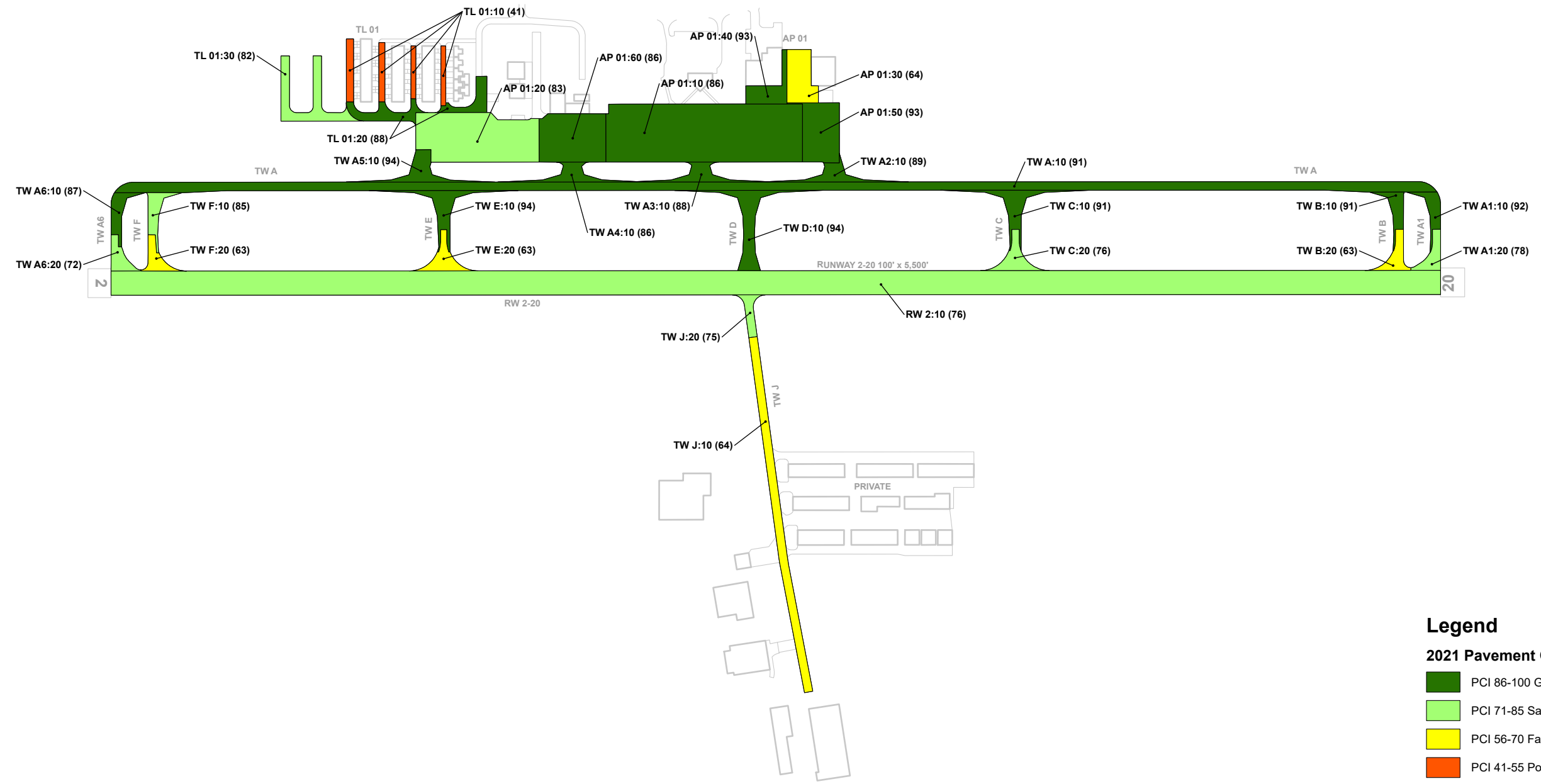

Legend

2021 Pavement Condition Index

- PCI 86-100 Good
- PCI 71-85 Satisfactory
- PCI 56-70 Fair
- PCI 41-55 Poor
- PCI 26-40 Very Poor
- PCI 11-25 Serious
- PCI 0-10 Failed

— BRANCH IDENTIFIER
— SECTION IDENTIFIER
TWA:20 (84)
— PCI

M&R Overview

An analysis was performed to assess the pavement maintenance and rehabilitation (M&R) needs at UZA over a 5-year period. The analysis compared the forecasted condition of each pavement section to Critical PCI threshold to develop a resultant recommendation and associated cost for each year of the 5-year plan. The M&R analysis should enable responsible parties to do the following:

- ➔ **Maintain** existing airport infrastructure at an acceptable condition
- ➔ Make timely and cost-effective **decisions** to appropriately allocate funding
- ➔ **Apply** global maintenance, localized maintenance, and major M&R activities in a timely manner to maintain an acceptable operational condition of a pavement network.

M&R planning considers various methods of repair to address the cause of the problem rather than just treating the symptom. As pavements deteriorate, repair costs can increase significantly. Once pavements have deteriorated below a certain condition threshold (the Critical PCI value), the pavement benefits more from substantial rehabilitation in lieu of maintenance activities. The figure below illustrates how the cost of pavement repairs can exponentially increase if M&R activities are delayed.

Figure 7 – Pavement Life and the Effect of Treatments

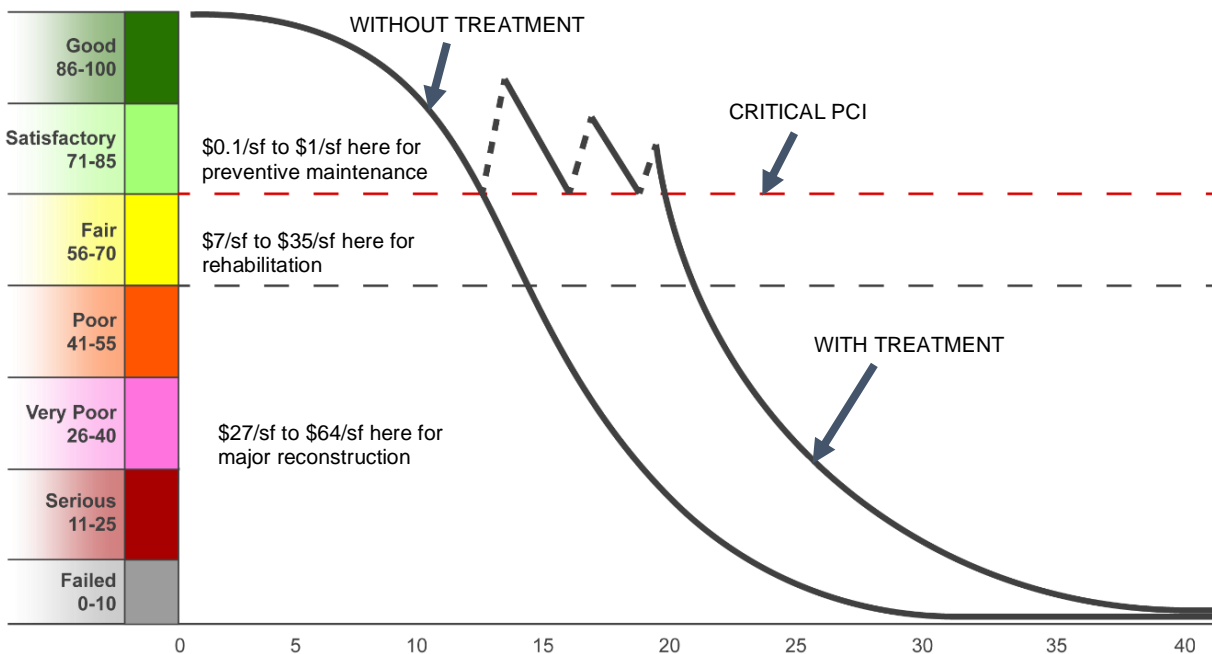

Localized Maintenance and Repair

Localized maintenance is best used as a preservation measure and is applied to slow the rate of deterioration. These activities typically include crack sealing and patching. Localized maintenance differs from major rehabilitation in that it is applied based on the distresses observed rather than based on a PCI value. Treatments are selected based on the appropriate corrective measure for a given distress type and severity level. Localized maintenance applied on pavements with PCIs above the Critical PCI of 70 is known as Preventive Localized Maintenance, while Stopgap Localized Maintenance is typically applied to pavement sections that are at or below the Critical PCI value as a temporary repair due to safety concerns. The current localized maintenance needs are summarized in the table below.

Table 4 – Localized Maintenance Summary by Policy Type

Localized Maintenance Category	Localized Work Type	Rough Estimate of Work Quantity	Work Units	Planning Material Cost
Localized Preventive Maintenance	AC Crack Sealing Narrow	51,225	LF	\$ 205,020
	Surface Seal	2,928	SF	\$ 2,660
	AC Partial-Depth Patching	47	SF	\$ 610
	AC Full-Depth Patching	114	SF	\$ 3,170
Localized Preventive Maintenance Total =				\$ 211,460
Localized Stopgap Maintenance	AC Crack Sealing Narrow	651	LF	\$ 2,630
	Surface Seal	8,536	SF	\$ 7,690
	AC Full-Depth Patching	262	SF	\$ 7,270
	PCC Crack Sealing	308	LF	\$ 2,160
	PCC Joint Seal	1,293	LF	\$ 9,050
	PCC Partial-Depth Patching	120	SF	\$ 20,250
Localized Stopgap Maintenance Total =				\$ 49,050
Total Planning-Level Localized Maintenance Needs =				\$ 260,510

Major Rehabilitation Needs

Major rehabilitation needs are identified by analyzing the Airport's pavement condition in relationship to Critical PCI values, density of load-related distresses, and major rehabilitation policies, assuming there are no budget constraints. The needs analysis is performed over a 5-year analysis period. Major rehabilitation resets the PCI value to 100 and is divided into two policy categories:

- **Intermediate Major Rehabilitation (PCI 56 to 70)** –
 - **AC:** Milling of the upper surface course and replacing with new AC with isolated areas of full-depth reconstruction
 - **PCC:** Combination of crack sealing, joint seal replacement, limited patching, and slab replacement
- **Full-Depth Reconstruction (PCI 0 to 55)** – Removal and replacement of the existing pavement section down to the subgrade

The 5-year major rehabilitation needs analysis at UZA results in a total 5-year cost of \$2.60M. The **5-Year Major Rehabilitation Needs Exhibit** graphically depicts the major rehabilitation needs at a section-level which are also summarized in **Table 5** with rounded costs. Annual needs are displayed graphically in **Figure 8**.

Table 5 – 5-Year Major Rehabilitation Needs

Program Year	Network ID	Branch ID	Section ID	Surface	Area (SF)	PCI Before	Rehabilitation Type	Planning Cost Estimate
2022	UZA	AP 01	30	AC	24,100	63	AC Rehabilitation	\$ 229,000
2022	UZA	TL 01	10	PCC	23,225	40	PCC Reconstruction	\$ 1,319,000
2022	UZA	TW B	20	AAC	9,648	62	AC Rehabilitation	\$ 92,000
2022	UZA	TW E	20	AAC	11,725	62	AC Rehabilitation	\$ 112,000
2022	UZA	TW F	20	AAC	8,574	62	AC Rehabilitation	\$ 82,000
2022	UZA	TW J	10	AAC	52,031	63	AC Rehabilitation	\$ 495,000
2023	UZA	TW A6	20	AAC	8,703	70	AC Rehabilitation	\$ 83,000
2025	UZA	TW J	20	AAC	7,300	70	AC Rehabilitation	\$ 70,000
2026	UZA	TW C	20	AAC	12,212	69	AC Rehabilitation	\$ 117,000
Total 5-Year Major Rehabilitation Needs =								\$ 2,599,000

Figure 8 – 5-Year Major Rehabilitation Needs

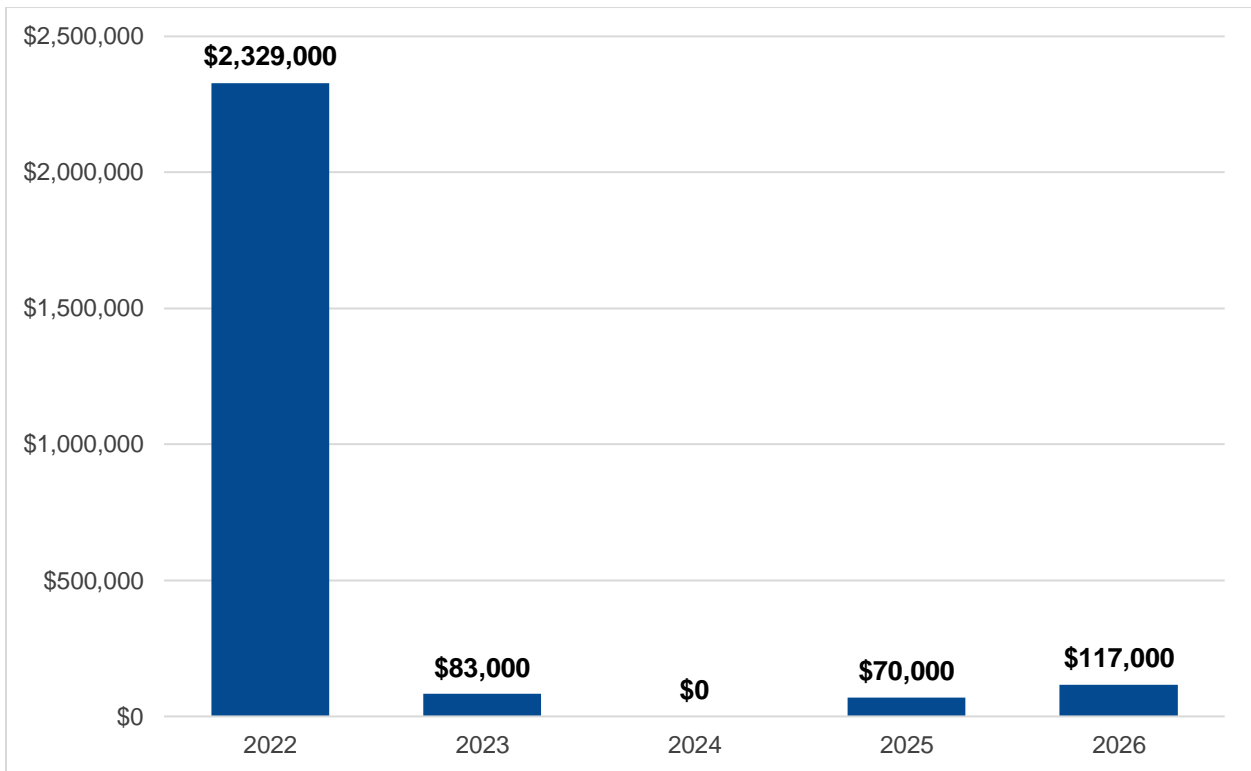

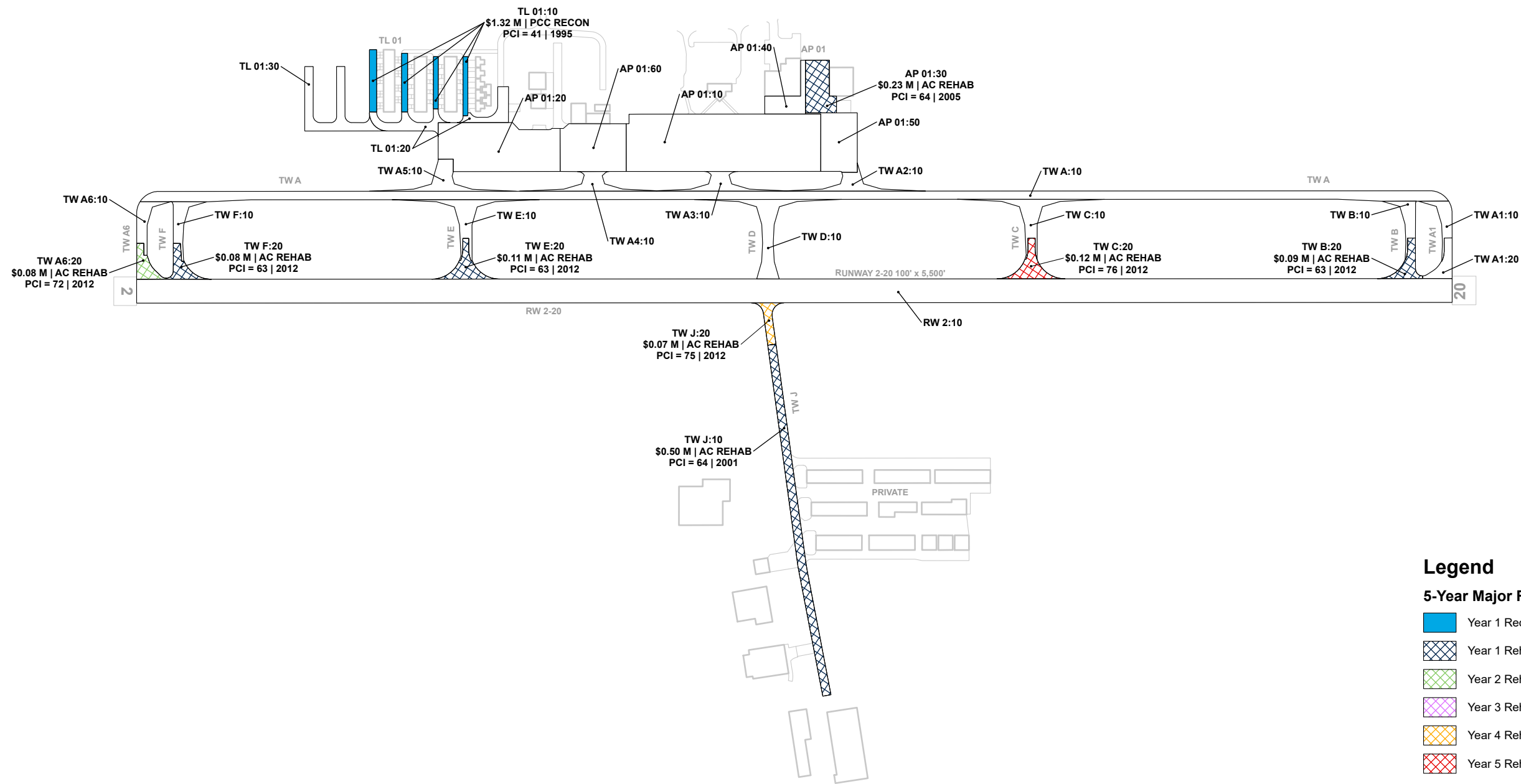

Legend

5-Year Major Rehabilitation Needs

- Year 1 Reconstruction Needs
- Year 1 Rehabilitation Needs
- Year 2 Rehabilitation Needs
- Year 3 Rehabilitation Needs
- Year 4 Rehabilitation Needs
- Year 5 Rehabilitation Needs

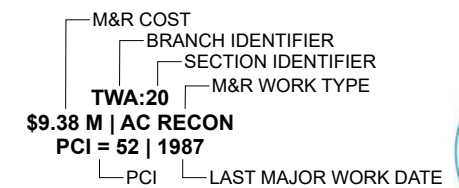

THIS EXHIBIT REPRESENTS NEEDS SOLEY BASED ON CURRENT AND FORECASTED CONDITIONS FURTHER PRIORITIZATION AND CONSIDERATIONS SHOULD BE MADE BEYOND THIS STUDY.



SECTION I

Appendices





Appendix A – Exhibits

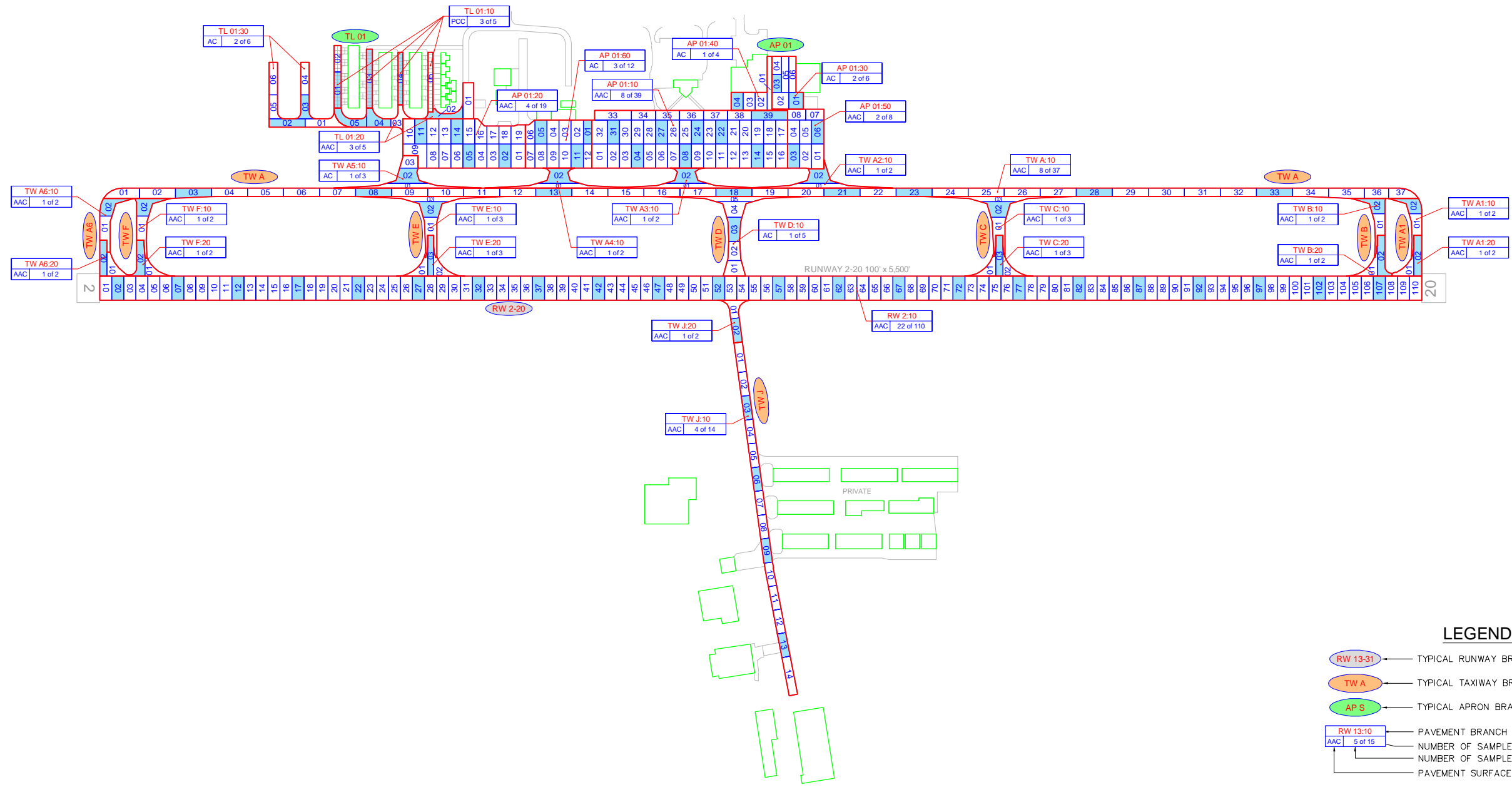

- LEGEND**
- RW 13-31 TYPICAL RUNWAY BRANCH ID
 - TW A TYPICAL TAXIWAY BRANCH ID
 - AP S TYPICAL APRON BRANCH ID
 - RW 13-10 PAVEMENT BRANCH ID: SECTION ID
 - AAC 5 of 15 NUMBER OF SAMPLE UNITS IN SECTION
 - AAC 1 of 2 NUMBER OF SAMPLE UNITS TO BE INSPECTED
 - PCC PAVEMENT SURFACE TYPE
 - RW 13-20 SECTION NOT INSPECTED DUE TO RECENT CONSTRUCTION. SEE ESTIMATED AGE EXHIBIT FOR CONSTRUCTION DATES.
 - AAC 0 of 5
 - 100 INSPECTED SAMPLE UNITS.

TOTAL SAMPLES INSPECTED = 81
AC: 78 PCC: 3

RUNWAY LENGTHS DEPICTED IN THIS DRAWING ARE FOR PAVEMENT MANAGEMENT PURPOSES ONLY AND MAY NOT MATCH PUBLISHED RUNWAY LENGTHS. DRAWING NOT TO SCALE.

STATEWIDE AIRFIELD PAVEMENT MANAGEMENT SYSTEM UPDATE

ROCK HILL - YORK COUNTY AIRPORT/BRYANT FIELD (UZA)



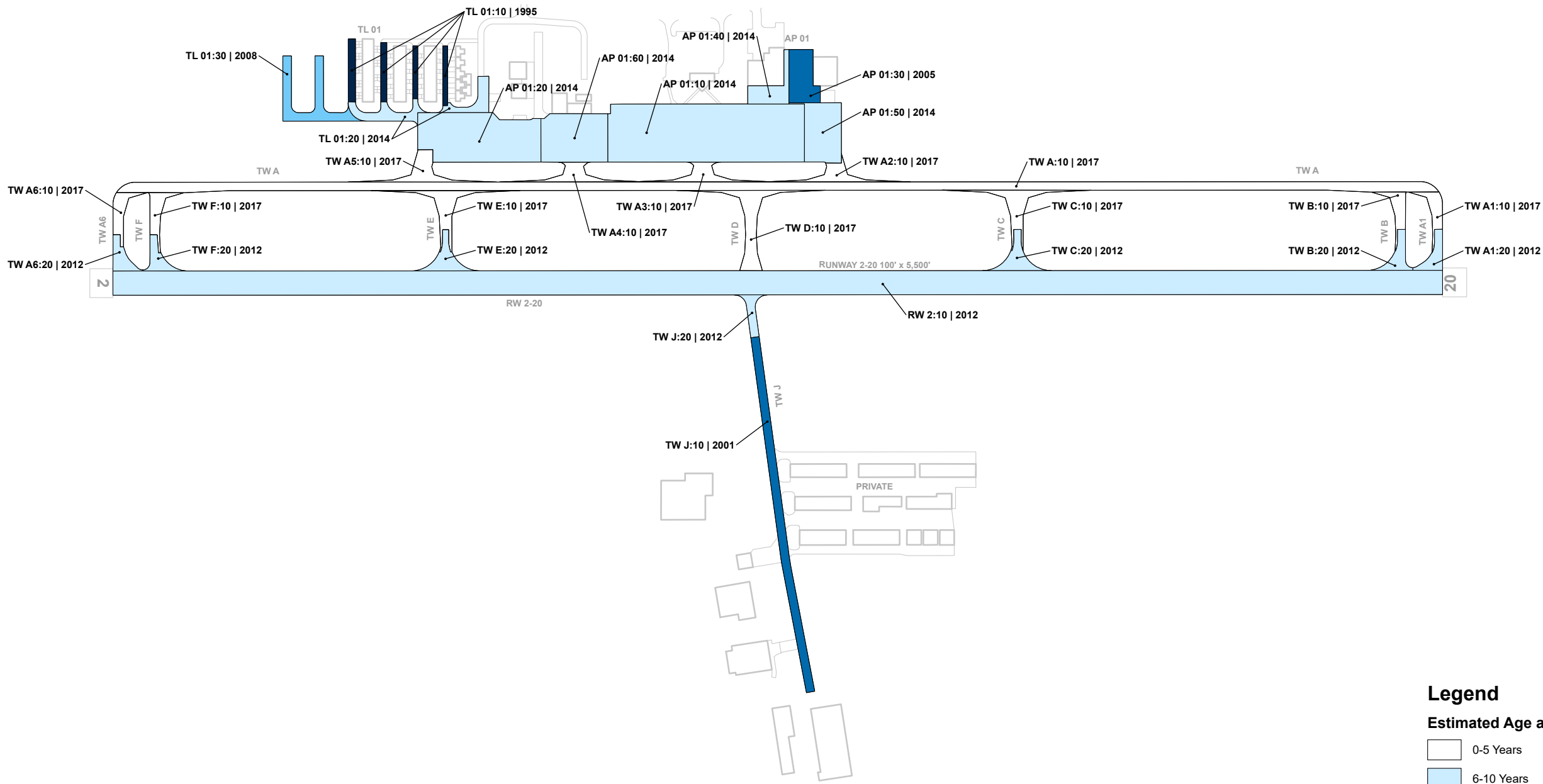

AIRFIELD PAVEMENT NETWORK DEFINITION EXHIBIT







Legend

Estimated Age at Inspection

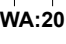
-  0-5 Years
-  6-10 Years
-  11-15 Years
-  16-20 Years
-  > 20 Years

-  BRANCH IDENTIFIER
-  SECTION IDENTIFIER
-  LAST MAJOR WORK DATE

TWA:20 | 1985



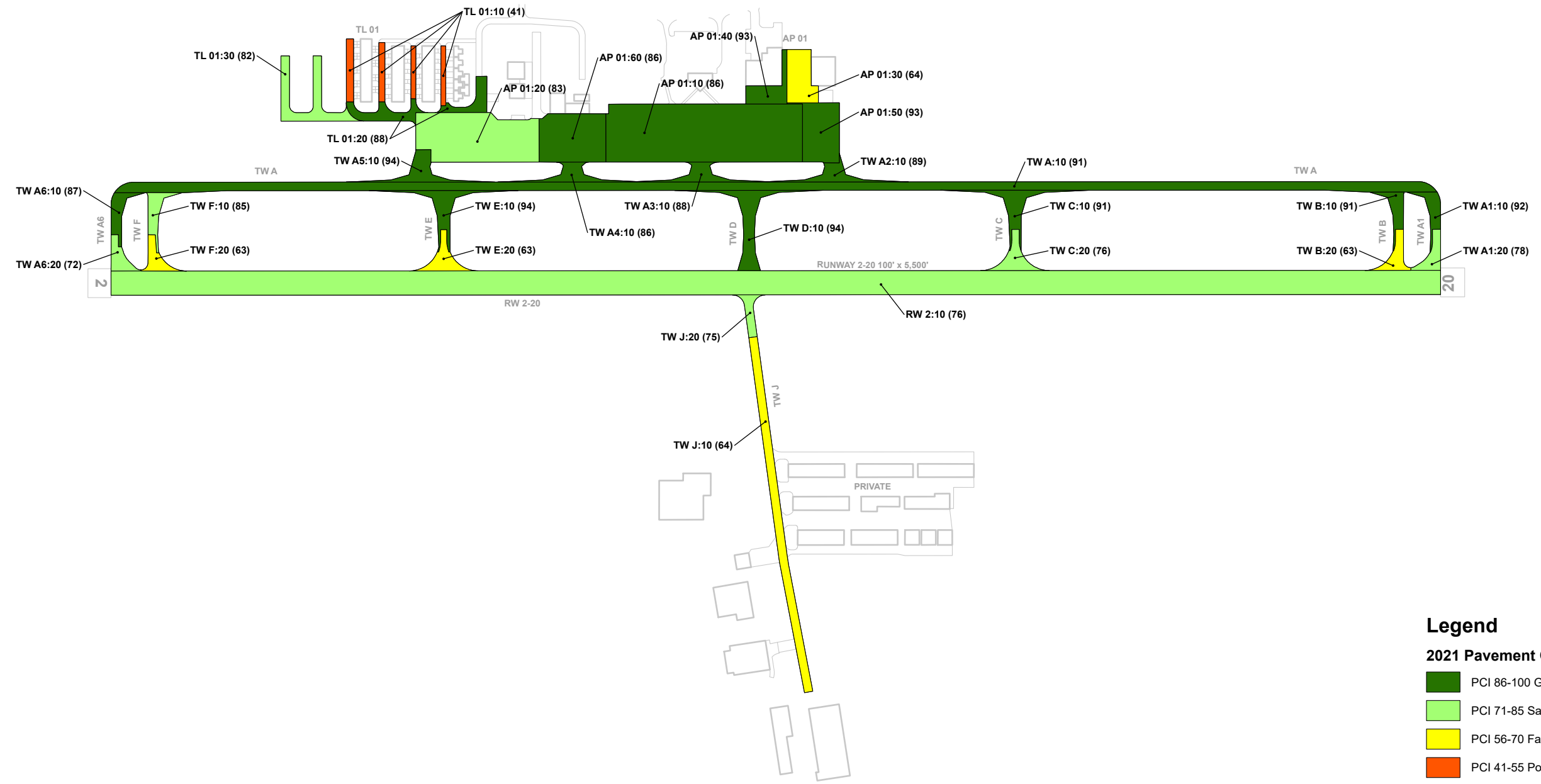

Legend

2021 Pavement Condition Index

- PCI 86-100 Good
- PCI 71-85 Satisfactory
- PCI 56-70 Fair
- PCI 41-55 Poor
- PCI 26-40 Very Poor
- PCI 11-25 Serious
- PCI 0-10 Failed

— BRANCH IDENTIFIER
— SECTION IDENTIFIER
TWA:20 (84)
— PCI

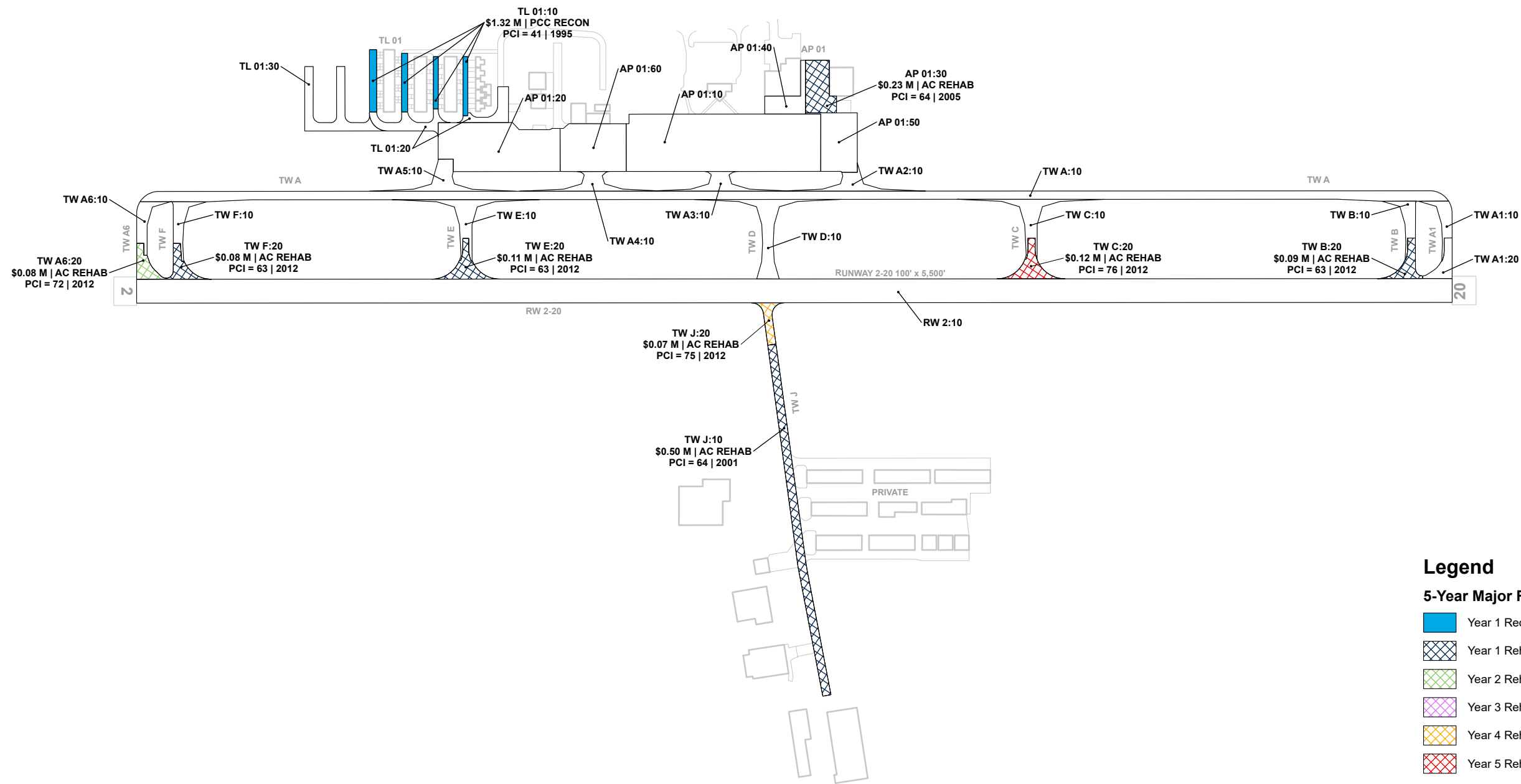

Legend

5-Year Major Rehabilitation Needs

- Year 1 Reconstruction Needs
- Year 1 Rehabilitation Needs
- Year 2 Rehabilitation Needs
- Year 3 Rehabilitation Needs
- Year 4 Rehabilitation Needs
- Year 5 Rehabilitation Needs

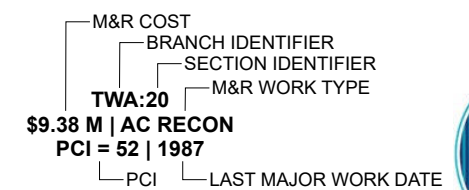

THIS EXHIBIT REPRESENTS NEEDS SOLEY BASED ON CURRENT AND FORECASTED CONDITIONS FURTHER PRIORITIZATION AND CONSIDERATIONS SHOULD BE MADE BEYOND THIS STUDY.





Appendix B – Analysis Tables



UZA – Rock Hill – York County Airport/Bryant Field

Table B1 – System Inventory Data - Section

Network ID	Branch ID	Branch Use	Section ID	Area (SF)	Surface Type	Estimate of Last Construction Date
UZA	AP 01	Apron	10	194,880	AAC	10/29/2014
UZA	AP 01	Apron	20	95,917	AAC	10/29/2014
UZA	AP 01	Apron	60	54,695	AC	10/29/2014
UZA	AP 01	Apron	50	38,073	AAC	10/29/2014
UZA	AP 01	Apron	30	24,100	AC	1/1/2005
UZA	AP 01	Apron	40	15,750	AC	10/29/2014
UZA	RW 2	Runway	10	550,200	AAC	10/23/2012
UZA	TL 01	Taxilane	20	25,506	AAC	10/29/2014
UZA	TL 01	Taxilane	10	23,225	PCC	6/1/1995
UZA	TL 01	Taxilane	30	27,780	AC	1/1/2008
UZA	TW A	Taxiway	10	195,846	AAC	11/1/2017
UZA	TW A1	Taxiway	10	9,224	AAC	11/1/2017
UZA	TW A1	Taxiway	20	9,180	AAC	10/23/2012
UZA	TW A2	Taxiway	10	11,626	AAC	11/1/2017
UZA	TW A3	Taxiway	10	11,934	AAC	11/1/2017
UZA	TW A4	Taxiway	10	11,970	AAC	11/1/2017
UZA	TW A5	Taxiway	10	15,305	AC	11/1/2017
UZA	TW A6	Taxiway	10	10,190	AAC	11/1/2017
UZA	TW A6	Taxiway	20	8,703	AAC	10/23/2012
UZA	TW B	Taxiway	10	9,398	AAC	11/1/2017
UZA	TW B	Taxiway	20	9,648	AAC	10/23/2012
UZA	TW C	Taxiway	10	17,228	AAC	11/1/2017
UZA	TW C	Taxiway	20	12,212	AAC	10/23/2012
UZA	TW D	Taxiway	10	25,798	AC	11/1/2017
UZA	TW E	Taxiway	10	17,715	AAC	11/1/2017
UZA	TW E	Taxiway	20	11,725	AAC	10/23/2012
UZA	TW F	Taxiway	10	10,312	AAC	11/1/2017
UZA	TW F	Taxiway	20	8,574	AAC	10/23/2012
UZA	TW J	Taxiway	10	52,031	AAC	11/15/2001
UZA	TW J	Taxiway	20	7,300	AAC	10/23/2012



UZA – Rock Hill – York County Airport/Bryant Field

Table B2 – Current Pavement Condition Index Summary - Branch

Branch ID	Branch Use	Number of Sections	Branch Area (SF)	Area-Weighted Avg PCI	Condition Rating
AP 01	Apron	6	423,415	85	Satisfactory
RW 2	Runway	1	550,200	76	Satisfactory
TL 01	Taxilane	3	76,511	72	Satisfactory
TW A	Taxiway	1	195,846	91	Good
TW A1	Taxiway	2	18,404	85	Satisfactory
TW A2	Taxiway	1	11,626	89	Good
TW A3	Taxiway	1	11,934	88	Good
TW A4	Taxiway	1	11,970	86	Good
TW A5	Taxiway	1	15,305	94	Good
TW A6	Taxiway	2	18,893	80	Satisfactory
TW B	Taxiway	2	19,046	77	Satisfactory
TW C	Taxiway	2	29,440	85	Satisfactory
TW D	Taxiway	1	25,798	94	Good
TW E	Taxiway	2	29,440	82	Satisfactory
TW F	Taxiway	2	18,886	75	Satisfactory
TW J	Taxiway	2	59,331	65	Fair



STATEWIDE AIRFIELD PAVEMENT MANAGEMENT SYSTEM UPDATE

UZA – Rock Hill – York County Airport/Bryant Field

Table B3 – Current (2021) Pavement Condition Index Summary - Section

Network ID	Branch ID	Branch Use	Section ID	Area (SF)	Surface	PCI	Condition Rating	PCI % Climate	PCI % Load	PCI % Other	Sample Units Inspected	Total Sample Units in Section
UZA	AP 01	Apron	10	194,880	AAC	86	Good	100	0	0	8	39
UZA	AP 01	Apron	20	95,917	AAC	83	Satisfactory	100	0	0	4	19
UZA	AP 01	Apron	60	54,695	AC	86	Good	100	0	0	3	12
UZA	AP 01	Apron	50	38,073	AAC	93	Good	100	0	0	2	8
UZA	AP 01	Apron	30	24,100	AC	64	Fair	42	58	0	2	6
UZA	AP 01	Apron	40	15,750	AC	93	Good	91	0	9	1	4
UZA	RW 2	Runway	10	550,200	AAC	76	Satisfactory	84	0	16	22	110
UZA	TL 01	Taxilane	20	25,506	AAC	88	Good	100	0	0	3	5
UZA	TL 01	Taxilane	10	23,225	PCC	41	Poor	13	67	20	3	5
UZA	TL 01	Taxilane	30	27,780	AC	82	Satisfactory	100	0	0	2	6
UZA	TW A	Taxiway	10	195,846	AAC	91	Good	100	0	0	8	37
UZA	TW A1	Taxiway	10	9,224	AAC	92	Good	100	0	0	1	2
UZA	TW A1	Taxiway	20	9,180	AAC	78	Satisfactory	100	0	0	1	2
UZA	TW A2	Taxiway	10	11,626	AAC	89	Good	100	0	0	1	2
UZA	TW A3	Taxiway	10	11,934	AAC	88	Good	100	0	0	1	2
UZA	TW A4	Taxiway	10	11,970	AAC	86	Good	100	0	0	1	2
UZA	TW A5	Taxiway	10	15,305	AC	94	Good	100	0	0	1	3
UZA	TW A6	Taxiway	10	10,190	AAC	87	Good	100	0	0	1	2
UZA	TW A6	Taxiway	20	8,703	AAC	72	Satisfactory	100	0	0	1	2
UZA	TW B	Taxiway	10	9,398	AAC	91	Good	100	0	0	1	2
UZA	TW B	Taxiway	20	9,648	AAC	63	Fair	100	0	0	1	2
UZA	TW C	Taxiway	10	17,228	AAC	91	Good	100	0	0	1	3
UZA	TW C	Taxiway	20	12,212	AAC	76	Satisfactory	100	0	0	1	3
UZA	TW D	Taxiway	10	25,798	AC	94	Good	100	0	0	1	5
UZA	TW E	Taxiway	10	17,715	AAC	94	Good	100	0	0	1	3
UZA	TW E	Taxiway	20	11,725	AAC	63	Fair	100	0	0	1	3
UZA	TW F	Taxiway	10	10,312	AAC	85	Satisfactory	94	0	6	1	2
UZA	TW F	Taxiway	20	8,574	AAC	63	Fair	100	0	0	1	2
UZA	TW J	Taxiway	10	52,031	AAC	64	Fair	100	0	0	4	14
UZA	TW J	Taxiway	20	7,300	AAC	75	Satisfactory	100	0	0	1	2



STATEWIDE AIRFIELD PAVEMENT MANAGEMENT SYSTEM UPDATE

UZA – Rock Hill – York County Airport/Bryant Field

Table B4 –Forecasted (2022-2026) Pavement Condition Index Summary - Section

Network ID	Branch ID	Section ID	Current PCI	Forecasted PCI				
				2022	2023	2024	2025	2026
UZA	AP 01	10	86	85	84	83	82	81
UZA	AP 01	20	83	82	81	79	78	76
UZA	AP 01	60	86	85	84	83	82	81
UZA	AP 01	50	93	91	88	87	86	85
UZA	AP 01	30	64	63	62	61	60	59
UZA	AP 01	40	93	91	88	87	86	85
UZA	RW 2	10	76	75	74	73	72	71
UZA	TL 01	20	88	87	85	84	83	82
UZA	TL 01	10	41	40	38	37	35	34
UZA	TL 01	30	82	81	80	79	78	77
UZA	TW A	10	91	89	87	86	84	83
UZA	TW A1	10	92	90	88	86	85	84
UZA	TW A1	20	78	77	76	74	73	72
UZA	TW A2	10	89	88	86	85	84	83
UZA	TW A3	10	88	87	85	84	83	82
UZA	TW A4	10	86	85	84	83	82	81
UZA	TW A5	10	94	92	89	87	86	84
UZA	TW A6	10	87	86	85	83	82	82
UZA	TW A6	20	72	71	70	68	67	65
UZA	TW B	10	91	89	87	86	84	83
UZA	TW B	20	63	62	61	60	58	57
UZA	TW C	10	91	89	87	86	84	83
UZA	TW C	20	76	75	74	72	71	69
UZA	TW D	10	94	92	89	87	86	84
UZA	TW E	10	94	92	89	87	86	84
UZA	TW E	20	63	62	61	60	58	57
UZA	TW F	10	85	84	83	82	81	80
UZA	TW F	20	63	62	61	60	58	57
UZA	TW J	10	64	63	62	61	59	58
UZA	TW J	20	75	74	73	71	70	68



Appendix C – Maintenance and Rehabilitation Tables



STATEWIDE AIRFIELD PAVEMENT MANAGEMENT SYSTEM UPDATE

UZA – Rock Hill – York County Airport/Bryant Field

Table C1–Localized Maintenance Summary by Policy Type

Localized Maintenance Category	Localized Work Type	Rough Estimate of Work Quantity	Work Units	Planning Material Cost
Localized Preventive Maintenance	AC Crack Sealing Narrow	51,225	LF	\$ 205,020
	Surface Seal	2,928	SF	\$ 2,660
	AC Partial-Depth Patching	47	SF	\$ 610
	AC Full-Depth Patching	114	SF	\$ 3,170
Localized Preventive Maintenance Total =				\$ 211,460
Localized Stopgap Maintenance	AC Crack Sealing Narrow	651	LF	\$ 2,630
	Surface Seal	8,536	SF	\$ 7,690
	AC Full-Depth Patching	262	SF	\$ 7,270
	PCC Crack Sealing	308	LF	\$ 2,160
	PCC Joint Seal	1,293	LF	\$ 9,050
	PCC Partial-Depth Patching	120	SF	\$ 20,250
Localized Stopgap Maintenance Total =				\$ 49,050
Total Planning-Level Localized Maintenance Needs =				\$ 260,510

Table C2 – Section – Level Year 1 Localized Maintenance Planning Cost Summary

Network ID	Branch ID	Section ID	Area (SF)	Start PCI	End PCI	Cost
UZA	AP 01	10	194,880	86	86	\$ 19,000
UZA	AP 01	20	95,917	83	83	\$ 15,000
UZA	AP 01	60	54,695	86	86	\$ 5,100
UZA	AP 01	50	38,073	93	93	\$ 90
UZA	AP 01	30	24,100	64	71	\$ 14,950
UZA	AP 01	40	15,750	93	92	\$ 320
UZA	RW 2	10	550,200	76	77	\$ 143,950
UZA	TL 01	20	25,506	88	88	\$ 1,630
UZA	TL 01	10	23,225	41	62	\$ 31,460
UZA	TL 01	30	27,780	82	82	\$ 4,020
UZA	TW A	10	195,846	91	91	\$ 6,340
UZA	TW A1	10	9,224	92	92	\$ 20
UZA	TW A1	20	9,180	78	78	\$ 2,170
UZA	TW A2	10	11,626	89	89	\$ 450
UZA	TW A3	10	11,934	88	88	\$ 860
UZA	TW A4	10	11,970	86	86	\$ 1,160
UZA	TW A5	10	15,305	94	94	\$ -
UZA	TW A6	10	10,190	87	87	\$ 860
UZA	TW A6	20	8,703	72	72	\$ 3,470
UZA	TW B	10	9,398	91	91	\$ 80
UZA	TW B	20	9,648	63	68	\$ 120
UZA	TW C	10	17,228	91	91	\$ 140
UZA	TW C	20	12,212	76	76	\$ 3,450
UZA	TW D	10	25,798	94	94	\$ -
UZA	TW E	10	17,715	94	94	\$ -
UZA	TW E	20	11,725	63	67	\$ 270



 **UZA – Rock Hill – York County Airport/Bryant Field**

Network ID	Branch ID	Section ID	Area (SF)	Start PCI	End PCI	Cost
UZA	TW F	10	10,312	85	85	\$ 1,030
UZA	TW F	20	8,574	63	67	\$ 150
UZA	TW J	10	52,031	64	69	\$ 2,090
UZA	TW J	20	7,300	75	75	\$ 2,270



STATEWIDE AIRFIELD PAVEMENT MANAGEMENT SYSTEM UPDATE

UZA – Rock Hill – York County Airport/Bryant Field

Table C3 – Localized Maintenance and Repair Needs Based on Current Distresses

Network ID	Branch ID	Section ID	Description	Severity	Distress Qty	Distress Unit	Distress Density	Policy Type	Localized Work Type	Work Qty	Work Unit	Unit Cost	Work Cost
UZA	AP 01	10	L & T CR	Low	4,748	LF	2.4%	Preventive	AC Crack Sealing Narrow	4,748	LF	\$ 4.00	\$ 19,000
UZA	AP 01	20	L & T CR	Low	3,748	LF	3.9%	Preventive	AC Crack Sealing Narrow	3,748	LF	\$ 4.00	\$ 15,000
UZA	AP 01	60	L & T CR	Low	1,251	LF	2.3%	Preventive	AC Crack Sealing Narrow	1,251	LF	\$ 4.00	\$ 5,010
UZA	AP 01	60	PATCHING	Low	64	SF	0.1%	Preventive	Surface Seal	100	SF	\$ 0.90	\$ 100
UZA	AP 01	50	L & T CR	Low	22	LF	0.1%	Preventive	AC Crack Sealing Narrow	22	LF	\$ 4.00	\$ 90
UZA	AP 01	40	BLEEDING	N/A	25	SF	0.2%	Preventive	AC Partial-Depth Patching	25	SF	\$ 12.50	\$ 320
UZA	RW 2	10	L & T CR	Low	34,207	LF	6.2%	Preventive	AC Crack Sealing Narrow	34,207	LF	\$ 4.00	\$ 136,840
UZA	RW 2	10	L & T CR	Medium	665	LF	0.1%	Preventive	AC Crack Sealing Narrow	665	LF	\$ 4.00	\$ 2,670
UZA	RW 2	10	PATCHING	Low	30	SF	0.0%	Preventive	Surface Seal	56	SF	\$ 0.90	\$ 60
UZA	RW 2	10	RAVELING	Low	1,386	SF	0.3%	Preventive	Surface Seal	1,385	SF	\$ 0.90	\$ 1,250
UZA	RW 2	10	SLIPPAGE CR	N/A	75	SF	0.0%	Preventive	AC Full-Depth Patching	114	SF	\$ 27.75	\$ 3,170
UZA	TL 01	20	L & T CR	Low	405	LF	1.6%	Preventive	AC Crack Sealing Narrow	405	LF	\$ 4.00	\$ 1,630
UZA	TL 01	30	L & T CR	Low	692	LF	2.5%	Preventive	AC Crack Sealing Narrow	692	LF	\$ 4.00	\$ 2,770
UZA	TL 01	30	WEATHERING	Medium	1,386	SF	5.0%	Preventive	Surface Seal	1,386	SF	\$ 0.90	\$ 1,250
UZA	TW A	10	BLEEDING	N/A	23	SF	0.0%	Preventive	AC Partial-Depth Patching	23	SF	\$ 12.50	\$ 290
UZA	TW A	10	L & T CR	Low	1,512	LF	0.8%	Preventive	AC Crack Sealing Narrow	1,512	LF	\$ 4.00	\$ 6,050
UZA	TW A1	10	L & T CR	Low	4	LF	0.0%	Preventive	AC Crack Sealing Narrow	4	LF	\$ 4.00	\$ 20
UZA	TW A1	20	L & T CR	Low	540	LF	5.9%	Preventive	AC Crack Sealing Narrow	540	LF	\$ 4.00	\$ 2,170
UZA	TW A2	10	L & T CR	Low	112	LF	1.0%	Preventive	AC Crack Sealing Narrow	112	LF	\$ 4.00	\$ 450
UZA	TW A3	10	L & T CR	Low	214	LF	1.8%	Preventive	AC Crack Sealing Narrow	214	LF	\$ 4.00	\$ 860
UZA	TW A4	10	L & T CR	Low	289	LF	2.4%	Preventive	AC Crack Sealing Narrow	289	LF	\$ 4.00	\$ 1,160
UZA	TW A6	10	L & T CR	Low	214	LF	2.1%	Preventive	AC Crack Sealing Narrow	214	LF	\$ 4.00	\$ 860
UZA	TW A6	20	L & T CR	Low	866	LF	10.0%	Preventive	AC Crack Sealing Narrow	867	LF	\$ 4.00	\$ 3,470
UZA	TW B	10	L & T CR	Low	18	LF	0.2%	Preventive	AC Crack Sealing Narrow	18	LF	\$ 4.00	\$ 80
UZA	TW C	10	L & T CR	Low	34	LF	0.2%	Preventive	AC Crack Sealing Narrow	35	LF	\$ 4.00	\$ 140
UZA	TW C	20	L & T CR	Low	862	LF	7.1%	Preventive	AC Crack Sealing Narrow	862	LF	\$ 4.00	\$ 3,450
UZA	TW F	10	L & T CR	Low	256	LF	2.5%	Preventive	AC Crack Sealing Narrow	256	LF	\$ 4.00	\$ 1,030
UZA	TW J	20	L & T CR	Low	565	LF	7.7%	Preventive	AC Crack Sealing Narrow	565	LF	\$ 4.00	\$ 2,270
UZA	AP 01	30	ALLIGATOR CR	Medium	201	SF	0.8%	Stopgap	AC Full-Depth Patching	262	SF	\$ 27.75	\$ 7,270
UZA	AP 01	30	WEATHERING	Medium	8,535	SF	35.4%	Stopgap	Surface Seal	8,536	SF	\$ 0.90	\$ 7,690
UZA	TL 01	10	LINEAR CR	Medium	24	Slabs	17.3%	Stopgap	PCC Crack Sealing	308	LF	\$ 7.00	\$ 2,160
UZA	TL 01	10	JT SEAL DMG	High	137	Slabs	100.0%	Stopgap	PCC Joint Seal	1,293	LF	\$ 7.00	\$ 9,050
UZA	TL 01	10	JOINT SPALL	Medium	18	Slabs	13.5%	Stopgap	PCC Partial-Depth Patching	120	SF	\$ 170.00	\$ 20,250



STATEWIDE AIRFIELD PAVEMENT MANAGEMENT SYSTEM UPDATE

UZA – Rock Hill – York County Airport/Bryant Field

Network ID	Branch ID	Section ID	Description	Severity	Distress Qty	Distress Unit	Distress Density	Policy Type	Localized Work Type	Work Qty	Work Unit	Unit Cost	Work Cost
UZA	TW B	20	L & T CR	Medium	28	LF	0.3%	Stopgap	AC Crack Sealing Narrow	28	LF	\$ 4.00	\$ 120
UZA	TW E	20	L & T CR	Medium	66	LF	0.6%	Stopgap	AC Crack Sealing Narrow	66	LF	\$ 4.00	\$ 270
UZA	TW F	20	L & T CR	Medium	37	LF	0.4%	Stopgap	AC Crack Sealing Narrow	36	LF	\$ 4.00	\$ 150
UZA	TW J	10	L & T CR	Medium	520	LF	1.0%	Stopgap	AC Crack Sealing Narrow	520	LF	\$ 4.00	\$ 2,090

Table C4 – 5-Year Major Rehabilitation Needs

Program Year	Network ID	Branch ID	Section ID	Surface	Area (SF)	PCI Before	Rehabilitation Type	Planning Cost Estimate
2022	UZA	AP 01	30	AC	24,100	63	AC Rehabilitation	\$ 229,000
2022	UZA	TL 01	10	PCC	23,225	40	PCC Reconstruction	\$ 1,319,000
2022	UZA	TW B	20	AAC	9,648	62	AC Rehabilitation	\$ 92,000
2022	UZA	TW E	20	AAC	11,725	62	AC Rehabilitation	\$ 112,000
2022	UZA	TW F	20	AAC	8,574	62	AC Rehabilitation	\$ 82,000
2022	UZA	TW J	10	AAC	52,031	63	AC Rehabilitation	\$ 495,000
2023	UZA	TW A6	20	AAC	8,703	70	AC Rehabilitation	\$ 83,000
2025	UZA	TW J	20	AAC	7,300	70	AC Rehabilitation	\$ 70,000
2026	UZA	TW C	20	AAC	12,212	69	AC Rehabilitation	\$ 117,000
Total 5-Year Major Rehabilitation Needs =								\$ 2,599,000



Appendix D – Detailed PCI Results

AP 01

Branch ID	Branch Use	Number of Sections	Branch Area (SF)	Branch Area-Weighted Avg PCI	Branch Condition Rating
AP 01	APRON	6	423,415	85	Satisfactory

Section ID	Area (SF)	Surface	Est. Last Major Work Year	Est. Last Global Treatment Year	PCI	Condition Rating	PCI % Climate	PCI % Load	PCI % Other
10	194,880	AAC	2014	2014	86	Good	100	0	0
20	95,917	AAC	2014	2014	83	Satisfactory	100	0	0
30	24,100	AC	2005	-	64	Fair	42	58	0
40	15,750	AC	2014	-	93	Good	91	0	9
50	38,073	AAC	2014	2014	93	Good	100	0	0
60	54,695	AC	2014	2014	86	Good	100	0	0



AP 01-10



AP 01-30



AP 01-40



AP 01-50

RW 2

Branch ID	Branch Use	Number of Sections	Branch Area (SF)	Branch Area-Weighted Avg PCI	Branch Condition Rating
RW 2	RUNWAY	1	550,200	76	Satisfactory

Section ID	Area (SF)	Surface	Est. Last Major Work Year	Est. Last Global Treatment Year	PCI	Condition Rating	PCI % Climate	PCI % Load	PCI % Other
10	550,200	AAC	2012	-	76	Satisfactory	84	0	16



RW 2-10



RW 2-10



RW 2-10



RW 2-10

UZA – Rock Hill – York County Airport/Bryant Field

TW A

Branch ID	Branch Use	Number of Sections	Branch Area (SF)	Branch Area-Weighted Avg PCI	Branch Condition Rating
TW A	TAXIWAY	1	195,846	91	Good

Section ID	Area (SF)	Surface	Est. Last Major Work Year	Est. Last Global Treatment Year	PCI	Condition Rating	PCI % Climate	PCI % Load	PCI % Other
10	195,846	AAC	2017	-	91	Good	100	0	0



TW A-10



TW A-10

TW A1

Branch ID	Branch Use	Number of Sections	Branch Area (SF)	Branch Area-Weighted Avg PCI	Branch Condition Rating
TW A1	TAXIWAY	2	18,404	85	Satisfactory

Section ID	Area (SF)	Surface	Est. Last Major Work Year	Est. Last Global Treatment Year	PCI	Condition Rating	PCI % Climate	PCI % Load	PCI % Other
10	9,224	AAC	2017	-	92	Good	100	0	0
20	9,180	AAC	2012	-	78	Satisfactory	100	0	0



TW A1-10



TW A1-20

UZA – Rock Hill – York County Airport/Bryant Field

TW A2

Branch ID	Branch Use	Number of Sections	Branch Area (SF)	Branch Area-Weighted Avg PCI	Branch Condition Rating
TW A2	TAXIWAY	1	11,626	89	Good

Section ID	Area (SF)	Surface	Est. Last Major Work Year	Est. Last Global Treatment Year	PCI	Condition Rating	PCI % Climate	PCI % Load	PCI % Other
10	11,626	AAC	2017	-	89	Good	100	0	0



TW A2-10



TW A2-10

TW A3

Branch ID	Branch Use	Number of Sections	Branch Area (SF)	Branch Area-Weighted Avg PCI	Branch Condition Rating
TW A3	TAXIWAY	1	11,934	88	Good

Section ID	Area (SF)	Surface	Est. Last Major Work Year	Est. Last Global Treatment Year	PCI	Condition Rating	PCI % Climate	PCI % Load	PCI % Other
10	11,934	AAC	2017	-	88	Good	100	0	0



TW A3-10



TW A3-10

UZA – Rock Hill – York County Airport/Bryant Field

TW A4

Branch ID	Branch Use	Number of Sections	Branch Area (SF)	Branch Area-Weighted Avg PCI	Branch Condition Rating
TW A4	TAXIWAY	1	11,970	86	Good

Section ID	Area (SF)	Surface	Est. Last Major Work Year	Est. Last Global Treatment Year	PCI	Condition Rating	PCI % Climate	PCI % Load	PCI % Other
10	11,970	AAC	2017	-	86	Good	100	0	0



TW A4-10



TW A4-10

TW A5

Branch ID	Branch Use	Number of Sections	Branch Area (SF)	Branch Area-Weighted Avg PCI	Branch Condition Rating
TW A5	TAXIWAY	1	15,305	94	Good

Section ID	Area (SF)	Surface	Est. Last Major Work Year	Est. Last Global Treatment Year	PCI	Condition Rating	PCI % Climate	PCI % Load	PCI % Other
10	15,305	AC	2017	-	94	Good	100	0	0



TW A5-10



TW A5-10

TW A6

Branch ID	Branch Use	Number of Sections	Branch Area (SF)	Branch Area-Weighted Avg PCI	Branch Condition Rating
TW A6	TAXIWAY	2	18,893	80	Satisfactory

Section ID	Area (SF)	Surface	Est. Last Major Work Year	Est. Last Global Treatment Year	PCI	Condition Rating	PCI % Climate	PCI % Load	PCI % Other
10	10,190	AAC	2017	-	87	Good	100	0	0
20	8,703	AAC	2012	-	72	Satisfactory	100	0	0



TW A6-20



TW A6-20

TW B

Branch ID	Branch Use	Number of Sections	Branch Area (SF)	Branch Area-Weighted Avg PCI	Branch Condition Rating
TW B	TAXIWAY	2	19,046	77	Satisfactory

Section ID	Area (SF)	Surface	Est. Last Major Work Year	Est. Last Global Treatment Year	PCI	Condition Rating	PCI % Climate	PCI % Load	PCI % Other
10	9,398	AAC	2017	-	91	Good	100	0	0
20	9,648	AAC	2012	-	63	Fair	100	0	0



TW B-10



TW B-20

UZA – Rock Hill – York County Airport/Bryant Field

TW C

Branch ID	Branch Use	Number of Sections	Branch Area (SF)	Branch Area-Weighted Avg PCI	Branch Condition Rating
TW C	TAXIWAY	2	29,440	85	Satisfactory

Section ID	Area (SF)	Surface	Est. Last Major Work Year	Est. Last Global Treatment Year	PCI	Condition Rating	PCI % Climate	PCI % Load	PCI % Other
10	17,228	AAC	2017	-	91	Good	100	0	0
20	12,212	AAC	2012	-	76	Satisfactory	100	0	0



TW C-10



TW C-20

TW D

Branch ID	Branch Use	Number of Sections	Branch Area (SF)	Branch Area-Weighted Avg PCI	Branch Condition Rating
TW D	TAXIWAY	1	25,798	94	Good

Section ID	Area (SF)	Surface	Est. Last Major Work Year	Est. Last Global Treatment Year	PCI	Condition Rating	PCI % Climate	PCI % Load	PCI % Other
10	25,798	AC	2017	-	94	Good	100	0	0



TW D-10



TW D-10

UZA – Rock Hill – York County Airport/Bryant Field

TW E

Branch ID	Branch Use	Number of Sections	Branch Area (SF)	Branch Area-Weighted Avg PCI	Branch Condition Rating
TW E	TAXIWAY	2	29,440	82	Satisfactory

Section ID	Area (SF)	Surface	Est. Last Major Work Year	Est. Last Global Treatment Year	PCI	Condition Rating	PCI % Climate	PCI % Load	PCI % Other
10	17,715	AAC	2017	-	94	Good	100	0	0
20	11,725	AAC	2012	-	63	Fair	100	0	0



TW E-10



TW E-20

TW F

Branch ID	Branch Use	Number of Sections	Branch Area (SF)	Branch Area-Weighted Avg PCI	Branch Condition Rating
TW F	TAXIWAY	2	18,886	75	Satisfactory

Section ID	Area (SF)	Surface	Est. Last Major Work Year	Est. Last Global Treatment Year	PCI	Condition Rating	PCI % Climate	PCI % Load	PCI % Other
10	10,312	AAC	2017	-	85	Satisfactory	94	0	6
20	8,574	AAC	2012	-	63	Fair	100	0	0



TW F-10



TW F-20

UZA – Rock Hill – York County Airport/Bryant Field

TW J

Branch ID	Branch Use	Number of Sections	Branch Area (SF)	Branch Area-Weighted Avg PCI	Branch Condition Rating
TW J	TAXIWAY	2	59,331	65	Fair

Section ID	Area (SF)	Surface	Est. Last Major Work Year	Est. Last Global Treatment Year	PCI	Condition Rating	PCI % Climate	PCI % Load	PCI % Other
10	52,031	AAC	2001	-	64	Fair	100	0	0
20	7,300	AAC	2012	-	75	Satisfactory	100	0	0



TW J-10



TW J-20



TW J-20

TL 01

Branch ID	Branch Use	Number of Sections	Branch Area (SF)	Branch Area-Weighted Avg PCI	Branch Condition Rating
TL 01	TAXILANE	3	76,511	72	Satisfactory

Section ID	Area (SF)	Surface	Est. Last Major Work Year	Est. Last Global Treatment Year	PCI	Condition Rating	PCI % Climate	PCI % Load	PCI % Other
10	23,225	PCC	1995	-	41	Poor	13	67	20
20	25,506	AAC	2014	-	88	Good	100	0	0
30	27,780	AC	2008	-	82	Satisfactory	100	0	0



TL 01-10



TL 01-10



TL 01-10



TL 01-10



Appendix E – Re-Inspection Report

Re-Inspection Report

SCAC_2021

Generated Date

5/29/2022

Page 1 of 33

Network: UZA		Name: Rock Hill - York County Airport - Bryant Field	
Branch: AP 01	Name: APRON 01	Use: APRON	Area: 423,415 SqFt
Section: 10 of 6	From: -	To: -	Last Const.: 10/29/2014
Surface: AAC	Family: SC II-AP-AC	Zone:	Category: G
Area: 194,880 SqFt	Length: 750 Ft	Width: 225 Ft	Rank: S
Slabs:	Slab Length: Ft	Slab Width: Ft	Joint Length: Ft
Shoulder:	Street Type:	Grade: 0	Lanes: 0
Section Comments:			
Work Date: 3/1/1988	Work Type: New Construction - Initial	Code: NU-IN	Is Major M&R: True
Work Date: 3/1/1988	Work Type: Base Course - Aggregate	Code: BA-AG	Is Major M&R: False
Work Date: 3/1/1988	Work Type: Surface Course - AC (Layer Construct)	Code: SU-AC	Is Major M&R: False
Work Date: 10/29/2014	Work Type: Overlay - AC Structural	Code: OL-AS	Is Major M&R: True
Work Date: 10/30/2014	Work Type: Surface Seal - Rejuvenating	Code: SS-RE	Is Major M&R: False
Last Insp. Date: 9/23/2021	Total Samples: 39	Surveyed: 8	
Conditions: PCI: 86			
Inspection Comments:			
Sample Number: 04	Type: R	Area: 5000.00 SqFt	PCI: 81
Sample Comments:			
48 L & T CR	L	234.00 Ft	
57 WEATHERING	L	3150.00 SqFt	
Sample Number: 08	Type: R	Area: 5000.00 SqFt	PCI: 83
Sample Comments:			
48 L & T CR	L	195.00 Ft	
57 WEATHERING	L	5000.00 SqFt	
Sample Number: 14	Type: R	Area: 5000.00 SqFt	PCI: 90
Sample Comments:			
48 L & T CR	L	43.00 Ft	
57 WEATHERING	L	3150.00 SqFt	
Sample Number: 22	Type: R	Area: 5000.00 SqFt	PCI: 89
Sample Comments:			
48 L & T CR	L	69.00 Ft	
57 WEATHERING	L	2650.00 SqFt	
Sample Number: 24	Type: R	Area: 5000.00 SqFt	PCI: 82
Sample Comments:			
48 L & T CR	L	200.00 Ft	
57 WEATHERING	L	5000.00 SqFt	
Sample Number: 27	Type: R	Area: 5000.00 SqFt	PCI: 88
Sample Comments:			
48 L & T CR	L	101.00 Ft	
57 WEATHERING	L	4415.00 SqFt	
Sample Number: 31	Type: R	Area: 5000.00 SqFt	PCI: 85
Sample Comments:			
48 L & T CR	L	143.00 Ft	
57 WEATHERING	L	3482.00 SqFt	
Sample Number: 39	Type: R	Area: 6000.00 SqFt	PCI: 91
Sample Comments:			

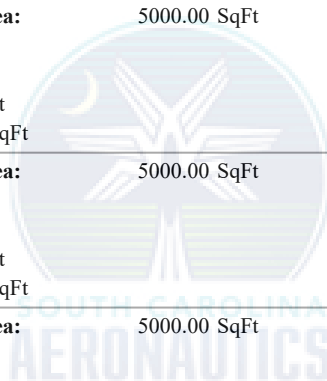

48 L & T CR
57 WEATHERING

L 14.00 Ft
L 6000.00 SqFt



Network: UZA **Name:** Rock Hill - York County Airport - Bryant Field

Branch: AP 01 **Name:** APRON 01 **Use:** APRON **Area:** 423,415 SqFt

Section: 20 of 6 **From:** - **To:** - **Last Const.:** 10/29/2014

Surface: AAC **Family:** SC II-AP-AC **Zone:** **Category:** G **Rank:** P

Area: 95,917 SqFt **Length:** 510 Ft **Width:** 205 Ft

Slabs: **Slab Length:** Ft **Slab Width:** Ft **Joint Length:** Ft

Shoulder: **Street Type:** **Grade:** 0 **Lanes:** 0

Section Comments:

Work Date: 3/1/1988 **Work Type:** Subbase - Aggregate **Code:** SB-AG **Is Major M&R:** False

Work Date: 3/1/1988 **Work Type:** Surface Course - AC (Layer Construct) **Code:** SU-AC **Is Major M&R:** False

Work Date: 3/1/1995 **Work Type:** OVERLAY-AC GLOBAL **Code:** OL-AT **Is Major M&R:** False

Work Date: 3/1/1995 **Work Type:** New Construction - Initial **Code:** NU-IN **Is Major M&R:** True

Work Date: 10/29/2014 **Work Type:** Overlay - AC Structural **Code:** OL-AS **Is Major M&R:** True

Work Date: 10/30/2014 **Work Type:** Surface Seal - Rejuvenating **Code:** SS-RE **Is Major M&R:** False

Last Insp. Date: 9/23/2021 **Total Samples:** 19 **Surveyed:** 4

Conditions: PCI: 83

Inspection Comments:

Sample Number: 02 **Type:** R **Area:** 5000.00 SqFt **PCI:** 83

Sample Comments:

48 L & T CR L 192.00 Ft
57 WEATHERING L 3000.00 SqFt

Sample Number: 05 **Type:** R **Area:** 5000.00 SqFt **PCI:** 76

Sample Comments:

48 L & T CR L 356.00 Ft
57 WEATHERING L 3050.00 SqFt

Sample Number: 11 **Type:** R **Area:** 5250.00 SqFt **PCI:** 86

Sample Comments:

48 L & T CR L 129.00 Ft
57 WEATHERING L 3000.00 SqFt

Sample Number: 14 **Type:** R **Area:** 5250.00 SqFt **PCI:** 87

Sample Comments:

48 L & T CR L 124.00 Ft
57 WEATHERING L 3000.00 SqFt

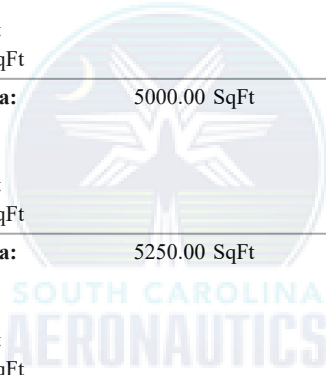

Network: UZA **Name:** Rock Hill - York County Airport - Bryant Field

Branch: AP 01 **Name:** APRON 01 **Use:** APRON **Area:** 423,415 SqFt

Section: 30 of 6 **From:** - **To:** - **Last Const.:** 1/1/2005

Surface: AC **Family:** SC II-AP-AC **Zone:** **Category:** **Rank:** S

Area: 24,100 SqFt **Length:** 240 Ft **Width:** 100 Ft

Slabs: **Slab Length:** Ft **Slab Width:** Ft **Joint Length:** Ft

Shoulder: **Street Type:** **Grade:** 0 **Lanes:** 0

Section Comments:

Work Date: 1/1/2005 **Work Type:** New Construction - Initial **Code:** NU-IN **Is Major M&R:** True

Last Insp. Date: 9/23/2021 **TotalSamples:** 6 **Surveyed:** 2

Conditions: PCI: 64

Inspection Comments:

Sample Number: 01 **Type:** R **Area:** 4200.00 SqFt **PCI:** 75

Sample Comments:

41 ALLIGATOR CR L 10.00 SqFt

48 L & T CR L 109.00 Ft

57 WEATHERING L 3150.00 SqFt

57 WEATHERING M 1050.00 SqFt

Sample Number: 03 **Type:** R **Area:** 3000.00 SqFt **PCI:** 48

Sample Comments:

41 ALLIGATOR CR L 5.00 SqFt

41 ALLIGATOR CR M 60.00 SqFt

48 L & T CR L 64.00 Ft

57 WEATHERING L 1500.00 SqFt

57 WEATHERING M 1500.00 SqFt



Network: UZA **Name:** Rock Hill - York County Airport - Bryant Field

Branch: AP 01 **Name:** APRON 01 **Use:** APRON **Area:** 423,415 SqFt

Section: 40 of 6 **From:** - **To:** - **Last Const.:** 10/29/2014

Surface: AC **Family:** SC II-AP-AC **Zone:** **Category:** **Rank:** S

Area: 15,750 SqFt **Length:** 157 Ft **Width:** 100 Ft

Slabs: **Slab Length:** Ft **Slab Width:** Ft **Joint Length:** Ft

Shoulder: **Street Type:** **Grade:** 0 **Lanes:** 0

Section Comments:

Work Date: 1/1/1999 **Work Type:** New Construction - Initial **Code:** NU-IN **Is Major M&R:** True

Work Date: 10/29/2014 **Work Type:** Complete Reconstruction - AC **Code:** CR-AC **Is Major M&R:** True

Last Insp. Date: 9/23/2021 **Total Samples:** 4 **Surveyed:** 1

Conditions: PCI: 93

Inspection Comments:

Sample Number: 04 **Type:** R **Area:** 3750.00 SqFt **PCI:** 93

Sample Comments:

42 BLEEDING N 6.00 SqFt
57 WEATHERING L 3750.00 SqFt



Network: UZA **Name:** Rock Hill - York County Airport - Bryant Field

Branch: AP 01 **Name:** APRON 01 **Use:** APRON **Area:** 423,415 SqFt

Section: 50 of 6 **From:** - **To:** - **Last Const.:** 10/29/2014

Surface: AAC **Family:** SC II-AP-AC **Zone:** **Category:** **Rank:** S

Area: 38,073 SqFt **Length:** 153 Ft **Width:** 245 Ft

Slabs: **Slab Length:** Ft **Slab Width:** Ft **Joint Length:** Ft

Shoulder: **Street Type:** **Grade:** 0 **Lanes:** 0

Section Comments:

Work Date: 1/1/2006 **Work Type:** New Construction - Initial **Code:** NU-IN **Is Major M&R:** True

Work Date: 10/29/2014 **Work Type:** Overlay - AC Structural **Code:** OL-AS **Is Major M&R:** True

Work Date: 10/30/2014 **Work Type:** Surface Seal - Rejuvenating **Code:** SS-RE **Is Major M&R:** False

Last Insp. Date: 9/23/2021 **TotalSamples:** 8 **Surveyed:** 2

Conditions: PCI: 93

Inspection Comments:

Sample Number: 03 **Type:** R **Area:** 5000.00 SqFt **PCI:** 94

Sample Comments:

57 WEATHERING L 3890.00 SqFt

Sample Number: 06 **Type:** R **Area:** 5300.00 SqFt **PCI:** 92

Sample Comments:

48 L & T CR L 6.00 Ft

57 WEATHERING L 5300.00 SqFt



Network: UZA **Name:** Rock Hill - York County Airport - Bryant Field

Branch: AP 01 **Name:** APRON 01 **Use:** APRON **Area:** 423,415 SqFt

Section: 60 of 6 **From:** - **To:** - **Last Const.:** 10/29/2014

Surface: AC **Family:** SC II-AP-AC **Zone:** **Category:** G **Rank:** P

Area: 54,695 SqFt **Length:** 276 Ft **Width:** 200 Ft

Slabs: **Slab Length:** Ft **Slab Width:** Ft **Joint Length:** Ft

Shoulder: **Street Type:** **Grade:** 0 **Lanes:** 0

Section Comments:

Work Date: 3/1/1988 **Work Type:** Subbase - Aggregate **Code:** SB-AG **Is Major M&R:** False

Work Date: 3/1/1988 **Work Type:** Surface Course - AC (Layer Construct) **Code:** SU-AC **Is Major M&R:** False

Work Date: 3/1/1995 **Work Type:** OVERLAY-AC GLOBAL **Code:** OL-AT **Is Major M&R:** False

Work Date: 3/1/1995 **Work Type:** New Construction - Initial **Code:** NU-IN **Is Major M&R:** True

Work Date: 10/29/2014 **Work Type:** Complete Reconstruction - AC **Code:** CR-AC **Is Major M&R:** True

Work Date: 10/30/2014 **Work Type:** Surface Seal - Rejuvenating **Code:** SS-RE **Is Major M&R:** False

Last Insp. Date: 9/23/2021 **TotalSamples:** 12 **Surveyed:** 3

Conditions: PCI: 86

Inspection Comments:

Sample Number: 01 **Type:** R **Area:** 3600.00 SqFt **PCI:** 86

Sample Comments:

48 L & T CR L 55.00 Ft
50 PATCHING L 16.00 SqFt
57 WEATHERING L 2084.00 SqFt

Sample Number: 05 **Type:** R **Area:** 5000.00 SqFt **PCI:** 88

Sample Comments:

48 L & T CR L 85.00 Ft
57 WEATHERING L 3620.00 SqFt

Sample Number: 11 **Type:** R **Area:** 5000.00 SqFt **PCI:** 84

Sample Comments:

48 L & T CR L 171.00 Ft
57 WEATHERING L 3100.00 SqFt

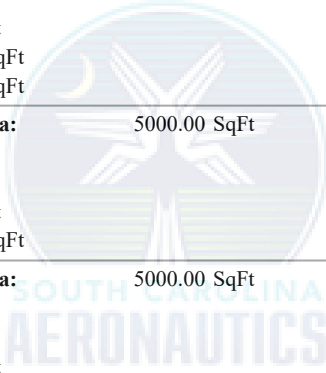

Network:	UZA		Name:	Rock Hill - York County Airport - Bryant Field					
Branch:	RW 2	Name:	RUNWAY 2/20	Use:	RUNWAY	Area:	550,200 SqFt		
Section:	10	of	1	From:	-	To:	-	Last Const.:	10/23/2012
Surface:	AAC	Family:	SC II-RW-AC	Zone:		Category:	G	Rank:	P
Area:	550,200 SqFt	Length:	5,500 Ft	Width:	100 Ft				
Slabs:		Slab Length:	Ft	Slab Width:	Ft	Joint Length:	Ft		
Shoulder:		Street Type:		Grade:	0	Lanes:	0		
Section Comments:									
Work Date:	3/1/1995	Work Type:	New Construction - Initial		Code:	NU-IN	Is Major M&R:	True	
Work Date:	3/1/1995	Work Type:	Base Course - Aggregate		Code:	BA-AG	Is Major M&R:	False	
Work Date:	3/1/1995	Work Type:	Surface Course - AC (Layer Construct)		Code:	SU-AC	Is Major M&R:	False	
Work Date:	7/1/2012	Work Type:	Reflective Crack Control Fabric		Code:	FB-RC	Is Major M&R:	True	
Work Date:	10/23/2012	Work Type:	Overlay - AC Structural		Code:	OL-AS	Is Major M&R:	True	
Last Insp. Date:	9/23/2021	TotalSamples:	110	Surveyed:	22				
Conditions:	PCI: 76								
Inspection Comments:									
Sample Number:	02	Type:	R	Area:	5000.00 SqFt	PCI:	85		
Sample Comments:									
48	L & T CR	L	147.00	Ft					
57	WEATHERING	L	5000.00	SqFt					
Sample Number:	07	Type:	R	Area:	5000.00 SqFt	PCI:	78		
Sample Comments:									
48	L & T CR	L	307.00	Ft					
57	WEATHERING	L	5000.00	SqFt					
Sample Number:	102	Type:	R	Area:	5000.00 SqFt	PCI:	75		
Sample Comments:									
48	L & T CR	L	400.00	Ft					
57	WEATHERING	L	5000.00	SqFt					
Sample Number:	107	Type:	R	Area:	5000.00 SqFt	PCI:	80		
Sample Comments:									
48	L & T CR	L	260.00	Ft					
57	WEATHERING	L	5000.00	SqFt					
Sample Number:	12	Type:	R	Area:	5000.00 SqFt	PCI:	67		
Sample Comments:									
48	L & T CR	L	321.00	Ft					
48	L & T CR	M	50.00	Ft					
52	RAVELING	L	141.00	SqFt					
57	WEATHERING	L	4859.00	SqFt					
Sample Number:	17	Type:	R	Area:	5000.00 SqFt	PCI:	75		
Sample Comments:									
48	L & T CR	L	339.00	Ft					
50	PATCHING	L	6.00	SqFt					
57	WEATHERING	L	4994.00	SqFt					
Sample Number:	22	Type:	R	Area:	5000.00 SqFt	PCI:	76		
Sample Comments:									
48	L & T CR	L	367.00	Ft					
57	WEATHERING	L	5000.00	SqFt					
Sample Number:	27	Type:	R	Area:	5000.00 SqFt	PCI:	71		
Sample Comments:									
48	L & T CR	L	362.00	Ft					

55	SLIPPAGE CR	N	15.00	SqFt		
57	WEATHERING	L	5000.00	SqFt		
Sample Number:	32	Type:	R	Area:	5000.00 SqFt	PCI: 78
Sample Comments:						
48	L & T CR	L	314.00	Ft		
57	WEATHERING	L	5000.00	SqFt		
Sample Number:	37	Type:	R	Area:	5000.00 SqFt	PCI: 76
Sample Comments:						
48	L & T CR	L	366.00	Ft		
57	WEATHERING	L	5000.00	SqFt		
Sample Number:	42	Type:	R	Area:	5000.00 SqFt	PCI: 78
Sample Comments:						
48	L & T CR	L	289.00	Ft		
56	SWELLING	L	4.00	SqFt		
57	WEATHERING	L	5000.00	SqFt		
Sample Number:	47	Type:	R	Area:	5000.00 SqFt	PCI: 78
Sample Comments:						
48	L & T CR	L	312.00	Ft		
57	WEATHERING	L	5000.00	SqFt		
Sample Number:	52	Type:	R	Area:	5000.00 SqFt	PCI: 75
Sample Comments:						
48	L & T CR	L	399.00	Ft		
57	WEATHERING	L	5000.00	SqFt		
Sample Number:	57	Type:	R	Area:	5000.00 SqFt	PCI: 75
Sample Comments:						
48	L & T CR	L	377.00	Ft		
57	WEATHERING	L	5000.00	SqFt		
Sample Number:	62	Type:	R	Area:	5000.00 SqFt	PCI: 76
Sample Comments:						
48	L & T CR	L	352.00	Ft		
57	WEATHERING	L	5000.00	SqFt		
Sample Number:	67	Type:	R	Area:	5000.00 SqFt	PCI: 77
Sample Comments:						
48	L & T CR	L	341.00	Ft		
57	WEATHERING	L	5000.00	SqFt		
Sample Number:	72	Type:	R	Area:	5000.00 SqFt	PCI: 82
Sample Comments:						
48	L & T CR	L	201.00	Ft		
57	WEATHERING	L	5000.00	SqFt		
Sample Number:	77	Type:	R	Area:	5000.00 SqFt	PCI: 76
Sample Comments:						
48	L & T CR	L	356.00	Ft		
57	WEATHERING	L	5000.00	SqFt		
Sample Number:	82	Type:	R	Area:	5000.00 SqFt	PCI: 78
Sample Comments:						
48	L & T CR	L	303.00	Ft		
57	WEATHERING	L	5000.00	SqFt		
Sample Number:	87	Type:	R	Area:	5000.00 SqFt	PCI: 72
Sample Comments:						
48	L & T CR	L	205.00	Ft		
48	L & T CR	M	33.00	Ft		
52	RAVELING	L	136.00	SqFt		
57	WEATHERING	L	4864.00	SqFt		

Sample Number: 92	Type: R	Area: 5000.00 SqFt	PCI: 78
--------------------------	----------------	---------------------------	----------------

Sample Comments:

48	L & T CR	L	309.00 Ft
57	WEATHERING	L	5000.00 SqFt

Sample Number: 97	Type: R	Area: 5000.00 SqFt	PCI: 77
--------------------------	----------------	---------------------------	----------------

Sample Comments:

48	L & T CR	L	212.00 Ft
48	L & T CR	M	50.00 Ft
57	WEATHERING	L	5000.00 SqFt



Network: UZA **Name:** Rock Hill - York County Airport - Bryant Field

Branch: TL 01 **Name:** TAXILANE 01 **Use:** TAXILANE **Area:** 76,511 SqFt

Section: 10 of 3 **From:** - **To:** - **Last Const.:** 6/1/1995

Surface: PCC **Family:** SC II - PCC **Zone:** **Category:** G **Rank:** T

Area: 23,225 SqFt **Length:** 1,000 Ft **Width:** 15 Ft

Slabs: 137 **Slab Length:** 13 Ft **Slab Width:** 13 Ft **Joint Length:** 1,293 Ft

Shoulder: **Street Type:** **Grade:** 0 **Lanes:** 0

Section Comments:

Work Date: 6/1/1995 **Work Type:** Surface Course - PCC (Layer Construct) **Code:** SU-PC **Is Major M&R:** False

Work Date: 6/1/1995 **Work Type:** New Construction - Initial **Code:** NU-IN **Is Major M&R:** True

Last Insp. Date: 9/23/2021 **TotalSamples:** 5 **Surveyed:** 3

Conditions: PCI: 41

Inspection Comments:

Sample Number: 01 **Type:** R **Area:** 20.00 Slabs **PCI:** 53

Sample Comments:

63 LINEAR CR L 3.00 Slabs
65 JT SEAL DMG H 20.00 Slabs
71 FAULTING L 1.00 Slabs
72 SHAT. SLAB L 2.00 Slabs
73 SHRINKAGE CR N 2.00 Slabs
74 JOINT SPALL L 6.00 Slabs
74 JOINT SPALL M 3.00 Slabs
75 CORNER SPALL L 1.00 Slabs

Sample Number: 03 **Type:** R **Area:** 17.00 Slabs **PCI:** 30

Sample Comments:

62 CORNER BREAK L 1.00 Slabs
63 LINEAR CR L 9.00 Slabs
63 LINEAR CR M 7.00 Slabs
65 JT SEAL DMG H 17.00 Slabs
72 SHAT. SLAB L 1.00 Slabs
73 SHRINKAGE CR N 1.00 Slabs
74 JOINT SPALL L 1.00 Slabs
74 JOINT SPALL M 1.00 Slabs

Sample Number: 04 **Type:** R **Area:** 15.00 Slabs **PCI:** 37

Sample Comments:

62 CORNER BREAK M 1.00 Slabs
63 LINEAR CR L 10.00 Slabs
63 LINEAR CR M 2.00 Slabs
65 JT SEAL DMG H 15.00 Slabs
72 SHAT. SLAB L 1.00 Slabs
74 JOINT SPALL L 3.00 Slabs
74 JOINT SPALL M 3.00 Slabs

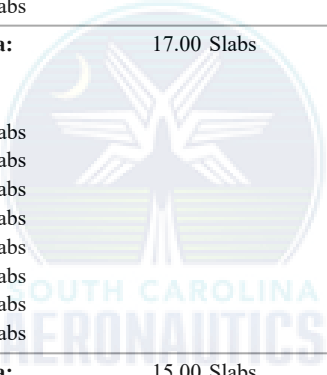

Network: UZA **Name:** Rock Hill - York County Airport - Bryant Field

Branch: TL 01 **Name:** TAXILANE 01 **Use:** TAXILANE **Area:** 76,511 SqFt

Section: 20 of 3 **From:** - **To:** - **Last Const.:** 10/29/2014

Surface: AAC **Family:** SC II-TW-TL-AC **Zone:** **Category:** G **Rank:** T

Area: 25,506 SqFt **Length:** 650 Ft **Width:** 40 Ft

Slabs: **Slab Length:** Ft **Slab Width:** Ft **Joint Length:** Ft

Shoulder: **Street Type:** **Grade:** 0 **Lanes:** 0

Section Comments:

Work Date: 3/1/1995 **Work Type:** New Construction - Initial **Code:** NU-IN **Is Major M&R:** True

Work Date: 10/29/2014 **Work Type:** Overlay - AC Structural **Code:** OL-AS **Is Major M&R:** True

Last Insp. Date: 9/23/2021 **Total Samples:** 5 **Surveyed:** 3

Conditions: PCI: 88

Inspection Comments:

Sample Number: 02 **Type:** R **Area:** 4376.00 SqFt **PCI:** 88

Sample Comments:

48 L & T CR L 88.00 Ft
57 WEATHERING L 4376.00 SqFt

Sample Number: 04 **Type:** R **Area:** 5294.00 SqFt **PCI:** 89

Sample Comments:

48 L & T CR L 84.00 Ft
57 WEATHERING L 5294.00 SqFt

Sample Number: 05 **Type:** R **Area:** 5371.00 SqFt **PCI:** 89

Sample Comments:

48 L & T CR L 67.00 Ft
57 WEATHERING L 5371.00 SqFt



Network: UZA **Name:** Rock Hill - York County Airport - Bryant Field

Branch: TL 01 **Name:** TAXILANE 01 **Use:** TAXILANE **Area:** 76,511 SqFt

Section: 30 of 3 **From:** - **To:** - **Last Const.:** 1/1/2008

Surface: AC **Family:** SC II-TW-TL-AC **Zone:** **Category:** **Rank:** P

Area: 27,780 SqFt **Length:** 277 Ft **Width:** 100 Ft

Slabs: **Slab Length:** Ft **Slab Width:** Ft **Joint Length:** Ft

Shoulder: **Street Type:** **Grade:** 0 **Lanes:** 0

Section Comments:

Work Date: 1/1/2008 **Work Type:** New Construction - Initial **Code:** NU-IN **Is Major M&R:** True

Last Insp. Date: 9/23/2021 **TotalSamples:** 6 **Surveyed:** 2

Conditions: PCI: 82

Inspection Comments:

Sample Number: 02 **Type:** R **Area:** 5250.00 SqFt **PCI:** 80

Sample Comments:

48 L & T CR L 188.00 Ft

57 WEATHERING L 4988.00 SqFt

57 WEATHERING M 262.00 SqFt

Sample Number: 03 **Type:** R **Area:** 3827.00 SqFt **PCI:** 86

Sample Comments:

48 L & T CR L 38.00 Ft

57 WEATHERING L 3636.00 SqFt

57 WEATHERING M 191.00 SqFt



Network:	UZA		Name:	Rock Hill - York County Airport - Bryant Field					
Branch:	TW A	Name:	TAXIWAY A	Use:	TAXIWAY	Area:	195,846 SqFt		
Section:	10	of	1	From:	-	To:	-	Last Const.:	11/1/2017
Surface:	AAC	Family:	SC II-TW-TL-AC	Zone:		Category:	G	Rank:	P
Area:	195,846 SqFt	Length:	5,406 Ft	Width:	35 Ft				
Slabs:		Slab Length:	Ft	Slab Width:	Ft	Joint Length:	Ft		
Shoulder:		Street Type:		Grade:	0	Lanes:	0		
Section Comments:									
Work Date:	3/1/1995	Work Type:	New Construction - Initial		Code:	NU-IN	Is Major M&R:	True	
Work Date:	3/1/1995	Work Type:	Base Course - Aggregate		Code:	BA-AG	Is Major M&R:	False	
Work Date:	3/1/1995	Work Type:	Surface Course - AC (Layer Construct)		Code:	SU-AC	Is Major M&R:	False	
Work Date:	11/1/2017	Work Type:	Overlay - AC Structural		Code:	OL-AS	Is Major M&R:	True	
Work Date:	11/2/2017	Work Type:	OVERLAY-AC GLOBAL		Code:	OL-AT	Is Major M&R:	False	
Last Insp. Date:	9/23/2021	TotalSamples:	37	Surveyed:	8				
Conditions:	PCI:	91							
Inspection Comments:									
Sample Number:	03	Type:	R	Area:	5868.00 SqFt	PCI:	91		
Sample Comments:									
42	BLEEDING		N	5.00	SqFt				
48	L & T CR		L	8.00	Ft				
57	WEATHERING		L	5868.00	SqFt				
Sample Number:	08	Type:	R	Area:	5250.00 SqFt	PCI:	90		
Sample Comments:									
48	L & T CR		L	27.00	Ft				
57	WEATHERING		L	5250.00	SqFt				
Sample Number:	13	Type:	R	Area:	5250.00 SqFt	PCI:	85		
Sample Comments:									
48	L & T CR		L	165.00	Ft				
57	WEATHERING		L	5250.00	SqFt				
Sample Number:	18	Type:	R	Area:	5250.00 SqFt	PCI:	87		
Sample Comments:									
48	L & T CR		L	121.00	Ft				
57	WEATHERING		L	5250.00	SqFt				
Sample Number:	21	Type:	R	Area:	5250.00 SqFt	PCI:	91		
Sample Comments:									
48	L & T CR		L	8.00	Ft				
57	WEATHERING		L	5250.00	SqFt				
Sample Number:	23	Type:	R	Area:	5250.00 SqFt	PCI:	94		
Sample Comments:									
57	WEATHERING		L	5250.00	SqFt				
Sample Number:	28	Type:	R	Area:	5250.00 SqFt	PCI:	94		
Sample Comments:									
57	WEATHERING		L	5250.00	SqFt				
Sample Number:	33	Type:	R	Area:	5250.00 SqFt	PCI:	94		
Sample Comments:									
57	WEATHERING		L	5250.00	SqFt				

Network: UZA **Name:** Rock Hill - York County Airport - Bryant Field

Branch: TW A1 **Name:** TAXIWAY A1 **Use:** TAXIWAY **Area:** 18,404 SqFt

Section: 10 of 2 **From:** - **To:** - **Last Const.:** 11/1/2017

Surface: AAC **Family:** SC II-TW-TL-AC **Zone:** **Category:** G **Rank:** P

Area: 9,224 SqFt **Length:** 154 Ft **Width:** 40 Ft

Slabs: **Slab Length:** Ft **Slab Width:** Ft **Joint Length:** Ft

Shoulder: **Street Type:** **Grade:** 0 **Lanes:** 0

Section Comments:

Work Date: 3/1/1995 **Work Type:** New Construction - Initial **Code:** NU-IN **Is Major M&R:** True

Work Date: 3/1/1995 **Work Type:** Base Course - Aggregate **Code:** BA-AG **Is Major M&R:** False

Work Date: 3/1/1995 **Work Type:** Surface Course - AC (Layer Construct) **Code:** SU-AC **Is Major M&R:** False

Work Date: 11/1/2017 **Work Type:** Overlay - AC Structural **Code:** OL-AS **Is Major M&R:** True

Work Date: 11/2/2017 **Work Type:** OVERLAY-AC GLOBAL **Code:** OL-AT **Is Major M&R:** False

Last Insp. Date: 9/23/2021 **TotalSamples:** 2 **Surveyed:** 1

Conditions: PCI: 92

Inspection Comments:

Sample Number: 01 **Type:** R **Area:** 4536.00 SqFt **PCI:** 92

Sample Comments:

48 L & T CR L 2.00 Ft
57 WEATHERING L 4536.00 SqFt



Network: UZA **Name:** Rock Hill - York County Airport - Bryant Field

Branch: TW A1 **Name:** TAXIWAY A1 **Use:** TAXIWAY **Area:** 18,404 SqFt

Section: 20 of 2 **From:** - **To:** - **Last Const.:** 10/23/2012

Surface: AAC **Family:** SC II-TW-TL-AC **Zone:** **Category:** G **Rank:** P

Area: 9,180 SqFt **Length:** 170 Ft **Width:** 45 Ft

Slabs: **Slab Length:** Ft **Slab Width:** Ft **Joint Length:** Ft

Shoulder: **Street Type:** **Grade:** 0 **Lanes:** 0

Section Comments:

Work Date: 3/1/1995 **Work Type:** Surface Course - AC (Layer Construct) **Code:** SU-AC **Is Major M&R:** False

Work Date: 3/1/1995 **Work Type:** New Construction - Initial **Code:** NU-IN **Is Major M&R:** True

Work Date: 3/1/1995 **Work Type:** Base Course - Aggregate **Code:** BA-AG **Is Major M&R:** False

Work Date: 10/23/2012 **Work Type:** Overlay - AC Structural **Code:** OL-AS **Is Major M&R:** True

Last Insp. Date: 9/23/2021 **TotalSamples:** 2 **Surveyed:** 1

Conditions: PCI: 78

Inspection Comments:

Sample Number: 02 **Type:** R **Area:** 5610.00 SqFt **PCI:** 78

Sample Comments:

48 L & T CR L 330.00 Ft
57 WEATHERING L 5610.00 SqFt



Network:	UZA		Name:	Rock Hill - York County Airport - Bryant Field					
Branch:	TW A2	Name:	TAXIWAY A2	Use:	TAXIWAY	Area:	11,626 SqFt		
Section:	10	of	1	From:	-	To:	-	Last Const.:	11/1/2017
Surface:	AAC	Family:	SC II-TW-TL-AC	Zone:		Category:		Rank:	P
Area:	11,626 SqFt	Length:	79 Ft	Width:	96 Ft				
Slabs:		Slab Length:	Ft	Slab Width:	Ft	Joint Length:	Ft		
Shoulder:		Street Type:		Grade:	0	Lanes:	0		
Section Comments:									
Work Date:	1/1/2006	Work Type:	New Construction - Initial		Code:	NU-IN	Is Major M&R:	True	
Work Date:	11/1/2017	Work Type:	Overlay - AC Structural		Code:	OL-AS	Is Major M&R:	True	
Work Date:	11/2/2017	Work Type:	OVERLAY-AC GLOBAL		Code:	OL-AT	Is Major M&R:	False	
Last Insp. Date:	9/23/2021	TotalSamples:	2		Surveyed:	1			
Conditions:	PCI:	89							
Inspection Comments:									
Sample Number:	02	Type:	R	Area:	5608.00 SqFt	PCI:	89		
Sample Comments:									
48	L & T CR	L	54.00 Ft						
57	WEATHERING	L	5555.00 SqFt						



Network: UZA **Name:** Rock Hill - York County Airport - Bryant Field

Branch: TW A3 **Name:** TAXIWAY A3 **Use:** TAXIWAY **Area:** 11,934 SqFt

Section: 10 of 1 **From:** - **To:** - **Last Const.:** 11/1/2017

Surface: AAC **Family:** SC II-TW-TL-AC **Zone:** **Category:** G **Rank:** P

Area: 11,934 SqFt **Length:** 83 Ft **Width:** 96 Ft

Slabs: **Slab Length:** Ft **Slab Width:** Ft **Joint Length:** Ft

Shoulder: **Street Type:** **Grade:** 0 **Lanes:** 0

Section Comments:

Work Date: 3/1/1988 **Work Type:** Surface Course - AC (Layer Construct) **Code:** SU-AC **Is Major M&R:** False

Work Date: 3/1/1988 **Work Type:** Base Course - Aggregate **Code:** BA-AG **Is Major M&R:** False

Work Date: 3/1/1988 **Work Type:** New Construction - Initial **Code:** NU-IN **Is Major M&R:** True

Work Date: 11/1/2017 **Work Type:** Overlay - AC Structural **Code:** OL-AS **Is Major M&R:** True

Work Date: 11/2/2017 **Work Type:** OVERLAY-AC GLOBAL **Code:** OL-AT **Is Major M&R:** False

Last Insp. Date: 9/23/2021 **TotalSamples:** 2 **Surveyed:** 1

Conditions: PCI: 88

Inspection Comments:

Sample Number: 02 **Type:** R **Area:** 5957.00 SqFt **PCI:** 88

Sample Comments:

48 L & T CR L 107.00 Ft
57 WEATHERING L 5957.00 SqFt



Network: UZA **Name:** Rock Hill - York County Airport - Bryant Field

Branch: TW A4 **Name:** TAXIWAY A4 **Use:** TAXIWAY **Area:** 11,970 SqFt

Section: 10 of 1 **From:** - **To:** - **Last Const.:** 11/1/2017

Surface: AAC **Family:** SC II-TW-TL-AC **Zone:** **Category:** G **Rank:** S

Area: 11,970 SqFt **Length:** 83 Ft **Width:** 96 Ft

Slabs: **Slab Length:** Ft **Slab Width:** Ft **Joint Length:** Ft

Shoulder: **Street Type:** **Grade:** 0 **Lanes:** 0

Section Comments:

Work Date: 3/1/1988 **Work Type:** Surface Course - AC (Layer Construct) **Code:** SU-AC **Is Major M&R:** False

Work Date: 3/1/1988 **Work Type:** Subbase - Aggregate **Code:** SB-AG **Is Major M&R:** False

Work Date: 3/1/1995 **Work Type:** OVERLAY-AC GLOBAL **Code:** OL-AT **Is Major M&R:** False

Work Date: 3/1/1995 **Work Type:** New Construction - Initial **Code:** NU-IN **Is Major M&R:** True

Work Date: 11/1/2017 **Work Type:** Overlay - AC Structural **Code:** OL-AS **Is Major M&R:** True

Work Date: 11/2/2017 **Work Type:** OVERLAY-AC GLOBAL **Code:** OL-AT **Is Major M&R:** False

Last Insp. Date: 9/23/2021 **Total Samples:** 2 **Surveyed:** 1

Conditions: PCI: 86

Inspection Comments:

Sample Number: 02 **Type:** R **Area:** 5970.00 SqFt **PCI:** 86

Sample Comments:

48 L & T CR L 144.00 Ft
57 WEATHERING L 5970.00 SqFt



Network:	UZA		Name:	Rock Hill - York County Airport - Bryant Field					
Branch:	TW A5	Name:	TAXIWAY A5	Use:	TAXIWAY	Area:	15,305 SqFt		
Section:	10	of	1	From:	-	To:	-	Last Const.:	11/1/2017
Surface:	AC	Family:	SC II-TW-TL-AC	Zone:		Category:		Rank:	P
Area:	15,305 SqFt	Length:	135 Ft	Width:	96 Ft				
Slabs:		Slab Length:	Ft	Slab Width:	Ft	Joint Length:	Ft		
Shoulder:		Street Type:		Grade:	0	Lanes:	0		
Section Comments:									
Work Date:	11/1/2017	Work Type:	New Construction - AC		Code:	NC-AC	Is Major M&R:	True	
Work Date:	11/2/2017	Work Type:	Base Course - Aggregate		Code:	BA-AG	Is Major M&R:	False	
Work Date:	11/3/2017	Work Type:	Surface Course - AC (Layer Construct)		Code:	SU-AC	Is Major M&R:	False	
Last Insp. Date:	9/23/2021	TotalSamples:	3	Surveyed:	1				
Conditions:	PCI:	94							
Inspection Comments:									
Sample Number:	02	Type:	R	Area:	5689.00 SqFt	PCI:	94		
Sample Comments:									
57	WEATHERING	L	5689.00	SqFt					



Network: UZA **Name:** Rock Hill - York County Airport - Bryant Field

Branch: TW A6 **Name:** TAXIWAY A6 **Use:** TAXIWAY **Area:** 18,893 SqFt

Section: 10 of 2 **From:** - **To:** - **Last Const.:** 11/1/2017

Surface: AAC **Family:** SC II-TW-TL-AC **Zone:** **Category:** G **Rank:** P

Area: 10,190 SqFt **Length:** 175 Ft **Width:** 45 Ft

Slabs: **Slab Length:** Ft **Slab Width:** Ft **Joint Length:** Ft

Shoulder: **Street Type:** **Grade:** 0 **Lanes:** 0

Section Comments:

Work Date: 3/1/1995 **Work Type:** Base Course - Aggregate **Code:** BA-AG **Is Major M&R:** False

Work Date: 3/1/1995 **Work Type:** Surface Course - AC (Layer Construct) **Code:** SU-AC **Is Major M&R:** False

Work Date: 3/1/1995 **Work Type:** New Construction - Initial **Code:** NU-IN **Is Major M&R:** True

Work Date: 11/1/2017 **Work Type:** Overlay - AC Structural **Code:** OL-AS **Is Major M&R:** True

Work Date: 11/2/2017 **Work Type:** OVERLAY-AC GLOBAL **Code:** OL-AT **Is Major M&R:** False

Last Insp. Date: 9/23/2021 **TotalSamples:** 2 **Surveyed:** 1

Conditions: PCI: 87

Inspection Comments:

Sample Number: 02 **Type:** R **Area:** 5089.00 SqFt **PCI:** 87

Sample Comments:

48 L & T CR L 107.00 Ft
57 WEATHERING L 5089.00 SqFt



Network: UZA **Name:** Rock Hill - York County Airport - Bryant Field

Branch: TW A6 **Name:** TAXIWAY A6 **Use:** TAXIWAY **Area:** 18,893 SqFt

Section: 20 of 2 **From:** - **To:** - **Last Const.:** 10/23/2012

Surface: AAC **Family:** SC II-TW-TL-AC **Zone:** **Category:** G **Rank:** P

Area: 8,703 SqFt **Length:** 150 Ft **Width:** 50 Ft

Slabs: **Slab Length:** Ft **Slab Width:** Ft **Joint Length:** Ft

Shoulder: **Street Type:** **Grade:** 0 **Lanes:** 0

Section Comments:

Work Date: 3/1/1995 **Work Type:** Base Course - Aggregate **Code:** BA-AG **Is Major M&R:** False

Work Date: 3/1/1995 **Work Type:** Surface Course - AC (Layer Construct) **Code:** SU-AC **Is Major M&R:** False

Work Date: 3/1/1995 **Work Type:** New Construction - Initial **Code:** NU-IN **Is Major M&R:** True

Work Date: 10/23/2012 **Work Type:** Overlay - AC Structural **Code:** OL-AS **Is Major M&R:** True

Last Insp. Date: 9/23/2021 **TotalSamples:** 2 **Surveyed:** 1

Conditions: PCI: 72

Inspection Comments:

Sample Number: 02 **Type:** R **Area:** 4500.00 SqFt **PCI:** 72

Sample Comments:

48 L & T CR L 448.00 Ft
57 WEATHERING L 4500.00 SqFt



Network: UZA **Name:** Rock Hill - York County Airport - Bryant Field

Branch: TW B **Name:** TAXIWAY B **Use:** TAXIWAY **Area:** 19,046 SqFt

Section: 10 of 2 **From:** - **To:** - **Last Const.:** 11/1/2017

Surface: AAC **Family:** SC II-TW-TL-AC **Zone:** **Category:** G **Rank:** P

Area: 9,398 SqFt **Length:** 154 Ft **Width:** 55 Ft

Slabs: **Slab Length:** Ft **Slab Width:** Ft **Joint Length:** Ft

Shoulder: **Street Type:** **Grade:** 0 **Lanes:** 0

Section Comments:

Work Date: 3/1/1995 **Work Type:** Base Course - Aggregate **Code:** BA-AG **Is Major M&R:** False

Work Date: 3/1/1995 **Work Type:** New Construction - Initial **Code:** NU-IN **Is Major M&R:** True

Work Date: 3/1/1995 **Work Type:** Surface Course - AC (Layer Construct) **Code:** SU-AC **Is Major M&R:** False

Work Date: 11/1/2017 **Work Type:** Overlay - AC Structural **Code:** OL-AS **Is Major M&R:** True

Work Date: 11/2/2017 **Work Type:** OVERLAY-AC GLOBAL **Code:** OL-AT **Is Major M&R:** False

Last Insp. Date: 9/23/2021 **TotalSamples:** 2 **Surveyed:** 1

Conditions: PCI: 91

Inspection Comments:

Sample Number: 02 **Type:** R **Area:** 4772.00 SqFt **PCI:** 91

Sample Comments:

48 L & T CR L 9.00 Ft
57 WEATHERING L 4772.00 SqFt



Network:	UZA		Name:	Rock Hill - York County Airport - Bryant Field			
Branch:	TW B	Name:	TAXIWAY B	Use:	TAXIWAY	Area:	19,046 SqFt
Section:	20	of 2	From:	-	To:	-	Last Const.: 10/23/2012
Surface:	AAC	Family:	SC II-TW-TL-AC	Zone:		Category:	G
Area:	9,648 SqFt	Length:	170 Ft	Width:	55 Ft	Rank:	P
Slabs:		Slab Length:	Ft	Slab Width:	Ft	Joint Length:	Ft
Shoulder:		Street Type:		Grade:	0	Lanes:	0
Section Comments:							
Work Date:	3/1/1995	Work Type:	New Construction - Initial	Code:	NU-IN	Is Major M&R:	True
Work Date:	3/1/1995	Work Type:	Base Course - Aggregate	Code:	BA-AG	Is Major M&R:	False
Work Date:	3/1/1995	Work Type:	Surface Course - AC (Layer Construct)	Code:	SU-AC	Is Major M&R:	False
Work Date:	10/23/2012	Work Type:	Overlay - AC Structural	Code:	OL-AS	Is Major M&R:	True
Last Insp. Date:	9/23/2021	TotalSamples:	2	Surveyed:	1		
Conditions:	PCI: 63						
Inspection Comments:							
Sample Number:	02	Type:	R	Area:	6137.00 SqFt	PCI:	63
Sample Comments:							
48	L & T CR	L	779.00	Ft			
48	L & T CR	M	18.00	Ft			
57	WEATHERING	L	6137.00	SqFt			



Network: UZA **Name:** Rock Hill - York County Airport - Bryant Field

Branch: TW C **Name:** TAXIWAY C **Use:** TAXIWAY **Area:** 29,440 SqFt

Section: 10 of 2 **From:** - **To:** - **Last Const.:** 11/1/2017

Surface: AAC **Family:** SC II-TW-TL-AC **Zone:** **Category:** G **Rank:** S

Area: 17,228 SqFt **Length:** 163 Ft **Width:** 65 Ft

Slabs: **Slab Length:** Ft **Slab Width:** Ft **Joint Length:** Ft

Shoulder: **Street Type:** **Grade:** 0 **Lanes:** 0

Section Comments:

Work Date: 3/1/1995 **Work Type:** New Construction - Initial **Code:** NU-IN **Is Major M&R:** True

Work Date: 3/1/1995 **Work Type:** Surface Course - AC (Layer Construct) **Code:** SU-AC **Is Major M&R:** False

Work Date: 3/1/1995 **Work Type:** Base Course - Aggregate **Code:** BA-AG **Is Major M&R:** False

Work Date: 11/1/2017 **Work Type:** Overlay - AC Structural **Code:** OL-AS **Is Major M&R:** True

Work Date: 11/2/2017 **Work Type:** OVERLAY-AC GLOBAL **Code:** OL-AT **Is Major M&R:** False

Last Insp. Date: 9/23/2021 **TotalSamples:** 3 **Surveyed:** 1

Conditions: PCI: 91

Inspection Comments:

Sample Number: 02 **Type:** R **Area:** 5505.00 SqFt **PCI:** 91

Sample Comments:

48 L & T CR L 11.00 Ft
57 WEATHERING L 5505.00 SqFt



Network: UZA **Name:** Rock Hill - York County Airport - Bryant Field

Branch: TW C **Name:** TAXIWAY C **Use:** TAXIWAY **Area:** 29,440 SqFt

Section: 20 of 2 **From:** - **To:** - **Last Const.:** 10/23/2012

Surface: AAC **Family:** SC II-TW-TL-AC **Zone:** **Category:** G **Rank:** S

Area: 12,212 SqFt **Length:** 170 Ft **Width:** 105 Ft

Slabs: **Slab Length:** Ft **Slab Width:** Ft **Joint Length:** Ft

Shoulder: **Street Type:** **Grade:** 0 **Lanes:** 0

Section Comments:

Work Date: 3/1/1995 **Work Type:** Surface Course - AC (Layer Construct) **Code:** SU-AC **Is Major M&R:** False

Work Date: 3/1/1995 **Work Type:** Base Course - Aggregate **Code:** BA-AG **Is Major M&R:** False

Work Date: 3/1/1995 **Work Type:** New Construction - Initial **Code:** NU-IN **Is Major M&R:** True

Work Date: 10/23/2012 **Work Type:** Overlay - AC Structural **Code:** OL-AS **Is Major M&R:** True

Last Insp. Date: 9/23/2021 **TotalSamples:** 3 **Surveyed:** 1

Conditions: PCI: 76

Inspection Comments:

Sample Number: 03 **Type:** R **Area:** 5100.00 SqFt **PCI:** 76

Sample Comments:

48 L & T CR L 360.00 Ft
57 WEATHERING L 5100.00 SqFt



Network:	UZA		Name:	Rock Hill - York County Airport - Bryant Field					
Branch:	TW D	Name:	TAXIWAY D	Use:	TAXIWAY	Area:	25,798 SqFt		
Section:	10	of	1	From:	-	To:	-	Last Const.:	11/1/2017
Surface:	AC	Family:	SC II-TW-TL-AC	Zone:		Category:		Rank:	P
Area:	25,798 SqFt	Length:	333 Ft	Width:	45 Ft				
Slabs:		Slab Length:	Ft	Slab Width:	Ft	Joint Length:	Ft		
Shoulder:		Street Type:		Grade:	0	Lanes:	0		
Section Comments:									
Work Date:	11/1/2017	Work Type:	New Construction - AC		Code:	NC-AC	Is Major M&R:	True	
Work Date:	11/2/2017	Work Type:	Base Course - Aggregate		Code:	BA-AG	Is Major M&R:	False	
Work Date:	11/3/2017	Work Type:	Surface Course - AC (Layer Construct)		Code:	SU-AC	Is Major M&R:	False	
Last Insp. Date:	9/23/2021	TotalSamples:	5	Surveyed:	1				
Conditions:	PCI:	94							
Inspection Comments:									
Sample Number:	03	Type:	R	Area:	4988.00 SqFt	PCI:	94		
Sample Comments:									
57	WEATHERING	L	4988.00	SqFt					



Network: UZA **Name:** Rock Hill - York County Airport - Bryant Field

Branch: TW E **Name:** TAXIWAY E **Use:** TAXIWAY **Area:** 29,440 SqFt

Section: 10 of 2 **From:** - **To:** - **Last Const.:** 11/1/2017

Surface: AAC **Family:** SC II-TW-TL-AC **Zone:** **Category:** G **Rank:** P

Area: 17,715 SqFt **Length:** 163 Ft **Width:** 60 Ft

Slabs: **Slab Length:** Ft **Slab Width:** Ft **Joint Length:** Ft

Shoulder: **Street Type:** **Grade:** 0 **Lanes:** 0

Section Comments:

Work Date: 3/1/1995 **Work Type:** New Construction - Initial **Code:** NU-IN **Is Major M&R:** True

Work Date: 3/1/1995 **Work Type:** Base Course - Aggregate **Code:** BA-AG **Is Major M&R:** False

Work Date: 3/1/1995 **Work Type:** Surface Course - AC (Layer Construct) **Code:** SU-AC **Is Major M&R:** False

Work Date: 11/1/2017 **Work Type:** Overlay - AC Structural **Code:** OL-AS **Is Major M&R:** True

Work Date: 11/2/2017 **Work Type:** OVERLAY-AC GLOBAL **Code:** OL-AT **Is Major M&R:** False

Last Insp. Date: 9/23/2021 **TotalSamples:** 3 **Surveyed:** 1

Conditions: PCI: 94

Inspection Comments:

Sample Number: 02 **Type:** R **Area:** 5505.00 SqFt **PCI:** 94

Sample Comments:

57 WEATHERING L 5505.00 SqFt



Network: UZA **Name:** Rock Hill - York County Airport - Bryant Field

Branch: TW E **Name:** TAXIWAY E **Use:** TAXIWAY **Area:** 29,440 SqFt

Section: 20 of 2 **From:** - **To:** - **Last Const.:** 10/23/2012

Surface: AAC **Family:** SC II-TW-TL-AC **Zone:** **Category:** G **Rank:** P

Area: 11,725 SqFt **Length:** 170 Ft **Width:** 105 Ft

Slabs: **Slab Length:** Ft **Slab Width:** Ft **Joint Length:** Ft

Shoulder: **Street Type:** **Grade:** 0 **Lanes:** 0

Section Comments:

Work Date: 3/1/1995 **Work Type:** New Construction - Initial **Code:** NU-IN **Is Major M&R:** True

Work Date: 3/1/1995 **Work Type:** Surface Course - AC (Layer Construct) **Code:** SU-AC **Is Major M&R:** False

Work Date: 3/1/1995 **Work Type:** Base Course - Aggregate **Code:** BA-AG **Is Major M&R:** False

Work Date: 10/23/2012 **Work Type:** Overlay - AC Structural **Code:** OL-AS **Is Major M&R:** True

Last Insp. Date: 9/23/2021 **TotalSamples:** 3 **Surveyed:** 1

Conditions: PCI: 63

Inspection Comments:

Sample Number: 03 **Type:** R **Area:** 4250.00 SqFt **PCI:** 63

Sample Comments:

48 L & T CR L 567.00 Ft
48 L & T CR M 24.00 Ft
57 WEATHERING L 4250.00 SqFt



Network: UZA **Name:** Rock Hill - York County Airport - Bryant Field

Branch: TW F **Name:** TAXIWAY F **Use:** TAXIWAY **Area:** 18,886 SqFt

Section: 10 of 2 **From:** - **To:** - **Last Const.:** 11/1/2017

Surface: AAC **Family:** SC II-TW-TL-AC **Zone:** **Category:** G **Rank:** S

Area: 10,312 SqFt **Length:** 175 Ft **Width:** 50 Ft

Slabs: **Slab Length:** Ft **Slab Width:** Ft **Joint Length:** Ft

Shoulder: **Street Type:** **Grade:** 0 **Lanes:** 0

Section Comments:

Work Date: 3/1/1995 **Work Type:** Base Course - Aggregate **Code:** BA-AG **Is Major M&R:** False

Work Date: 3/1/1995 **Work Type:** Surface Course - AC (Layer Construct) **Code:** SU-AC **Is Major M&R:** False

Work Date: 3/1/1995 **Work Type:** New Construction - Initial **Code:** NU-IN **Is Major M&R:** True

Work Date: 11/1/2017 **Work Type:** Overlay - AC Structural **Code:** OL-AS **Is Major M&R:** True

Work Date: 11/2/2017 **Work Type:** OVERLAY-AC GLOBAL **Code:** OL-AT **Is Major M&R:** False

Last Insp. Date: 9/23/2021 **TotalSamples:** 2 **Surveyed:** 1

Conditions: PCI: 85

Inspection Comments:

Sample Number: 02 **Type:** R **Area:** 5327.00 SqFt **PCI:** 85

Sample Comments:

48 L & T CR L 132.00 Ft
56 SWELLING L 2.00 SqFt
57 WEATHERING L 5327.00 SqFt



Network: UZA **Name:** Rock Hill - York County Airport - Bryant Field

Branch: TW F **Name:** TAXIWAY F **Use:** TAXIWAY **Area:** 18,886 SqFt

Section: 20 of 2 **From:** - **To:** - **Last Const.:** 10/23/2012

Surface: AAC **Family:** SC II-TW-TL-AC **Zone:** **Category:** G **Rank:** S

Area: 8,574 SqFt **Length:** 150 Ft **Width:** 75 Ft

Slabs: **Slab Length:** Ft **Slab Width:** Ft **Joint Length:** Ft

Shoulder: **Street Type:** **Grade:** 0 **Lanes:** 0

Section Comments:

Work Date: 3/1/1995 **Work Type:** Surface Course - AC (Layer Construct) **Code:** SU-AC **Is Major M&R:** False

Work Date: 3/1/1995 **Work Type:** New Construction - Initial **Code:** NU-IN **Is Major M&R:** True

Work Date: 3/1/1995 **Work Type:** Base Course - Aggregate **Code:** BA-AG **Is Major M&R:** False

Work Date: 10/23/2012 **Work Type:** Overlay - AC Structural **Code:** OL-AS **Is Major M&R:** True

Last Insp. Date: 9/23/2021 **TotalSamples:** 2 **Surveyed:** 1

Conditions: PCI: 63

Inspection Comments:

Sample Number: 02 **Type:** R **Area:** 5392.00 SqFt **PCI:** 63

Sample Comments:

48 L & T CR L 715.00 Ft
48 L & T CR M 23.00 Ft
57 WEATHERING L 5392.00 SqFt



Network: UZA **Name:** Rock Hill - York County Airport - Bryant Field

Branch: TW J **Name:** TAXIWAY J **Use:** TAXIWAY **Area:** 59,331 SqFt

Section: 10 of 2 **From:** - **To:** - **Last Const.:** 11/15/2001

Surface: AAC **Family:** SC II-TW-TL-AC **Zone:** **Category:** G **Rank:** S

Area: 52,031 SqFt **Length:** 1,662 Ft **Width:** 35 Ft

Slabs: **Slab Length:** Ft **Slab Width:** Ft **Joint Length:** Ft

Shoulder: **Street Type:** **Grade:** 0 **Lanes:** 0

Section Comments:

Work Date: 3/1/1988 **Work Type:** New Construction - Initial **Code:** NU-IN **Is Major M&R:** True

Work Date: 3/1/1988 **Work Type:** Surface Course - AC (Layer Construct) **Code:** SU-AC **Is Major M&R:** False

Work Date: 11/15/2001 **Work Type:** Overlay - AC Structural **Code:** OL-AS **Is Major M&R:** True

Work Date: 11/15/2001 **Work Type:** Surface Course - AC (Layer Construct) **Code:** SU-AC **Is Major M&R:** False

Last Insp. Date: 9/23/2021 **TotalSamples:** 14 **Surveyed:** 4

Conditions: PCI: 64

Inspection Comments:

Sample Number: 03 **Type:** R **Area:** 3500.00 SqFt **PCI:** 64

Sample Comments:

48 L & T CR L 260.00 Ft
48 L & T CR M 50.00 Ft
52 RAVELING L 3500.00 SqFt

Sample Number: 06 **Type:** R **Area:** 3500.00 SqFt **PCI:** 64

Sample Comments:

48 L & T CR L 180.00 Ft
48 L & T CR M 25.00 Ft
52 RAVELING L 3500.00 SqFt

Sample Number: 09 **Type:** R **Area:** 3500.00 SqFt **PCI:** 64

Sample Comments:

48 L & T CR L 231.00 Ft
48 L & T CR M 15.00 Ft
52 RAVELING L 3500.00 SqFt

Sample Number: 13 **Type:** R **Area:** 3500.00 SqFt **PCI:** 64

Sample Comments:

48 L & T CR L 214.00 Ft
48 L & T CR M 50.00 Ft
52 RAVELING L 3500.00 SqFt

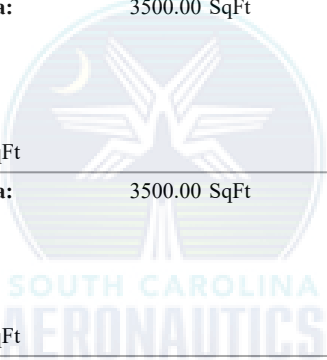

Network: UZA **Name:** Rock Hill - York County Airport - Bryant Field

Branch: TW J **Name:** TAXIWAY J **Use:** TAXIWAY **Area:** 59,331 SqFt

Section: 20 of 2 **From:** - **To:** - **Last Const.:** 10/23/2012

Surface: AAC **Family:** SC II-TW-TL-AC **Zone:** **Category:** G **Rank:** S

Area: 7,300 SqFt **Length:** 70 Ft **Width:** 100 Ft

Slabs: **Slab Length:** Ft **Slab Width:** Ft **Joint Length:** Ft

Shoulder: **Street Type:** **Grade:** 0 **Lanes:** 0

Section Comments:

Work Date: 3/1/1988 **Work Type:** New Construction - Initial **Code:** NU-IN **Is Major M&R:** True

Work Date: 3/1/1988 **Work Type:** Surface Course - AC (Layer Construct) **Code:** SU-AC **Is Major M&R:** False

Work Date: 11/15/2001 **Work Type:** Surface Course - AC (Layer Construct) **Code:** SU-AC **Is Major M&R:** False

Work Date: 10/23/2012 **Work Type:** Overlay - AC Structural **Code:** OL-AS **Is Major M&R:** True

Last Insp. Date: 9/23/2021 **TotalSamples:** 2 **Surveyed:** 1

Conditions: PCI: 75

Inspection Comments:

Sample Number: 02 **Type:** R **Area:** 3500.00 SqFt **PCI:** 75

Sample Comments:

48 L & T CR L 271.00 Ft
57 WEATHERING L 3500.00 SqFt





Kimley»»Horn