

COPYRIGHT © WK DICKSON & CO., INC. ALL RIGHTS RESERVED. REPRODUCTION OR USE OF THE CONTENTS OF THIS DOCUMENT, IN WHOLE OR IN PART, WITHOUT WRITTEN CONSENT OF WK DICKSON & CO., INC. IS PROHIBITED. THIS DOCUMENT, IN WHOLE OR IN PART, SHALL BE CONSIDERED TO BE VOID, IF THE ORIGINAL DRAWING AND SEAL SHALL BE CONSIDERED TO BE VOID, TRUE COPIES.

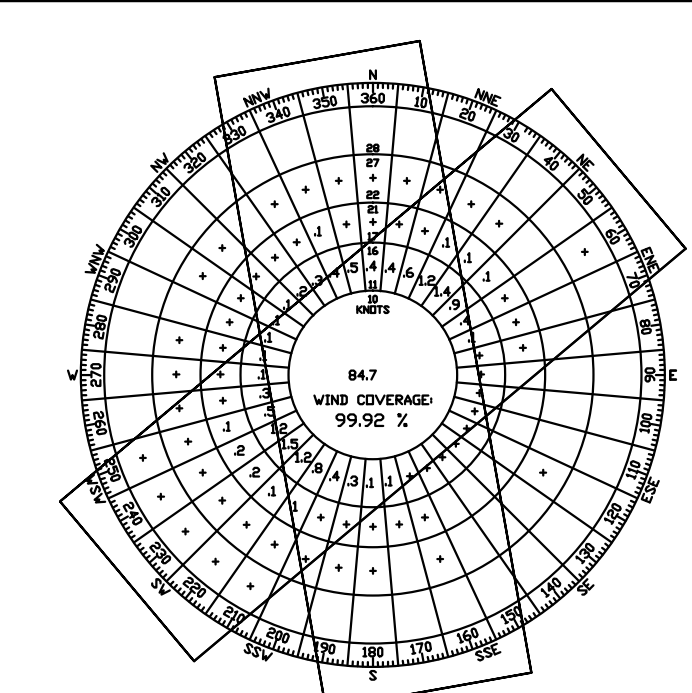

DIRECTION	ALL WEATHER
10.5 KTS / 12.1 MPH	13 KTS / 15.0 MPH
5/23	94.6
17/35	98.3
CALMS	23.3

SOURCE: NATIONAL OCEANIC AND ATMOSPHERIC ADMINISTRATION
 STATION: GREER - GREENVILLE, SC
 PERIOD COVERED: 1985-1994
 ANDERSON REGIONAL AIRPORT
 N/C NOT COVERED ALL WEATHER WIND ROSE

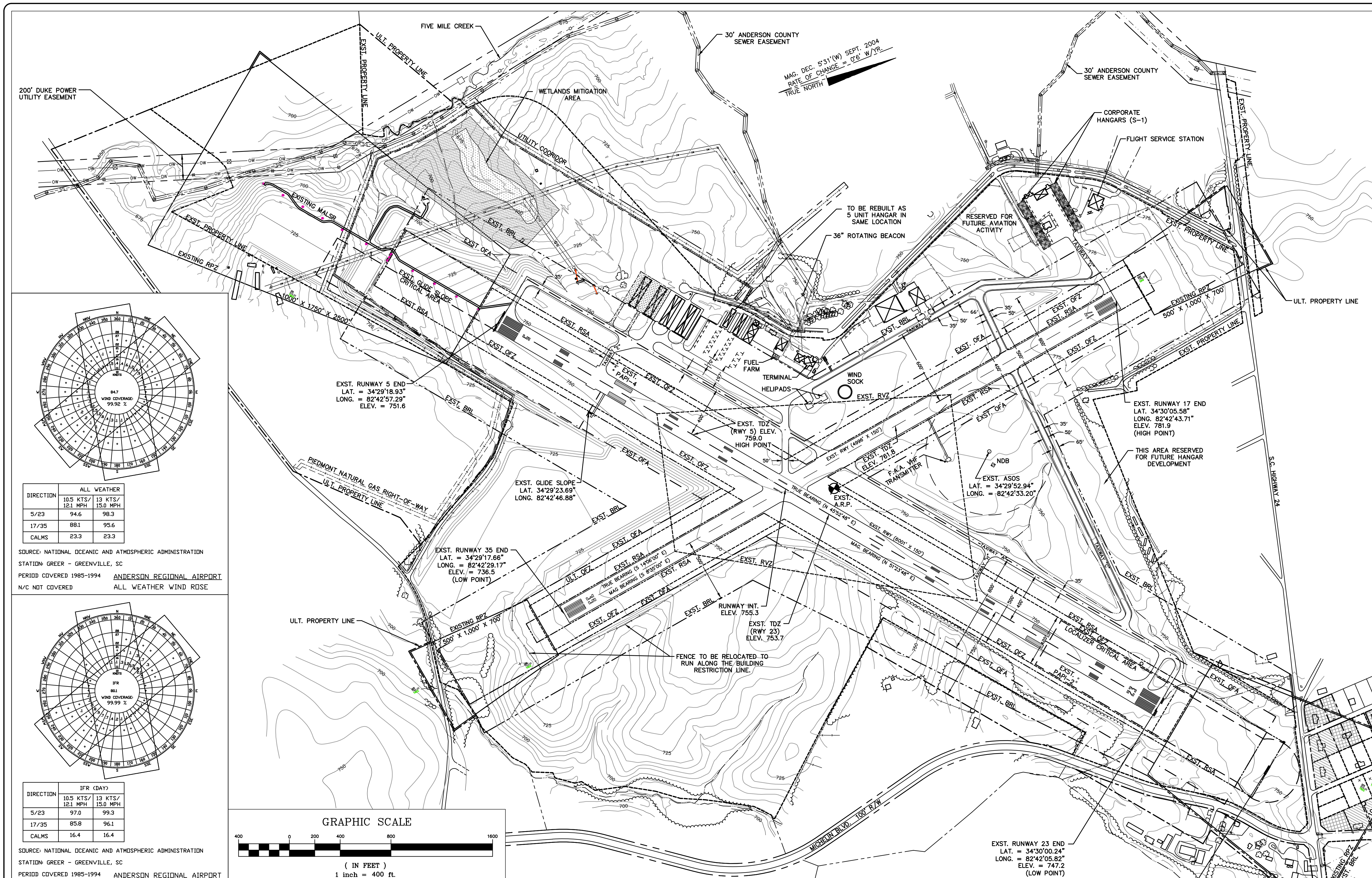
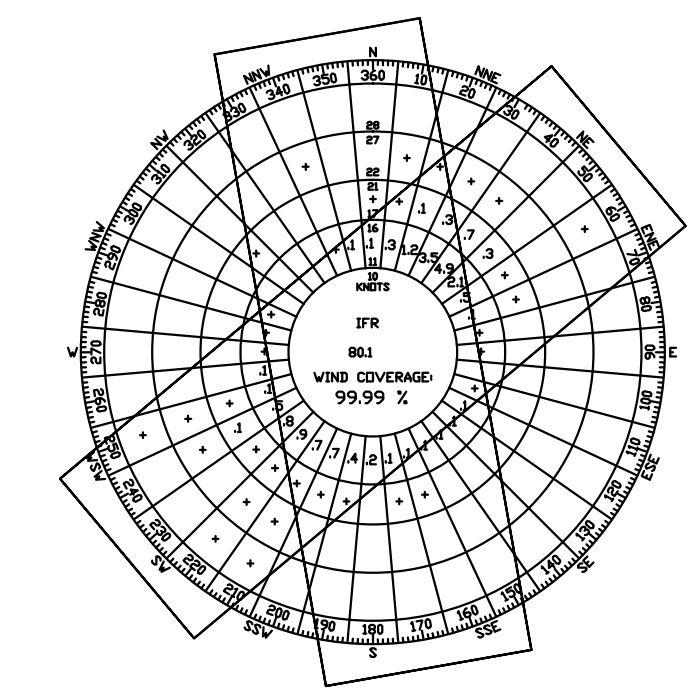

DIRECTION	IFR (DAY)
10.5 KTS / 12.1 MPH	13 KTS / 15.0 MPH
5/23	97.0
17/35	95.0
CALMS	16.4

SOURCE: NATIONAL OCEANIC AND ATMOSPHERIC ADMINISTRATION
 STATION: GREER - GREENVILLE, SC
 PERIOD COVERED: 1985-1994
 ANDERSON REGIONAL AIRPORT
 N/C NOT COVERED IFR WEATHER WIND ROSE

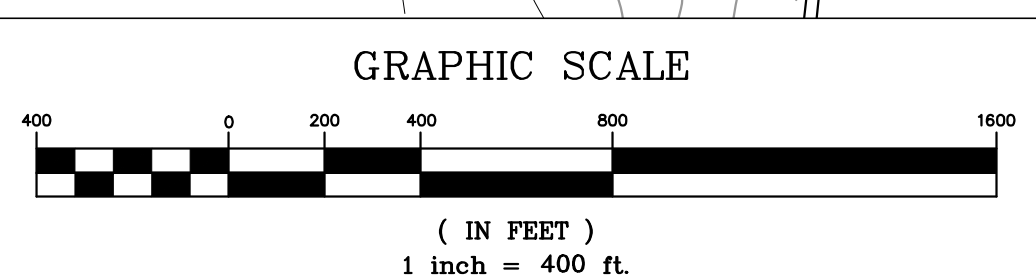

RUNWAY DATA (05-23)

	EXISTING	STAGE I	STAGE II	STAGE III
RUNWAY LENGTH & WIDTH	6,001' X 150'	N/C	N/C	N/C
EFFECTIVE GRADIENT (%)	.073%	N/C	N/C	N/C
% WIND COVERAGE	13 KTS/15.0 MPH ALL WEATHER 97.85%	N/C	N/C	N/C
PAVEMENT STRENGTH	SW 50,500 # (PUBLISHED)	N/C	N/C	N/C
APPROACH LIGHTING	MALS/R RWY 5	N/C	N/C	N/C
RUNWAY LIGHTING	HIRL	N/C	N/C	N/C
RUNWAY MARKING	PRECISION/ILS	N/C	N/C	N/C
APPROACH SURFACES/INST. RUNWAY	RWY 5 RWY 23	N/C	N/C	N/C
RUNWAY END 05 COORDINATES	LAT. 34° 29' 18.93" N LONG. 82° 42' 57.29" W	N/C	N/C	N/C
RUNWAY END 23 COORDINATES	LAT. 34° 30' 05.24" N LONG. 82° 42' 05.82" W	N/C	N/C	N/C
SURFACE MATERIAL	ASPHALT	N/C	N/C	N/C
VISUAL NAVAIDS	MALS/R PAPI-4; RWY 5 PAPI-2; RWY 23	N/C	N/C	N/C
OBJECT FREE AREA (OFA)	8,001' X 800'	N/C	N/C	N/C
RUNWAY SAFETY AREA	(SEE NOTE 2) 8,001' X 500'	N/C	N/C	N/C
RWY PROTECTION ZONE RWY 5	1000' X 1750' X 2500'	N/C	N/C	N/C
RWY PROTECTION ZONE RWY 23	1000' X 1510' X 1700'	N/C	N/C	N/C
DESIGN AIRCRAFT	GULFSTREAM IV	N/C	N/C	N/C
PART 77 APPROACH ZONE - RWY 5	1000' X 18200' X 50,000'	N/C	N/C	N/C
PART 77 APPROACH ZONE - RWY 23	1000' X 4,000' X 10,000'	N/C	N/C	N/C
PART 77 APPROACH SLOPE - RWY 5	50:1 - 100,000'	N/C	N/C	N/C
PART 77 APPROACH SLOPE - RWY 23	40:1 - 40,000'	N/C	N/C	N/C
PART 77 APPROACH SLOPE - RWY 23	34:1	N/C	N/C	N/C

RUNWAY DATA (17-35)

	EXISTING	STAGE I	STAGE II	STAGE III
RUNWAY LENGTH & WIDTH	4,996' X 150'	N/C	N/C	N/C
EFFECTIVE GRADIENT (%)	0.909%	N/C	N/C	N/C
% WIND COVERAGE	13 KTS/15.0 MPH ALL WEATHER 92.75%	N/C	N/C	N/C
PAVEMENT STRENGTH	SW 18,500 # SW 23,000 #	N/C	N/C	N/C
APPROACH LIGHTING	NONE	N/C	N/C	N/C
RUNWAY LIGHTING	NONE	MIRLS	N/C	N/C
RUNWAY MARKING	NPI, GPS	N/C	N/C	N/C
APPROACH SURFACES/INST. RUNWAY	RWY 17 VFR 20:1 RWY 35 NPI 34:1	N/C	N/C	N/C
RUNWAY END 17 COORDINATES	LAT. 34° 30' 05.58" N LONG. 82° 42' 43.71" W	N/C	N/C	N/C
RUNWAY END 35 COORDINATES	LAT. 34° 29' 17.66" N LONG. 82° 42' 29.17" W	N/C	N/C	N/C
SURFACE MATERIAL	ASPHALT	N/C	N/C	N/C
VISUAL NAVAIDS	NONE	N/C	N/C	N/C
OBJECT FREE AREA (OFA)	5,600' X 500'	N/C	N/C	N/C
RUNWAY SAFETY AREA	5,600' X 150'	N/C	N/C	N/C
RWY PROTECTION ZONE RWY 17	500' X 1,000' X 700'	N/C	N/C	N/C
RWY PROTECTION ZONE RWY 35	500' X 1,000' X 700'	N/C	N/C	N/C
DESIGN AIRCRAFT	BEECH 1900-C	N/C	N/C	N/C
PART 77 APPROACH ZONE - RWY 17	500' X 5,000' X 1,250'	N/C	N/C	N/C
PART 77 APPROACH ZONE - RWY 35	1,000' X 10,000' X 3,500'	N/C	N/C	N/C
PART 77 APPROACH SLOPE - RWY 17	20:1	N/C	N/C	N/C
PART 77 APPROACH SLOPE - RWY 35	34:1	N/C	N/C	N/C

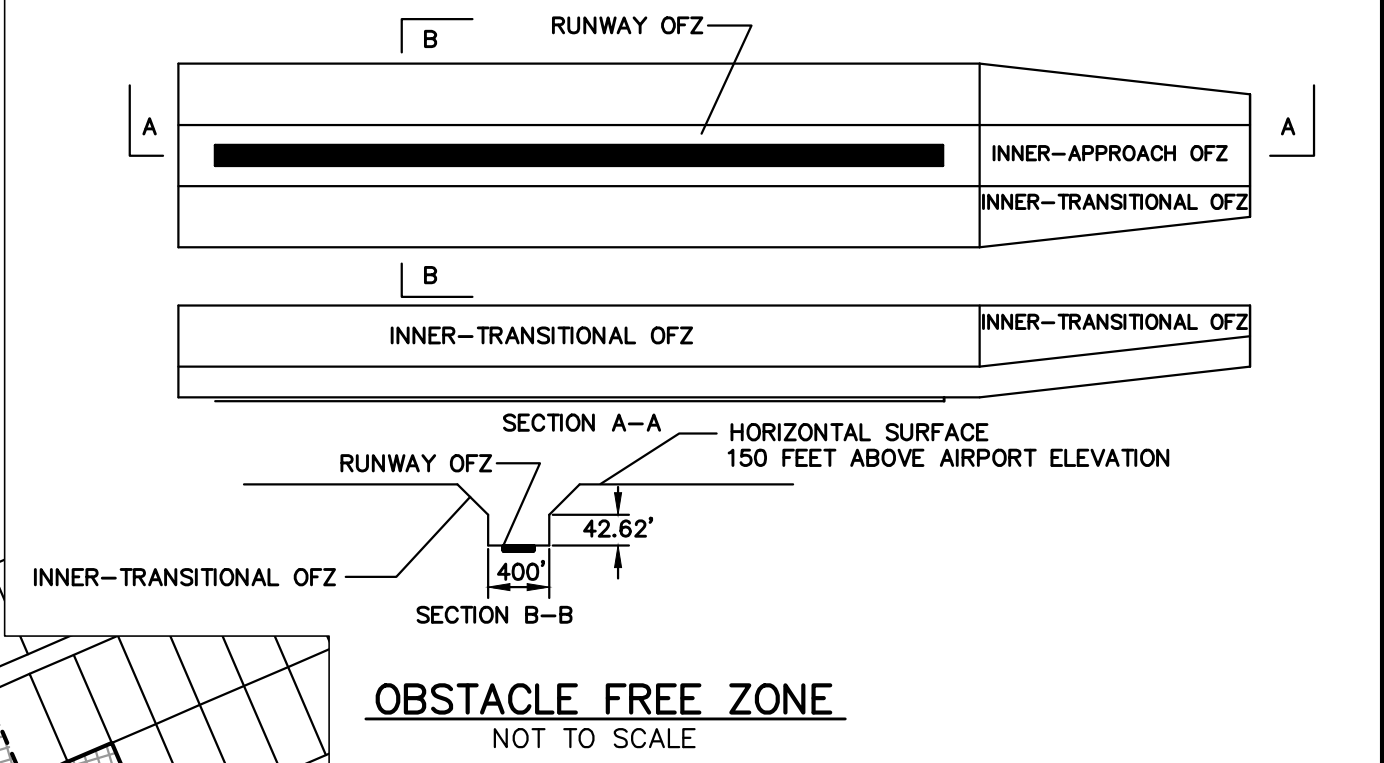

OBSTACLE FREE ZONE
 NOT TO SCALE

- NOTES:
- UPON EXTENSION OF RUNWAY 5, THE MALS, GLIDE SLOPE AND PAPI WILL REQUIRE RELOCATION WHICH MUST BE COORDINATED WITH THE FAA.
 - RUNWAY 17/35 RUNWAY SAFETY AREA (RSA) DIMENSIONS HAVE BEEN CHANGED TO REFLECT (B-II) RUNWAY CRITERIA. CHANGES TO THE AIRPORT CERTIFICATION MANUAL DETAILS RSA COMPLIANCE.
 - FOR COMPLETE PROPERTY LINE DETAILS SEE EXHIBIT "A" (SHEET 9 OF 9).
 - HORIZONTAL DATUM IS IN NAD 83. VERTICAL DATUM IS IN NAVD 88.

THIS SIGNATURE CERTIFIES SPONSOR'S APPROVAL OF THE INFORMATION CONTAINED IN THIS PLAN.
 _____ DATE _____
 MR. JOEY PRESTON
 COUNTY ADMINISTRATOR

CONSTRUCTION NOTICE REQUIREMENT
 TO PROTECT OPERATIONAL SAFETY AND FUTURE DEVELOPMENT, ALL PROPOSED CONSTRUCTION ON THE AIRPORT MUST BE COORDINATED BY THE AIRPORT OWNER WITH THE FAA AIRPORTS DISTRICT OFFICE PRIOR TO CONSTRUCTION. FAA'S REVIEW TAKES APPROXIMATELY 60 DAYS.

"THE PREPARATION OF THIS DOCUMENT WAS FINANCED IN PART THROUGH A PLANNING GRANT FROM THE FEDERAL AVIATION ADMINISTRATION AS PROVIDED UNDER SECTION 505 OF THE AIRPORT AND AIRWAY IMPROVEMENT ACT OF 1982. THE CONTENTS DO NOT NECESSARILY REFLECT THE OFFICIAL VIEWS OR POLICY OF THE FAA.
 ACCEPTANCE OF THIS REPORT BY THE FAA DOES NOT IN ANY WAY CONSTITUTE A COMMITMENT ON THE PART OF THE UNITED STATES TO PARTICIPATE IN ANY DEVELOPMENT DEPICTED THEREIN NOR DOES IT INDICATE THAT THE PROPOSED DEVELOPMENT IS ENVIRONMENTALLY ACCEPTABLE IN ACCORDANCE WITH APPROPRIATE PUBLIC LAWS."

	EXISTING	GENERAL DATA			LEGEND			
		0-5 YEARS STAGE I	6-10 YEARS STAGE II	11-20 YEARS STAGE III	EXISTING	STAGE I	STAGE II	STAGE III
AIRPORT REFERENCE CODE	RWY 5/23 RWY 17/35	C-II B-II	N/C	N/C	PROPERTY LINE (FEE SIMPLE)		N/C	N/C
ESTABLISHED AIRPORT ELEV. (PUBLISHED)	781.9	N/C	N/C	N/C	BUILDING RESTRICTION LINE (BRL)		N/C	N/C
NORMAL MAX. TEMP. HOTTEST MONTH	90° F	N/C	N/C	N/C	RUNWAY PROTECTION ZONE		N/C	N/C
DESIGNATED INSTRUMENT RUNWAY	RWY 5	N/C	N/C	N/C	PAVEMENT			
TAXIWAY LIGHTING	MITL	N/C	N/C	N/C	BUILDINGS			
AIRPORT REFERENCE POINT	LAT. 34° 29' 40.51" LONG. 82° 42' 33.78" NAD 83 (NAD 83 NOT BEYOND PAPI-4; RWY 5; RWY 23)	N/C	N/C	N/C	FENCING		N/C	N/C
AIRPORT & TERMINAL NAV. AIDS	N/C	N/C	N/C	N/C	GROUND CONTOUR		N/C	N/C
ACREAGE (FEE SIMPLE)	704.55	N/C	N/C	N/C	WOODED AREA		N/C	N/C
ACREAGE (EASEMENT)	4.17	N/C	N/C	N/C	DITCH/CREEK		N/C	N/C
REP. DESIGN CATEGORY AIRCRAFT	RWY 5/23 GULFSTREAM IV RWY 17/35 BEECH 1900-C	N/C	N/C	N/C	RUNWAY SAFETY AREA (RSA)		N/C	N/C
GPS APPROACH RUNWAYS	5, 23, 35	N/C	N/C	N/C	OBSTACLE FREE ZONE (OFZ)		N/C	N/C
					OBJECT FREE AREA (OFA)		N/C	N/C
					ILS CRITICAL AREA		N/C	N/C

REV. NO.	DESCRIPTION	DATE
1	UPDATE DRAWINGS TO REFLECT RUNWAY EXTENSION 5/23	12/04
2	REVISED RUNWAY 17/35 RSA TO REFLECT B-II CRITERIA	12/04
3	REVISED AS PER FAA AIP NO. 3-45-0004-12	5/06

PROJECT MANAGER: SEW
 DRAWN BY: RBT
 PROJECT DATE: NOV. 2004
 APPROVED BY: SEW
 FILE NAME: 40355.OO.CA
 PLOT DATE: 40355 ALP

DRAWING SCALE: 1" = 400'
 501 COMMERCE DRIVE NE
 COLUMBIA, SC 29223
 (803) 786-4261

WK DICKSON
 community infrastructure consultants

Office Locations:
 North Carolina
 South Carolina
 Georgia
 Florida

RELEASED FOR: APPROVALS
 BIDDER: CONSTRUCTION
 RECORD DWG.

ANDERSON REGIONAL AIRPORT
 ANDERSON, SOUTH CAROLINA

AIRPORT LAYOUT PLAN
 2 / 10
 D-4179