

COPYRIGHT © WK DICKSON & CO., INC. ALL RIGHTS RESERVED. REPRODUCTION OR USE OF THE CONTENTS OF THIS DOCUMENT OR REFERENCE TO THIS DOCUMENT, IN WHOLE OR IN PART, WITHOUT WRITTEN CONSENT OF WK DICKSON & CO., INC. IS PROHIBITED. THIS DOCUMENT, IN WHOLE OR IN PART, SHALL BE CONSIDERED TO BE VOID, TRUE COPIES.

MAG. DEC. 5737 (W) SEPT. 2004  
 DATE OF CHANGE = 08/11/04  
 TRUE NORTH

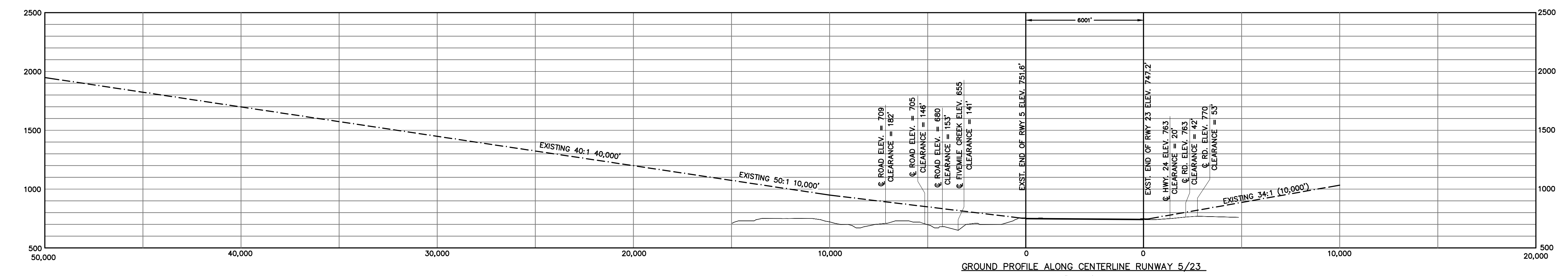
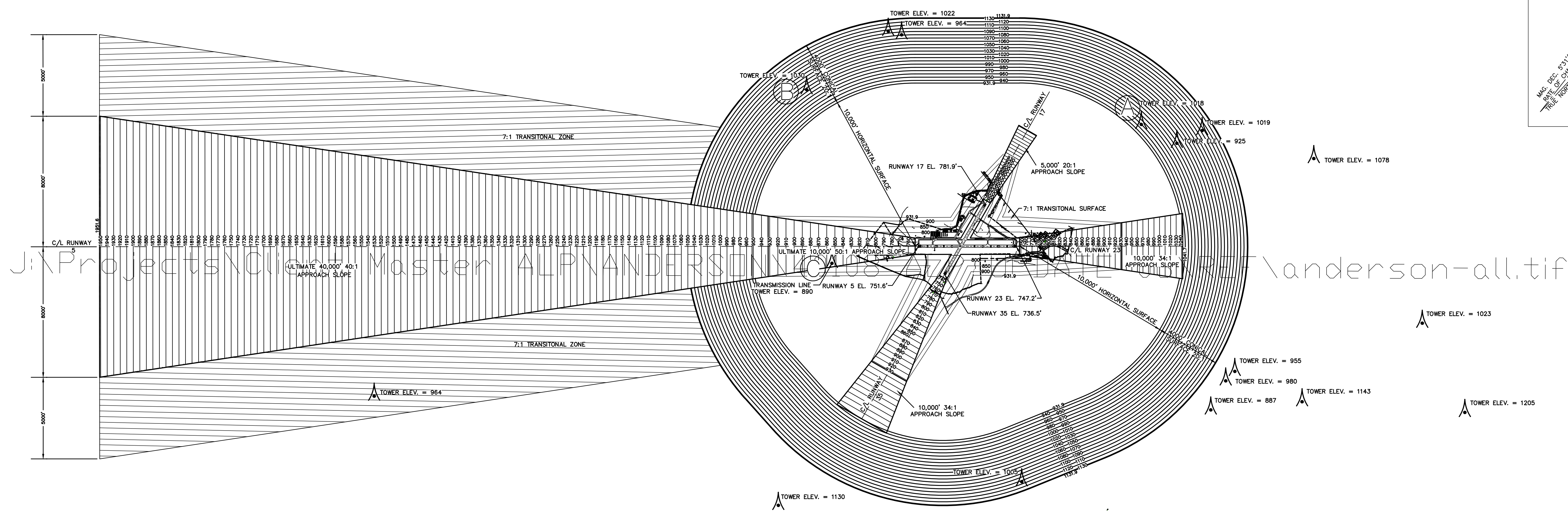

**NOTES:**

1. OBSTRUCTIONS PENETRATING THE HORIZONTAL, CONICAL, OR TRANSITIONAL SURFACES ARE NOTED.
2. HEIGHT-HAZARD/LAND USE ORDINANCE IN EFFECT.
3. ESTABLISHED AIRPORT ELEVATION IS 781.9'
4. HORIZONTAL DATUM IS NAD 83 & VERTICAL DATUM IS NAVD 88.
5. NO KNOWN OBSTRUCTIONS OTHER THAN THOSE NOTED

**ULTIMATE AIRPORT REFERENCE POINT COORDINATES**  
 LAT. 34° 29' 40.51" N  
 LONG. 82° 42' 33.78" W

**EXISTING OBSTRUCTIONS**

STATE NUMBER	LABEL	DESC.	OBSTRUCTION ELEVATION	APPROACH SLOPE PENETRATION	MARK IND	STOBE IND
41-2083	A	TOWER	1018	53.0'	NO	*D
41-2282	B	TOWER	1030	14.5'	NO	*D
41-0704	C	T-L TWR	890	38.0'		

**NOTES:**

1. \*D - DUAL, RED WITH MEDIUM INTENSITY WHITE STROBE.
2. THE TRANSMISSION TOWER LABELED (C) HAS A VERIFICATION STATUS (U - UNVERIFIED) THEREFORE NO MARK OR STROBE INDICATORS ARE KNOWN.

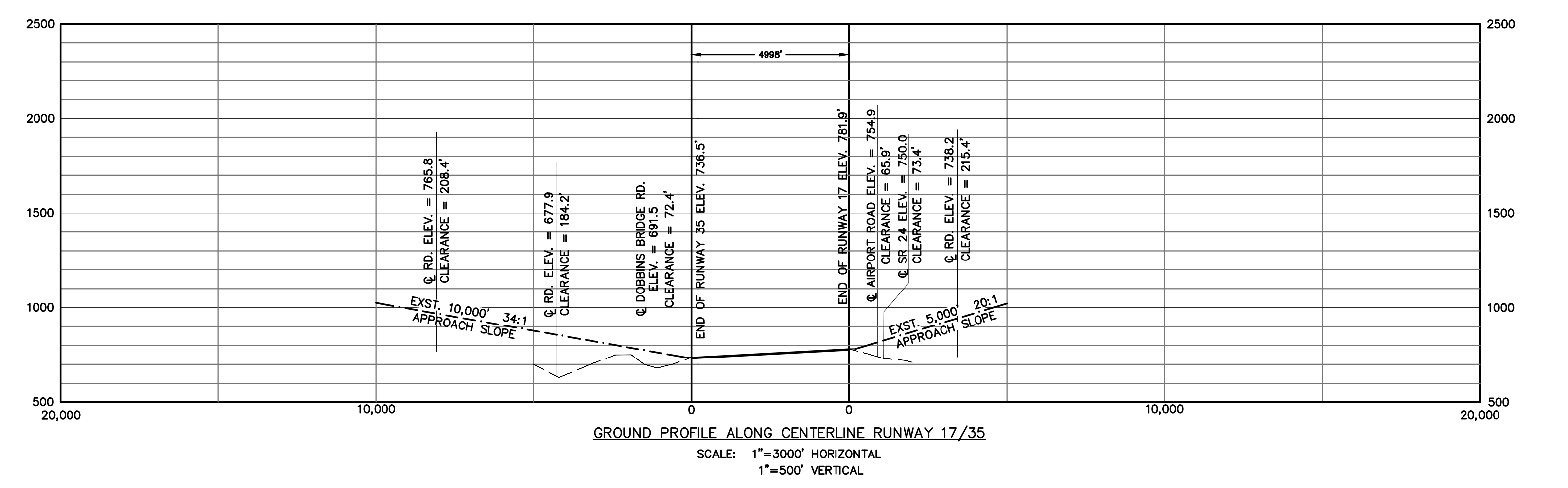
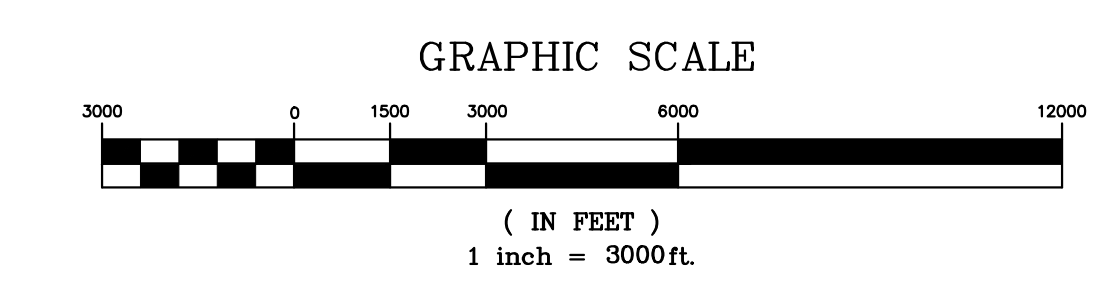

- LEGEND**
- = EXISTING RUNWAY
  - - - - = FUTURE RUNWAY EXTENSION
  - ⊕ = AIRPORT REFERENCE POINT
  - ▲ = KNOWN STRUCTURE

REV. NO.	DESCRIPTION	DATE
1.	UPDATE DRAWINGS TO REFLECT RUNWAY EXTENSION 5/23	12/04
2.	REVISED RUNWAY 17/35 RSA TO REFLECT B-II CRITERIA	12/04
3.	REVISED AS PER FAA AIP NO. 3-45-0004-12	5/06

PROJECT MANAGER: SEW  
 DRAWN BY: RBT  
 PROJECT DATE: NOV. 2004  
 APPROVED BY: SEW  
 FILE NAME: 40355.00.CA  
 PLOT DATE: 40355 ALP



501 COMMERCE DRIVE NE  
 COLUMBIA, SC 29223  
 (803) 786-4261  
 Office Locations:  
 North Carolina  
 South Carolina  
 Georgia  
 Florida

RELEASED FOR	DATE
APPROVALS	
BIDDING	
CONSTRUCTION	
RECORD DWG.	

**ANDERSON REGIONAL AIRPORT**  
**ANDERSON, SOUTH CAROLINA**

**AIRSPACE PLAN**