

COPYRIGHT © W.K. DICKSON & CO., INC. ALL RIGHTS RESERVED. REPRODUCTION OR USE OF THE CONTENTS OF THIS DOCUMENT IS PROHIBITED WITHOUT THE WRITTEN CONSENT OF W.K. DICKSON & CO., INC. THIS DOCUMENT, WHETHER IN ORIGINAL OR REPRODUCED FORM, SHALL BE CONSIDERED TO BE VOID, TRUE COPIES.

MAG. DEC. 5°31'(W) SEPT. 2004
 RATE OF CHANGE = 0"6' W/YR
 TRUE NORTH

EXST. RUNWAY 5 END
 LAT. = 34°29'18.93"
 LONG. = 82°42'57.29"
 ELEV. 751.6

EXST. RUNWAY 35 END
 LAT. = 34°29'17.66"
 LONG. = 82°42'29.17"
 ELEV. = 736.5

EXST. RUNWAY 17 END
 LAT. = 34°30'05.58"
 LONG. = 82°42'43.71"
 ELEV. = 781.9

BUILDING LEGEND			
IDENTIFICATION	BUILDING TYPE	OWNERSHIP	SIZE (SF)
(A)	10 UNIT T-HANGAR	ANDERSON COUNTY	15,240
(B)	10 UNIT T-HANGAR	ANDERSON COUNTY	15,240
(C)	5 UNIT T-HANGAR	ANDERSON COUNTY	5,580
(D)	5 UNIT T-HANGAR	ANDERSON COUNTY	5,580
(E)	STORAGE HANGAR	ANDERSON COUNTY	4,200
(F)	STORAGE HANGAR	ANDERSON COUNTY	4,200
(G)	OFFICE	ANDERSON COUNTY	1,628
(H)	MAINTENANCE HANGAR	ANDERSON COUNTY	5,429
(I)	FUEL FARM	ANDERSON COUNTY	2,250
(J)	TERMINAL BUILDING	ANDERSON COUNTY	9,690
(K)	CORPORATE HANGAR	S. E. LEASING & GLOBAL FINANCE	27,482
(L)	36" ROTATING BEACON	ANDERSON COUNTY	N/A
(M)	HANGAR	ANDERSON COUNTY	5,151
(N)	HELIPADS	ANDERSON COUNTY	2,500
(O)	HANGARS	ANDERSON COUNTY	2,790
(P)	FLIGHT SERVICE STATION	ANDERSON COUNTY	10,600
(Q)	SHERIFF'S HANGAR	ANDERSON COUNTY	11,023

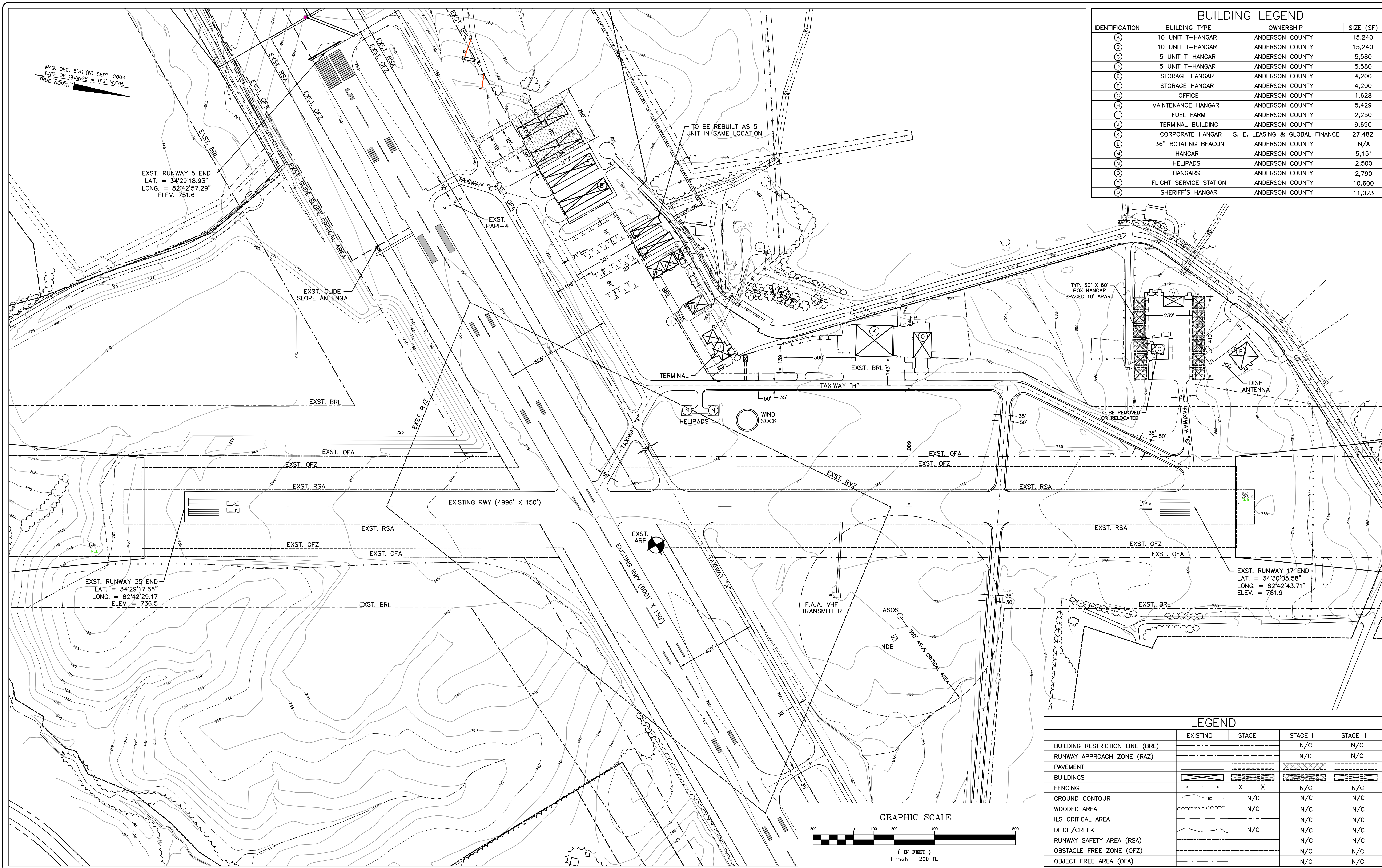

LEGEND				
	EXISTING	STAGE I	STAGE II	STAGE III
BUILDING RESTRICTION LINE (BRL)	---	---	N/C	N/C
RUNWAY APPROACH ZONE (RAZ)	---	---	N/C	N/C
PAVEMENT	---	---	---	---
BUILDINGS	---	---	---	---
FENCING	---	---	N/C	N/C
GROUND CONTOUR	---	N/C	N/C	N/C
WOODED AREA	---	N/C	N/C	N/C
ILS CRITICAL AREA	---	N/C	N/C	N/C
DITCH/CREEK	---	N/C	N/C	N/C
RUNWAY SAFETY AREA (RSA)	---	N/C	N/C	N/C
OBSTACLE FREE ZONE (OFZ)	---	N/C	N/C	N/C
OBJECT FREE AREA (OFA)	---	N/C	N/C	N/C

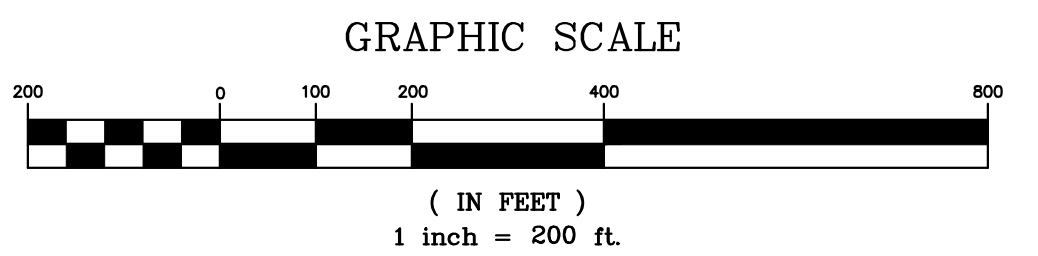

REV. NO.	DESCRIPTION	DATE
1.	UPDATE DRAWINGS TO REFLECT RUNWAY EXTENSION 5/23	12/04
2.	REVISED RUNWAY 17/35 RSA TO REFLECT B-II CRITERIA	12/04
3.	REVISED AS PER FAA AIP NO. 3-45-0004-12	5/06

PROJECT MANAGER: SEW
 DRAWING SCALE: 1" = 200'
 DRAWN BY: RBT
 PROJECT DATE: NOV. 2004
 APPROVED BY: SEW
 PROJECT NUMBER: 40355.00.CA
 FILE NAME: 40355 ALP
 PLOT DATE:



501 COMMERCE DRIVE NE
 COLUMBIA, SC 29223
 (803) 786-4261
 Office Locations:
 North Carolina
 South Carolina
 Georgia
 Florida
 RELEASED FOR: APPROVALS
 DATE: _____
 BIDDDING: _____
 CONSTRUCTION: _____
 RECORD DWG.: _____

ANDERSON REGIONAL AIRPORT
 ANDERSON, SOUTH CAROLINA

TERMINAL AREA PLAN