

TAX NO.	OWNER	DB.-PG.	PB.-PG.
76-0-0-16	CITY OF CHESTER AND COUNTY OF CHESTER SOUTH CAROLINA	539-46 306-255 306-254 680-229 306-287 306-307 306-284 306-284 320-278 306-263 306-253 306-252 306-251 788-284	539-45
76-0-0-14	F. GUY DARBY, SR. FAMILY LIMITED PARTNERSHIP NO. 3		E-226
76-0-0-13	DIANE D. COLLINS	523-272	D-125
76-0-0-12	F. GUY DARBY, JR. AND CRANFORD FAMILY LIMITED PARTNERSHIP	845-320	386-356
86-0-0-4	ADRON H. LOGAN	386-90	
77-0-0-142	REGINALD M. FOURNEY	824-110	C-5-97
77-0-0-141	VARNELL GRAY	747-33	C-5-96
77-0-0-140	ROBERT A. LAND	797-105	C-6-96
77-0-0-139	BLAKE ALDEN WOODS	776-309	C-6-96
77-0-0-138	THOMAS N. TRIPLETT TRUST	830-302	C-6-96
77-0-0-137	THOMAS N. TRIPLETT TRUST	830-302	C-6-96
77-0-0-136	THOMAS N. TRIPLETT TRUST	830-302	C-6-96
77-0-0-116	REGINA LOUISE STINSON	658-80	1-479
77-0-0-121	LARRY G. MCGUIRI	NRF	
77-0-0-124	LAMONT DAVID POWELL	822-313	D-7B-25
77-0-0-125	VIPUL SIAH	764-241	
77-0-0-126	DANIEL P. SMITH	710-52	1-479
77-0-0-127	RUTH F. TRIPLETT	639-88	B-4A-188, 427-348
77-0-0-117	THOMAS N. TRIPLETT TRUST	830-302	1-500
77-0-0-118	RUTH F. TRIPLETT	669-230	B-4A-188, 427-343
77-0-0-12	BEULAH PARKINS McCRAVEN	639-96	1-480, 408-429
77-0-0-11	ROBERT M. DENNIS	554-119	426-61
77-0-0-7	JOHN E. MCKEOWN	445-511	445-511
77-0-0-6	VERSIE L. ROBBINS	727-299	500-221
77-0-0-62	MICHAEL K. MACK	536-816	B-63A, 500-221
77-0-0-61	RICHARD ROBBINS	536-832	500-221
77-0-0-56	JACK E. NEAL	633-247	500-221
77-0-0-4	JAMES E. MELTON	655-281	C-164-10A
77-0-0-5	LEE KENNETH GUEMPEL	840-88	N-200
77-0-0-161	AUGUSTUS SMITH	813-157	C-9B-156
77-0-0-159	AUGUSTUS SMITH	761-256	C-9B-156
77-0-0-163	ANDREW E. JOHNSON	761-249	C-3A-166
77-0-0-158	MARK L. TOLLIVER	753-54	C-9B-156
77-0-0-3	CHARLES WEBB	799-36	C-5B-134, C-166-3A
77-0-0-73	TRACY R. WEBB	799-36	C-5B-134, C-156-9B
77-0-0-156	MARIE R. NUNNERY	741-139	C-143-2A
77-0-0-2	MAMIE H. GUY	450-7	
77-0-0-93	TIMOTHY K. BENZ	714-4	B-71-C
77-0-0-105	SUE P. GIBSON	607-141	B-161-5
77-0-0-86	JOHN P. DIETZ	531-642	B-46-C
77-0-0-107	COLEY GIBSON	607-137	B-161-5
77-0-0-1	COLEY GIBSON	532-864	N-238
77-0-0-100	ROBERT W. PHILLIPS, STEPHANIE M. PHILLIPS, JEFFREY K. BRISSETTE, AND BRENDA J. BRISSETTE	836-81	B-19C-6A N-238
66-0-0-8	MAMIE H. GUY	526-477	

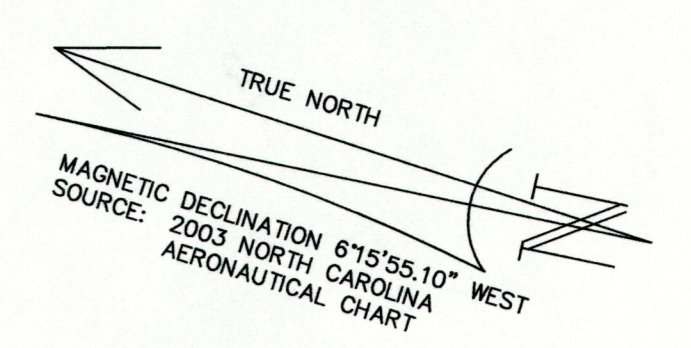

LEGEND	
ROADS (PAVED)	---
AIRPORT BUILDINGS / STRUCTURES	■
AIRPORT PAVED AREAS	▒
AIRPORT PROPERTY LINE	- - - -

APPROVALS		
CHESTER COUNTY AIRPORT COMMISSION		
DATE	SIGNATURE	TITLE
SOUTH CAROLINA DEPARTMENT OF COMMERCE DIVISION OF AERONAUTICS		
DATE	SIGNATURE	TITLE

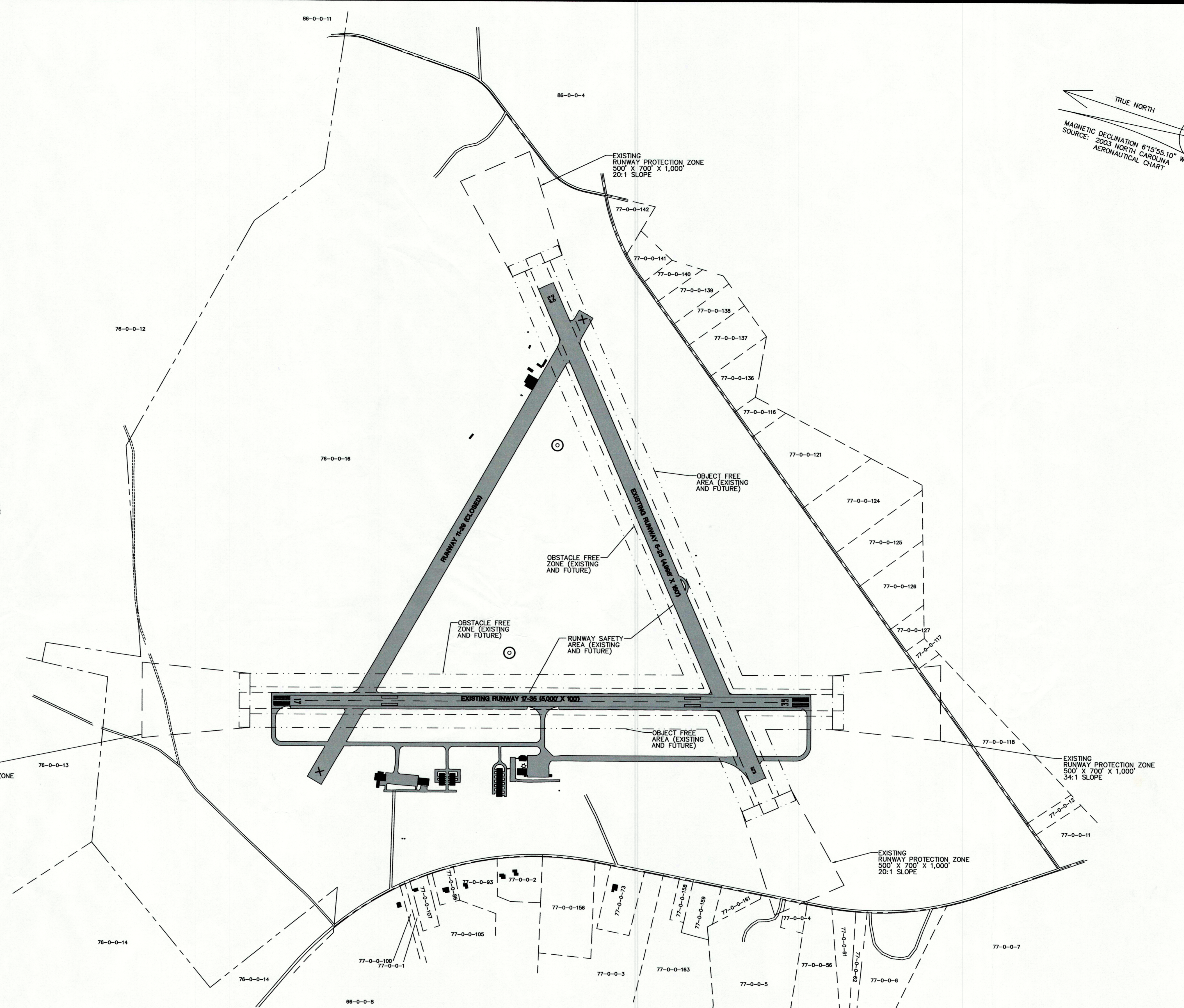
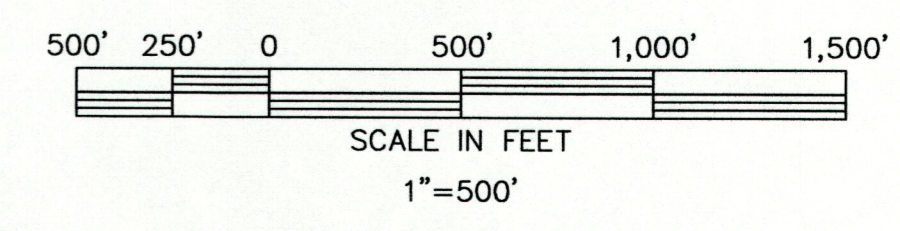

T ALBERT & BRIGHT
 ENGINEERING & PLANNING CONSULTANTS
 494 PARKWAY PLAZA BOULEVARD, SUITE 150
 CHARLOTTE, NORTH CAROLINA 28217
 PHONE: 704-426-6070 FAX: 704-426-6080
 www.talbertandbright.com

REV. NO.	DESCRIPTION	DATE

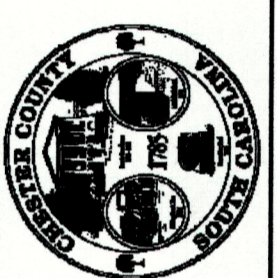
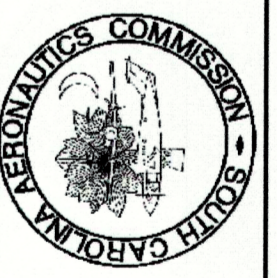

EXHIBIT 'A'
AIRPORT LAYOUT PLAN
UPDATE
CHESTER MUNICIPAL AIRPORT



Designed	JEL
Date	MARCH 2004
Scale	1"=500'
Drawn	JMM
Checked	JAS
Project No.	2228-0302
Sheet No.	10

OF 10