

Designer: APN	Checked by: RWO
Technician: APN	Project Number: 122633

- NOTES:**
- BASE MAPPING OBTAINED FROM APPROVED ALP, DATED 01/28/2005, AND EXISTING LEXINGTON COUNTY GIS/MAPPING ONLINE RESOURCES.
 - BUILDING RESTRICTION LINES (BRL) PARALLEL TO RUNWAY 18-36 ARE BASED ON A TRANSITIONAL SURFACE ELEVATION OF 20'.
 - ALL ELEVATIONS SHOWN ARE ABOVE MEAN SEA LEVEL (AMSL).
 - EXISTING HOLDLINES ARE LOCATED 125' FROM RUNWAY CENTERLINE AND ULTIMATE HOLDLINES ARE LOCATED 200' FROM RUNWAY CENTERLINE.

FAA DISCLAIMER

THE CONTENTS DO NOT NECESSARILY REFLECT THE OFFICIAL VIEWS OR POLICIES OF THE FAA. THE ACCEPTANCE OF THIS PLAN BY THE FAA DOES NOT IN ANY WAY CONSTITUTE A COMMITMENT ON THE PART OF THE UNITED STATES TO PARTICIPATE IN ANY DEVELOPMENT DEPICTED HEREIN NOR DOES IT INDICATE THAT THE PROPOSED DEVELOPMENT IS ENVIRONMENTALLY ACCEPTABLE IN ACCORDANCE WITH PUBLIC LAWS.

CONSTRUCTION NOTICE REQUIREMENT

TO PROTECT OPERATIONAL SAFETY AND ULTIMATE DEVELOPMENT, ALL PROPOSED CONSTRUCTION ON THE AIRPORT MUST BE COORDINATED BY THE AIRPORT OWNER WITH THE FAA AIRPORTS DISTRICT OFFICE PRIOR TO CONSTRUCTION. FAA'S REVIEW TAKES APPROXIMATELY 60 DAYS.

REVISIONS

No.	Description	Date	By

Project Name:
AIRPORT LAYOUT PLAN UPDATE

Drawing Name:
TERMINAL AREA DRAWING

FAA A.I.P. Project Number:
3-45-0067-013-2011

Date: **JUNE 2012** Division: **PLANNING**

Scale: (24x36) Drawing Number:

1"=50' **3**

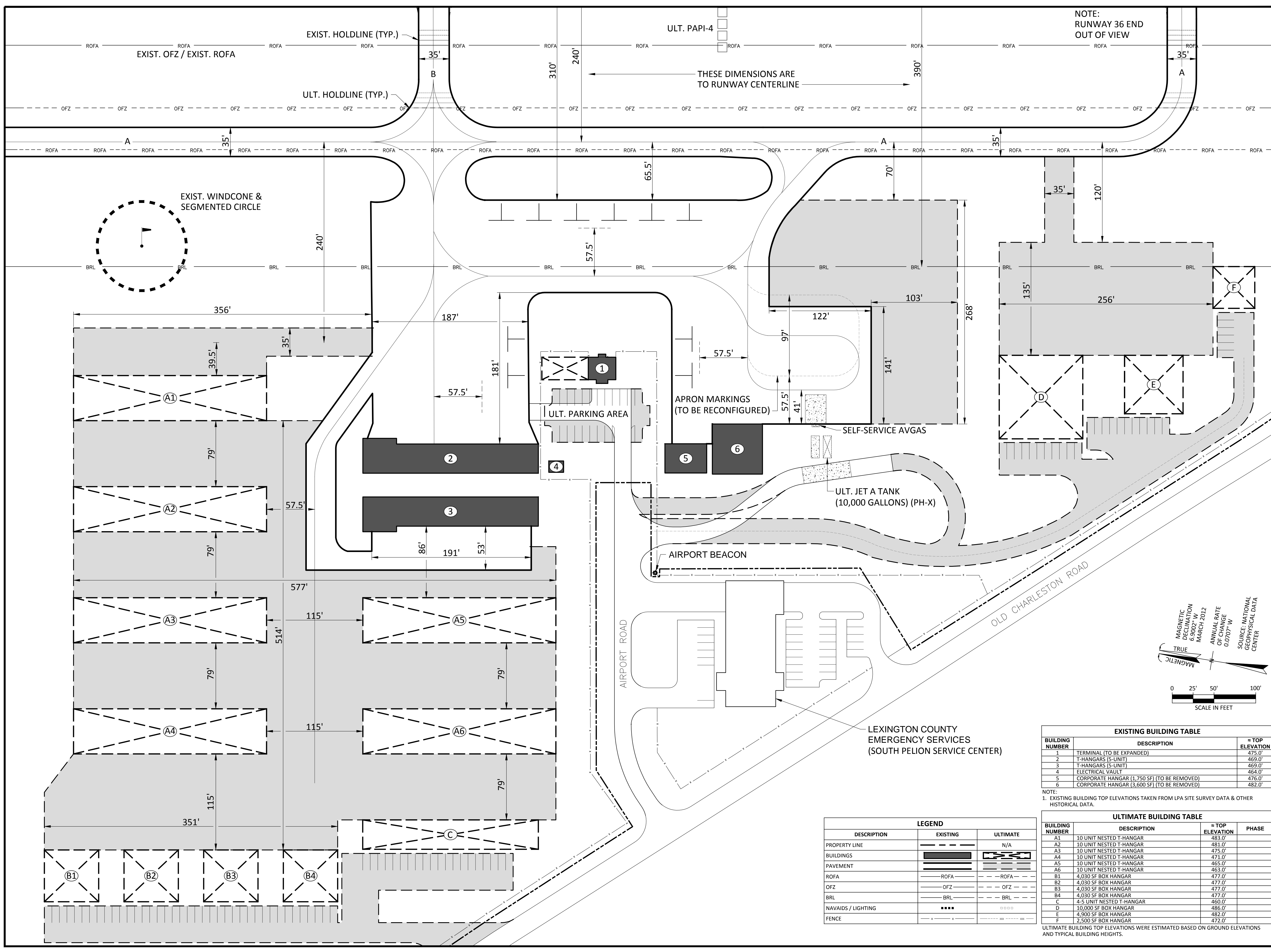

NOTE:
RUNWAY 36 END OUT OF VIEW

THESE DIMENSIONS ARE TO RUNWAY CENTERLINE

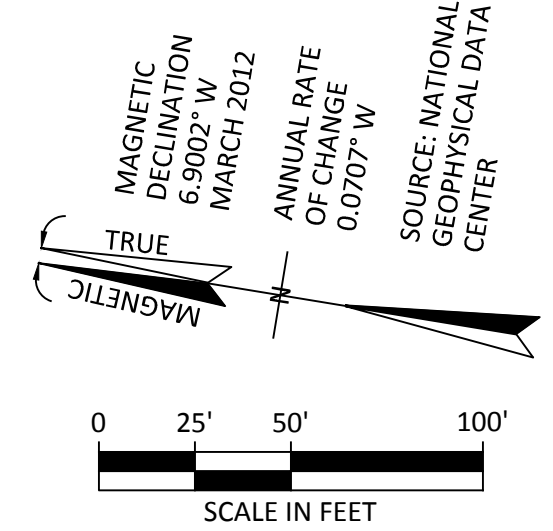
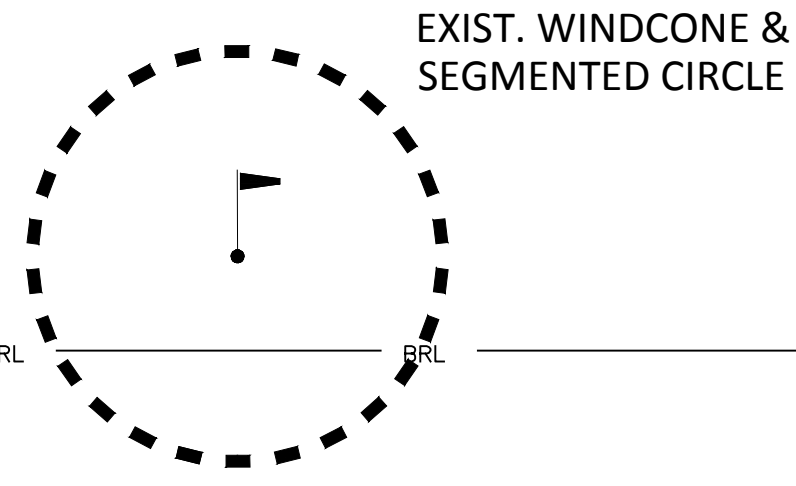

EXISTING BUILDING TABLE

BUILDING NUMBER	DESCRIPTION	≈ TOP ELEVATION
1	TERMINAL (TO BE EXPANDED)	475.0'
2	T-HANGARS (5-UNIT)	469.0'
3	T-HANGARS (5-UNIT)	469.0'
4	ELECTRICAL VAULT	464.0'
5	CORPORATE HANGAR (1,750 SF) (TO BE REMOVED)	476.0'
6	CORPORATE HANGAR (3,600 SF) (TO BE REMOVED)	482.0'

NOTE:
1. EXISTING BUILDING TOP ELEVATIONS TAKEN FROM LPA SITE SURVEY DATA & OTHER HISTORICAL DATA.

ULTIMATE BUILDING TABLE

BUILDING NUMBER	DESCRIPTION	≈ TOP ELEVATION	PHASE
A1	10 UNIT NESTED T-HANGAR	483.0'	
A2	10 UNIT NESTED T-HANGAR	481.0'	
A3	10 UNIT NESTED T-HANGAR	475.0'	
A4	10 UNIT NESTED T-HANGAR	471.0'	
A5	10 UNIT NESTED T-HANGAR	465.0'	
A6	10 UNIT NESTED T-HANGAR	463.0'	
B1	4,030 SF BOX HANGAR	477.0'	
B2	4,030 SF BOX HANGAR	477.0'	
B3	4,030 SF BOX HANGAR	477.0'	
B4	4,030 SF BOX HANGAR	477.0'	
C	4-5 UNIT NESTED T-HANGAR	460.0'	
D	10,000 SF BOX HANGAR	486.0'	
E	4,900 SF BOX HANGAR	482.0'	
F	2,500 SF BOX HANGAR	472.0'	

ULTIMATE BUILDING TOP ELEVATIONS WERE ESTIMATED BASED ON GROUND ELEVATIONS AND TYPICAL BUILDING HEIGHTS.

LEGEND

DESCRIPTION	EXISTING	ULTIMATE
PROPERTY LINE	---	N/A
BUILDINGS	█	█
PAVEMENT	▨	▨
ROFA	---ROFA---	---ROFA---
OFZ	---OFZ---	---OFZ---
BRL	---BRL---	---BRL---
NAVAIDS / LIGHTING	••••	□□□□
FENCE	---x---	---x---