

Copyright © W.K. Dickson Co., Inc. All rights reserved. Reproduction or use of the contents of this document without the written consent of W.K. Dickson Co., Inc. is prohibited. This drawing is the property of W.K. Dickson Co., Inc. and shall be returned to the office of origin.

MATCH LINE SHEET 6

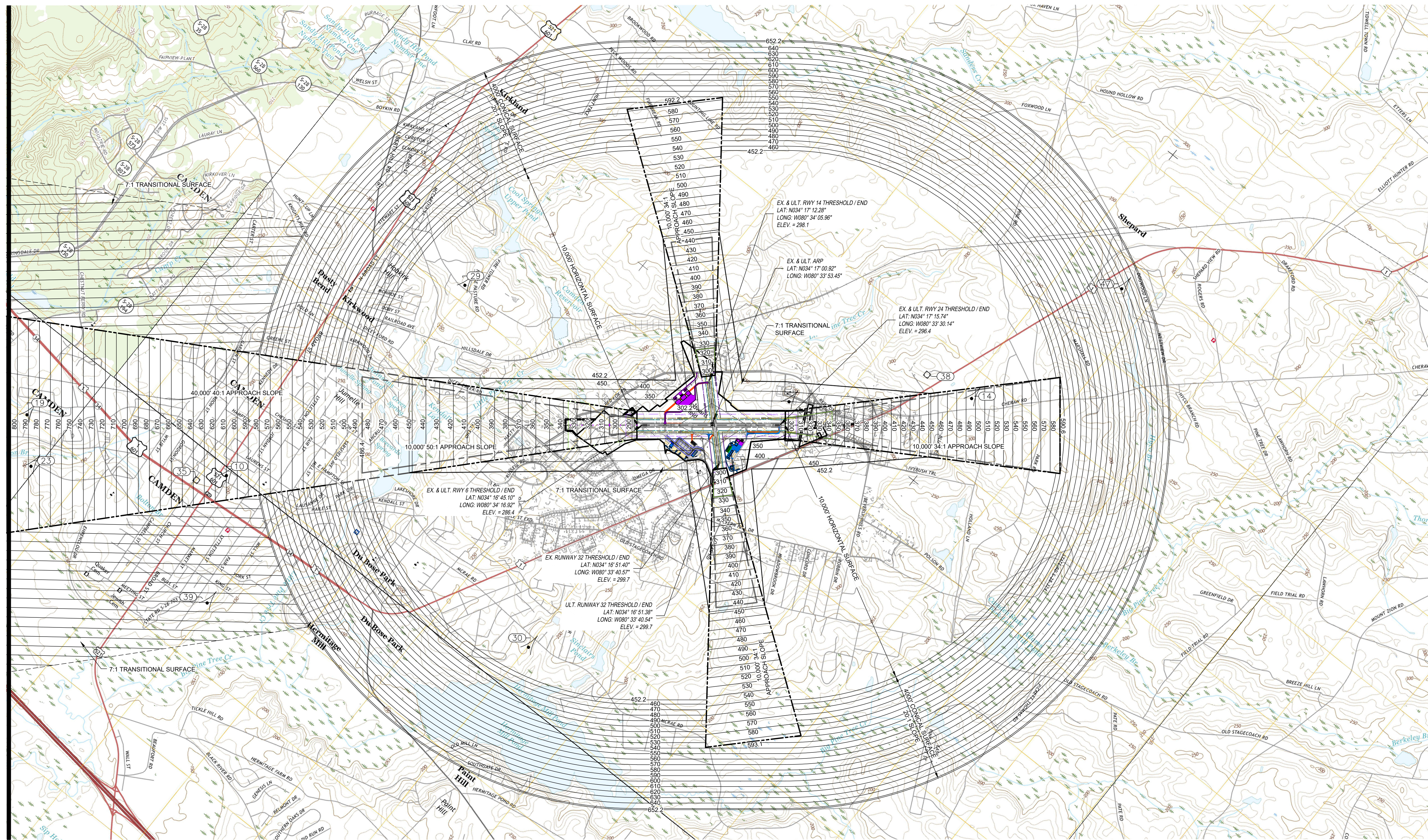

OBSTRUCTION POINT TABLE					
POINT #	DESCRIPTION	TOP ELEV.	GROUND ELEV.	AIRSPACE PENETRATION	STROB INDICATOR
10	TOWER	525	209	NONE	NONE
14	TOWER	434	324	NONE	NONE
19	TOWER	490	166	NONE	NONE
23	TOWER	490	165	NONE	NONE
29	TOWER	380	280	NONE	NONE
30	TOWER	458	198	NONE	NONE
32	TOWER	386	295	NONE	NONE
33	ELEC SYS	316	289	NONE	NONE
35	TANK	419	207	NONE	NONE
38	TANK	479	315	NONE	NONE
39	TOWER	378	183	NONE	NONE
47	TOWER	504	304	NONE	NONE

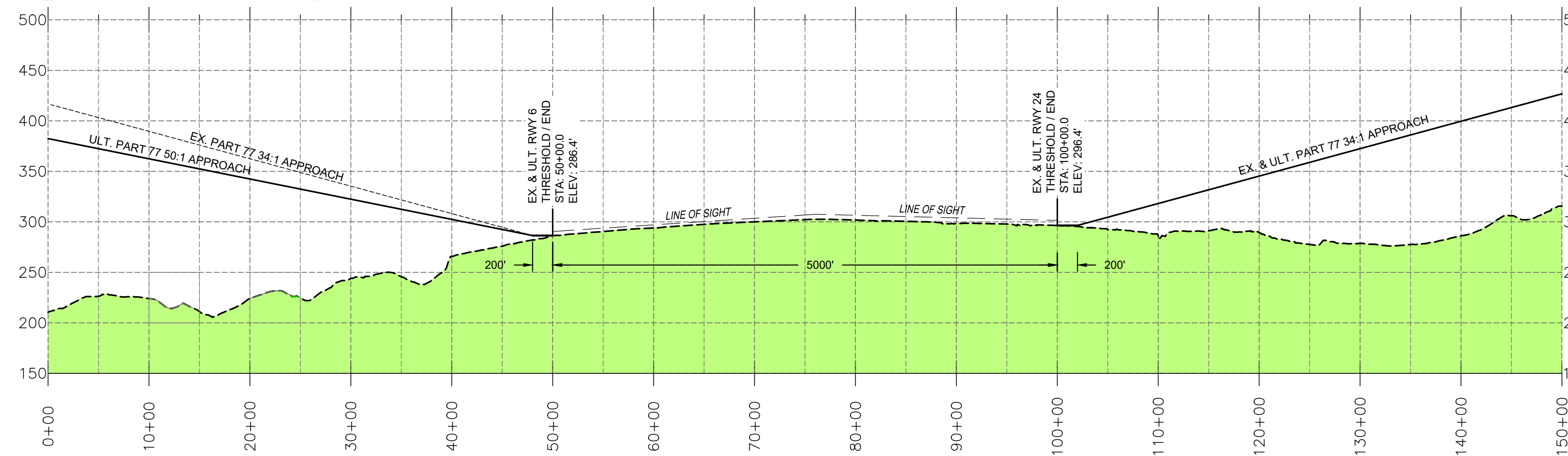

RUNWAY 6-24 AIRSPACE CENTERLINE

SCALE: HOR 1"=1000'; VERT 1"=100'

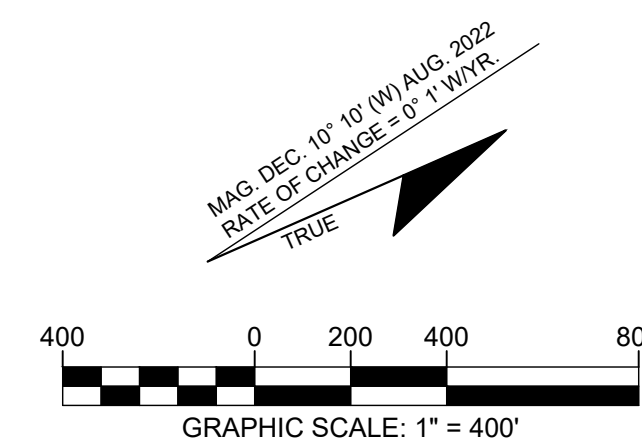

NOTES

- ALL LATITUDE AND LONGITUDE COORDINATES ARE IN NAD '83 FORMAT.
- ALL ELEVATIONS SHOWN ARE IN REFERENCE TO NAVD 88.
- PLANIMETRICS, CONTOURS, AND OBSTRUCTION INFORMATION WAS OBTAINED MAY 2023 BY NV5 GEOSPATIAL, INC.
- APPROACH AND DEPARTURE SURFACE FOR 14 CFR PART 77 AND TERPS DETERMINED BY APPROPRIATE CLASSIFICATION SECTION 3.6 IN AC 150/5300-13B (LATEST CHANGE).
- MAGNETIC VARIATION CITED ON THE NORTH ARROW WAS CALCULATED ON THE NOAA WEBSITE: <http://www.ngdc.noaa.gov/geomag>
- ALL OBJECTS TO BE KEPT A MINIMUM OF 10 FEET BELOW THE WIND SENSOR WITHIN THE 1000' RADIUS SURROUNDING IT.

WK DICKSON
community infrastructure consultants
1320 MAIN STREET
SUITE 400
COLUMBIA, SC 29201
(803) 786-4261
(803) 786-4263
WWW.WKDICKSON.COM

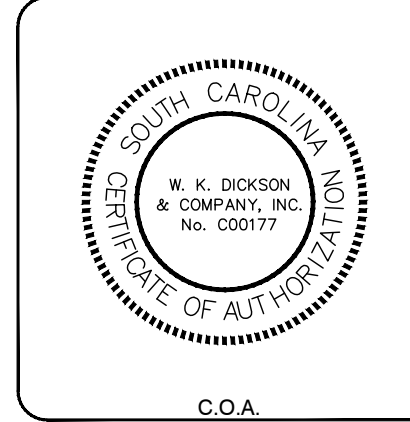

REVISION RECORD	DESCRIPTION	DATE	BY

PLANNING DOCUMENT - FINAL

PROJECT NAME:
**WOODWARD FIELD AIRPORT (CDN)
AIRPORT LAYOUT PLAN
CAMDEN, SOUTH CAROLINA**

DRAWING TITLE:
AIRSPACE PLAN 1

PROJ. MGR.: JJB
DESIGN BY: FDL
DRAWN BY: FDL
PROJ. DATE: 03-12-2024
DRAWING NUMBER:
5 OF 24
WKD PROJ. NO.:
20220720.00.CA

Copyright © W.K. Dickson & Company, Inc. All rights reserved. Reproduction or use of the contents of this document without the written consent of W.K. Dickson & Company, Inc. is prohibited. This document is the property of W.K. Dickson & Company, Inc. and shall be returned to the office of origin upon completion of the project.

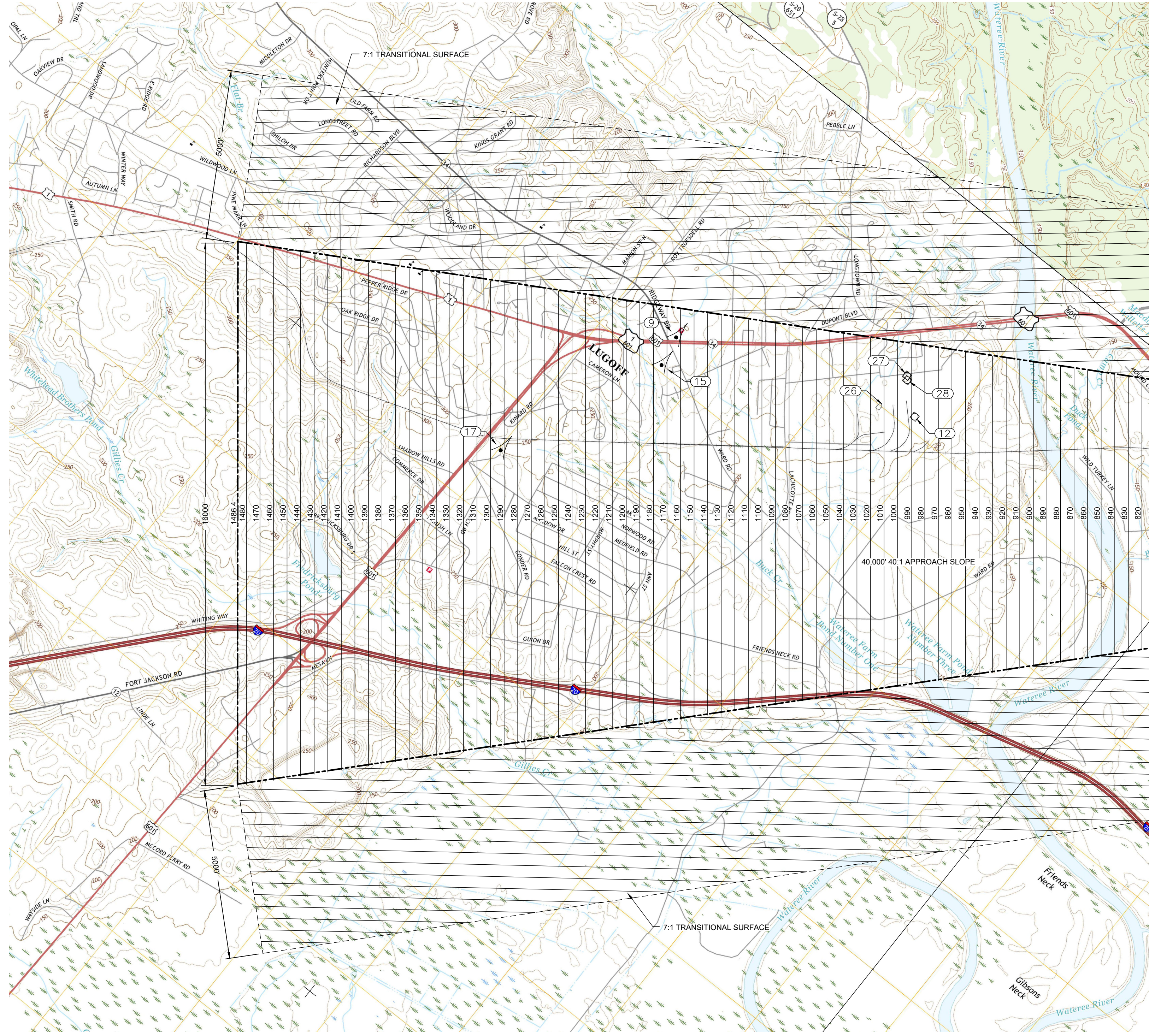

MATCH LINE SHEET 5

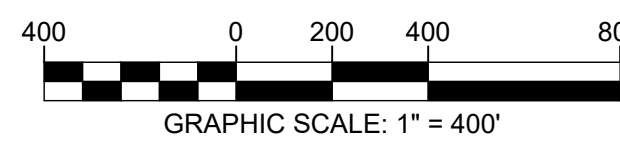
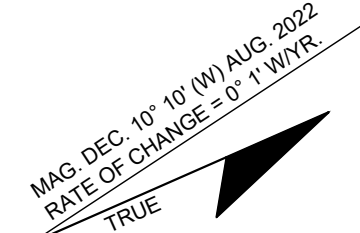
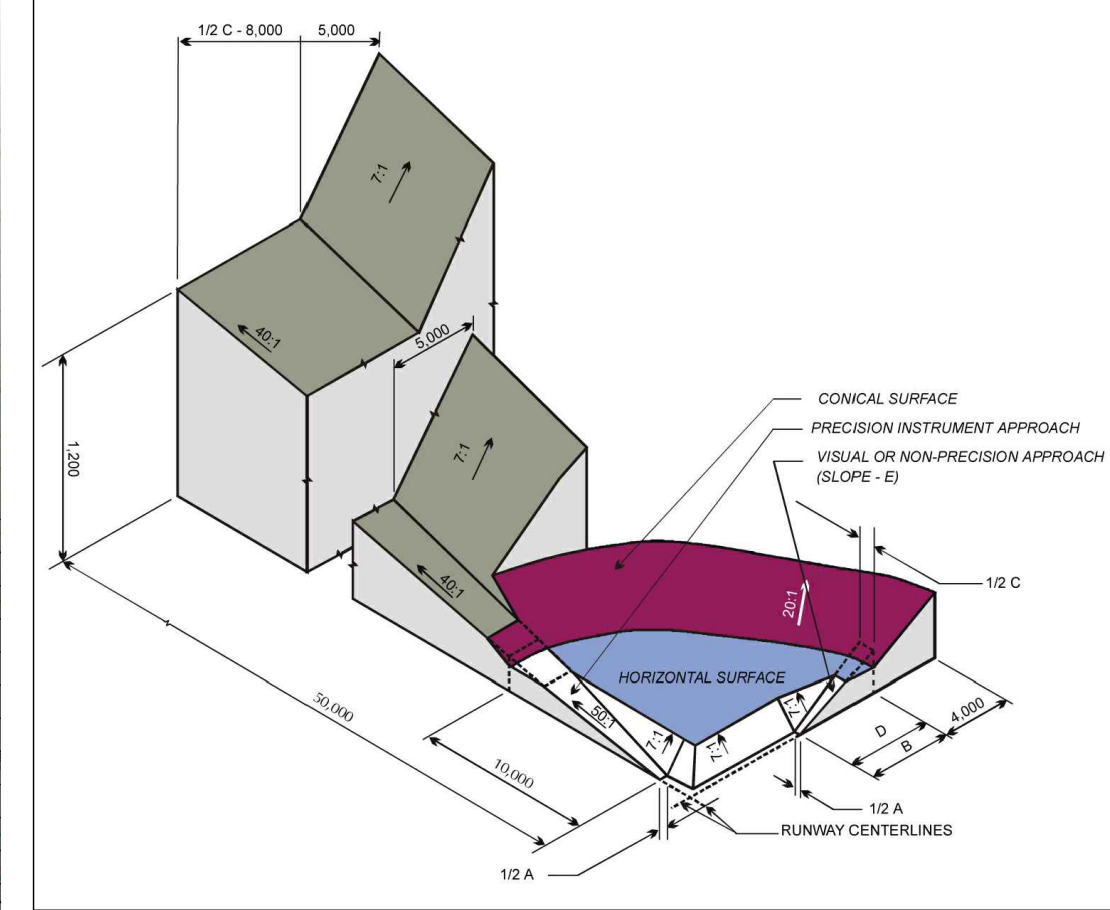

POINT #	DESCRIPTION	TOP ELEV.	GROUND ELEV.	AIRSPACE PENETRATION	STROB INDICATOR
9	TOWER	603	238	NONE	NONE
12	STACK	406	206	NONE	NONE
15	TOWER	582	228	NONE	NONE
17	TOWER	463	273	NONE	NONE
26	BLDG	345	210	NONE	NONE
27	TANK	390	212	NONE	NONE
28	TANK	399	213	NONE	NONE

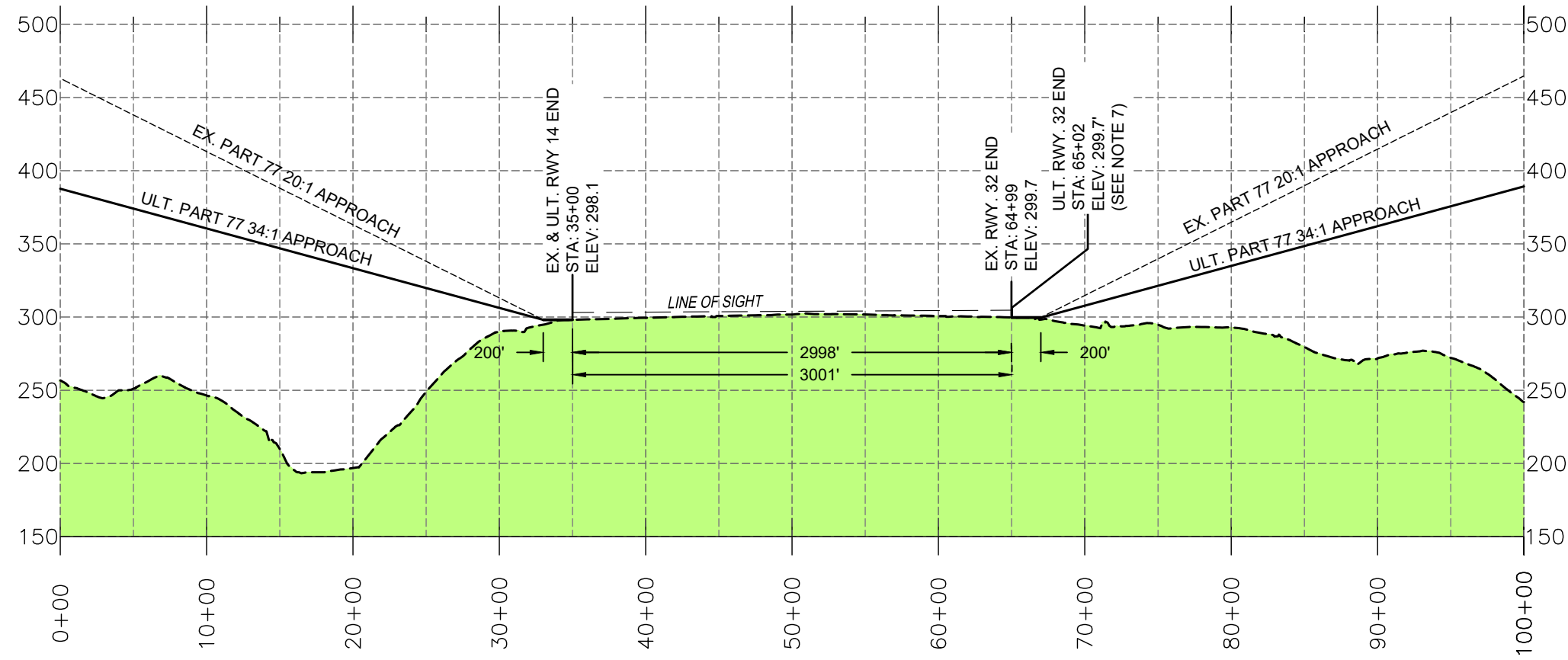

RUNWAY 14-32 AIRSPACE CENTERLINE

SCALE: HOR 1"=1000'; VERT 1"=100'

- NOTES
1. ALL LATITUDE AND LONGITUDE COORDINATES ARE IN NAD '83 FORMAT.
 2. ALL ELEVATIONS SHOWN ARE IN REFERENCE TO NAVD 88.
 3. PLANIMETRICS, CONTOURS, AND OBSTRUCTION INFORMATION WAS OBTAINED MAY 2023 BY NVS GEOSPATIAL, INC.
 4. APPROACH AND DEPARTURE SURFACE FOR 14 CFR PART 77 AND TERPS DETERMINED BY APPROPRIATE CLASSIFICATION UTILIZING SECTION 3.6 IN AC 150/5300-13B (LATEST CHANGE).
 5. MAGNETIC VARIATION CITED ON THE NORTH ARROW WAS CALCULATED ON THE NOAA WEBSITE: <http://www.ngdc.noaa.gov/geomag/web>
 6. ALL OBJECTS TO BE KEPT A MINIMUM OF 10 FEET BELOW THE WIND SENSOR WITHIN THE 1000' RADIUS SURROUNDING IT.
 7. THE ULTIMATE RUNWAY LENGTH SHOULD REACH A FULL 3,000' DURING THE NEXT PAVEMENT REHABILITATION, ANTICIPATED AS PART OF THE SOUTH CAROLINA AERONAUTICS COMMISSION SPONSORED SECONDARY RUNWAY REHABILITATION PROJECT.

WK DICKSON
community infrastructure consultants
1320 MAIN STREET
SUITE 400
COLUMBIA, SC 29201
(803) 786-4261
(803) 786-4263
WWW.WKDICKSON.COM

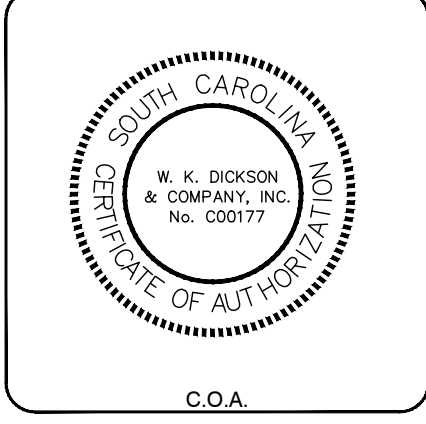

REVISION RECORD	DESCRIPTION	DATE	BY

PLANNING DOCUMENT - FINAL

PROJECT NAME:
**WOODWARD FIELD AIRPORT (CDN)
AIRPORT LAYOUT PLAN
CAMDEN, SOUTH CAROLINA**

DRAWING TITLE:
AIRSPACE PLAN 2

PROJ. MGR.: JJB
DESIGN BY: FDL
DRAWN BY: FDL
PROJ. DATE: 03-12-2024
DRAWING NUMBER:
6 OF 24
WKD PROJ. NO.:
20220720.00.CA